



Service Advisory

ZERO TURN

W-157

Models Affected: Z-16 (53AC225G190), Z-180 (53AC235M190), Z-180L (53AC265K190), Z-200 (53AC275K190).

Serial Number Range Affected: 1998 Production Units.

Date: **March 6, 2007**

Subject: **731-3165 Park Brake Lever Service Kit (759-04158).**

IMPORTANT ATTENTION PARTS MANAGER ATTENTION SERVICE MANAGER

PURPOSE: To replace the single one piece 731-3165 Brake Lever which is No Longer Available with the current two piece style Brake Lever & Knob in the 759-04158 Service Kit.

NOTE: The 759-04158 Service Kit Instructions are attached with this Advisory for informational purposes. Page 2 of the Service Kit instructions covers the removal & installation procedures for the Zero Turn Units.

THIS AREA LEFT INTENTIONALLY BLANK

This advisory is being released for informational purposes only.

SERVICE MANAGER	PARTS MANAGER	SALES MANAGER	SERVICE TECH.	SERVICE TECH.

Circulate and Initial



Service Kit

759-04158

Date: March 5, 2008
Subject: 731-3165 Park Brake Lever Service Kit.
Models Affected: Z-Series Mowers
See "MODEL NOTE" Below

MODEL NOTE:

Cub Cadet Models: Z42, Z48, Z48L, Z54, Z54L units Built 1998 through 1999

White Outdoor Models: Z-16, Z-180, Z180L, Z-200 Units Built 1998 through 1999.

PURPOSE: To replace the single one-piece 731-3165 Brake Lever with the current two-piece Brake Lever & Knob.

NOTE: *These materials are prepared for use by trained technicians who are experienced in the service and repair of equipment of the kind described in this publication, and are not intended for use by untrained or inexperienced individuals. Such individuals should seek the assistance of an authorized service technician or dealer.*

NOTE: *Save this Instruction Sheet. Refer to it when ordering replacement parts.*

Removal Instructions:

1. Place Unit on a flat level surface & chock the wheels.
2. Lift the rear Engine Compartment Body.
3. Disconnect the Negative Battery Cable.
4. Remove the Bolts securing the two (2) Control Handles to the Bellcrank assemblies.
5. Remove the Control Bellow.
6. Remove the four (4) Bolts securing the Bellow Retainer Bracket to the top of the Support Tower
7. Remove the Console by pulling it straight up off of the Tower Support assembly.
8. Remove the Cotter Pin & remove the Clevis Pin from the Park Brake Bracket & Park Brake Engagement Lever.
9. Remove the internal Cotter Pin from the Park Brake Rod.
10. Remove the single one piece Brake Lever & discard.
5. Install the Brake Lock Knob to the Brake Lock Lever using the Phillip Head Pan Screw from the kit. The newly replaced Brake Lock Lever & Brake Lock Knob will not be centered in the Console Panel opening, but will be offset to the right.
6. Install the Bellow Retainer Bracket using the four (4) Bolts removed in step 6 of the "Removal Instructions".
7. Place the Control Bellow over the righthand & lefthand Bellcrank assemblies.
8. Place the Control Handles through the Control Bellow & secure to the Bellcrank assemblies with the hardware removed in step 4 of the "Removal Instructions".
9. Reconnect the Negative Battery Cable to the Negative Battery Terminal.
10. Lower the rear Engine Compartment Body and make sure the body is securely latched.
11. Remove chocks from the Wheels and start unit. Insure that all factory installed safety features are in proper working order.

Installation Instructions:

(Refer To Page 3 & 4 For Figures).

1. Pre-thread the 710-3009 Phillip Head Screw into the hole of the Brake Lock Lever to cut threads for easier installation after the Brake Lock Lever is installed.
2. Install the 703-2963 Brake Lock Lever from where the single one piece Brake Lever was removed using the existing hardware. Install with the off-set facing inward. Refer to Figure 4A on page 4.
3. Install the Park Brake Rod to the newly installed Brake Lock Lever with existing hardware.
4. Install the Console by sliding it down over the Tower Support assembly, do not secure at this time.
12. Depress Brake Pedal and engage the Brake Lock Lever. Insure that the Brake Pedal locks.
13. Depress the Brake Pedal to insure the Brake Lock Lever releases. Repeat steps 12 & 13 a couple of times.

NOTE: Be careful of the Wire Harness, when installing the Console.

759-04158 Service Kit Contents

ITEM NO.	PART NUMBER	QTY	DESCRIPTION
1	731-3207	1	Brake Lock Knob
2	703-2963	1	Brake Lock Lever
3	710-3009	1	Phillip Head Pan Screw

Instruction sheet included with kit

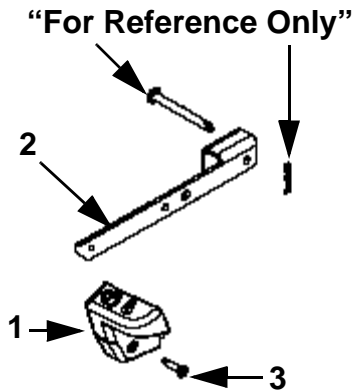

FIGURE 1

Hole Usage For The 703-2963 Brake Lock Lever

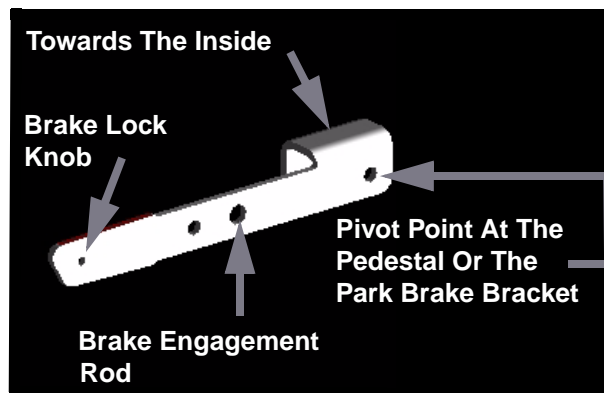

FIGURE 2

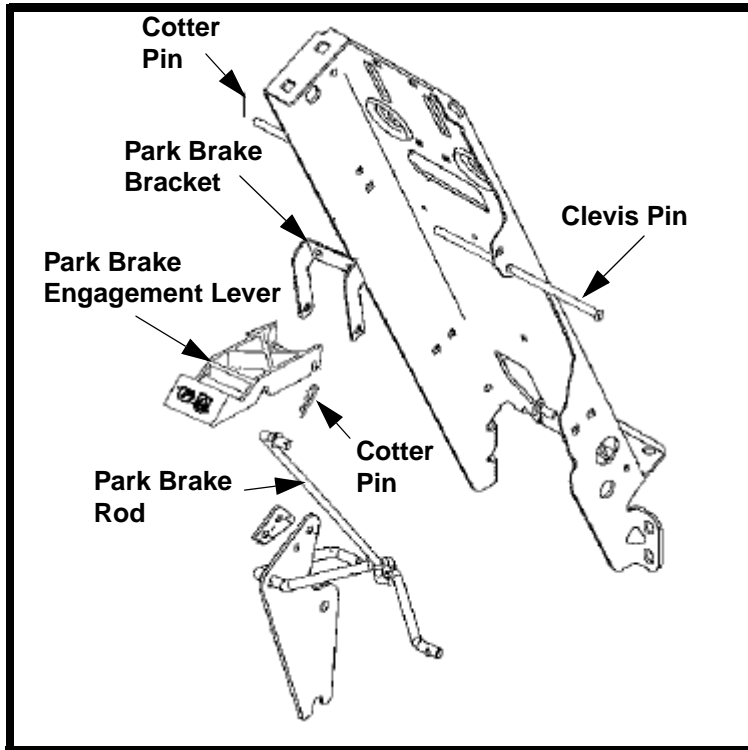

FIGURE 4

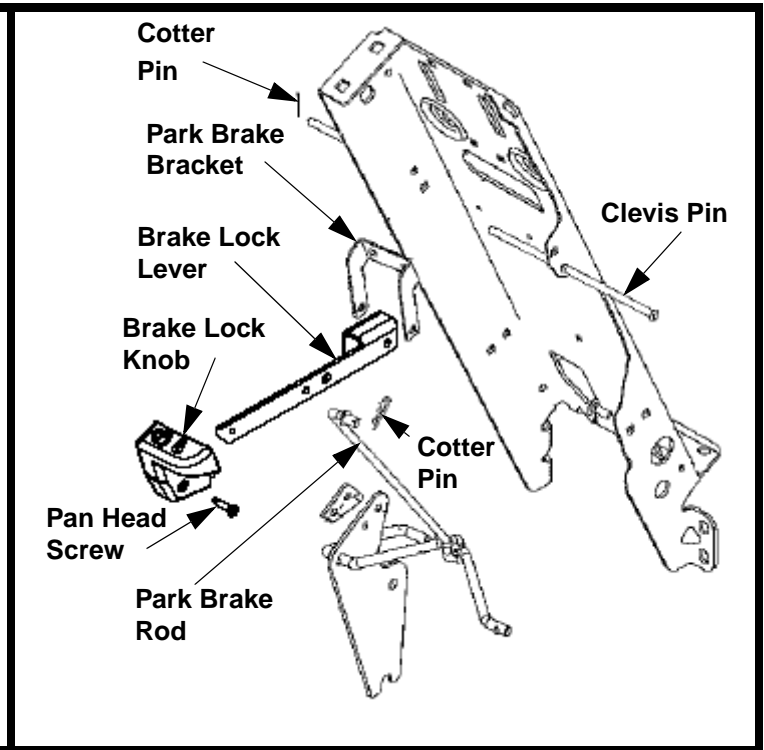

FIGURE 4A