



# Service Kit 753-05152

Date: 9/2/2005  
 Subject: Product Enhancement - Frame Plate  
 Models Affected: 2005 Model Year 700 Series Transmatic and Hydrostatic Drive Units built between December 9, 2004 (Date Code "...L094B...") and July 18, 2005 (Date Code "...G185B...").

**Read through and understand these instructions completely before proceeding with repair.**

**PURPOSE:** The bracket and hardware supplied in this kit may be installed to "Models Affected", as listed above, whenever such units are in the shop for required service. Late 2005 production incorporates a similar plate.

**NOTE:** These materials are prepared for use by trained technicians who are experienced in the service and repair of equipment of the kind described in this publication, and are not intended for use by untrained or inexperienced individuals. Such individuals should seek the assistance of an authorized service technician or dealer.

**NOTE:** Save this Instruction Sheet. Refer to it when ordering replacement parts.

## Service Kit Contents

(See Figure 1)

ITEM NO.	PART NUMBER	QTY	DESCRIPTION
1	783-04959	1	BRACKET: FRAME:RH
2	736-0264	2	WASHER: FLAT: .330 x .630 x .063
3	712-04063	1	NUT: FLANGELOCK: 5/16"-18: GRF
4	710-3008	1	SCREW: HEX:5/16"-18 x .75: GR5
5	710-0650	1	SCREW: TAPTITE: 5/16"-18 x .875
6	710-0604A	1	SCREW: TAPTITE: 5/16"-18 x .625
7	769-02065	1	THIS INSTRUCTION SHEET

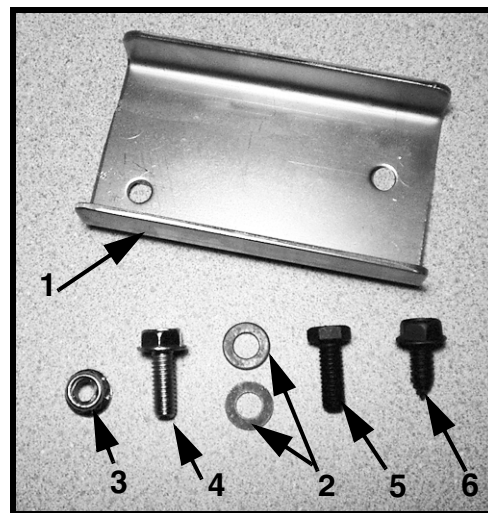

FIGURE 1

### Pre-Service Preparation:

**NOTE:** Right and left are determined from the operator's position seated facing forward.

1. Turn off engine, remove ignition key and set parking brake to the ON position.
2. Securely block front wheels so tractor cannot roll forward or backward.
3. Raise rear end of tractor so that the right rear wheel is off the ground. Block and secure tractor in the raised position. Remove and retain right rear wheel and hardware.

### Installation Instructions: (Refer to Figure 2)

#### For Single Speed Transmatic Drive Tractors:

5. Install RH Frame Bracket, Item 1, to RH frame channel as shown using both Flat Washers, Item 2, Taptite Screw, Item 6, and Taptite Screw, Item 5.

#### For Hydrostatic Drive Tractors:

5. Install RH Frame Bracket, Item 1, to RH frame channel as shown using both Flat Washers, Item 2, Taptite Screw, Item 6, Hex Screw, Item 4, and Flange Lock Nut, Item 3.

6. Re-install rear wheel. Clean the threads of the wheel retainer screw and apply Loctite Blue (#242) or equivalent. Install screw with bell washer and tighten.

7. This completes the service kit installation.

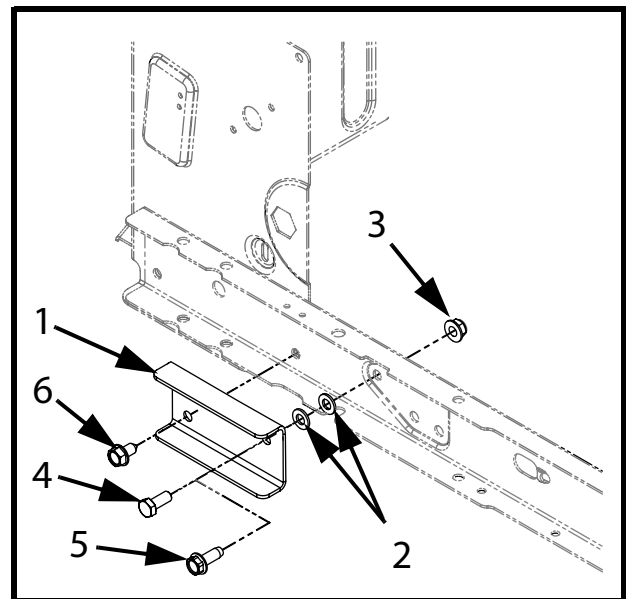

FIGURE 2