



Service Kit

753-05145

Date: 8/31/2005

Subject: Hydro Drive Belt Tensioning Idler

Models Affected: 2005 Model Year Hydro Drive 611-619 and 811-819 Series Lawn and Garden Tractors

Read through and understand these instructions completely before proceeding with repair.

PURPOSE:

1. Under certain operating conditions, i.e. heavy loading on transmission drive, the hydrostatic transmission drive belt tensioning spring may unhook from its' bolt attachment point. This results in a loss of drive to the hydrostatic transmission. **Serial Number Range Affected: Units built between December 9, 2004 (Date Code "...L094H...") and June 21, 2005 (Date Code "...F215H...")**

2. If the tractor was built with a 736-0320 (1.38 O.D.) flat washer in the idler pivot hardware stack-up an idler rattle may be noticed during operation. **Serial Number Range Affected: Units built between December 9, 2004 (Date Code "...L094H...") and May 19, 2005 (Date Code "...E195H...")**

NOTE: These materials are prepared for use by trained technicians who are experienced in the service and repair of equipment of the kind described in this publication, and are not intended for use by untrained or inexperienced individuals. Such individuals should seek the assistance of an authorized service technician or dealer.

NOTE: Save this Instruction Sheet. Refer to it when ordering replacement parts.

Service Kit Contents (See Figure 1)

ITEM NO.	PART NUMBER	QTY	DESCRIPTION
1	732-04323A	1	SPRING: EXTENSION
2	736-0258	1	WASHER: FLAT: .385 X 1.0 X .135
3	777S32651	1	LABEL: SAFETY:GENERIC
4	769-01970	1	THIS INSTRUCTION SHEET

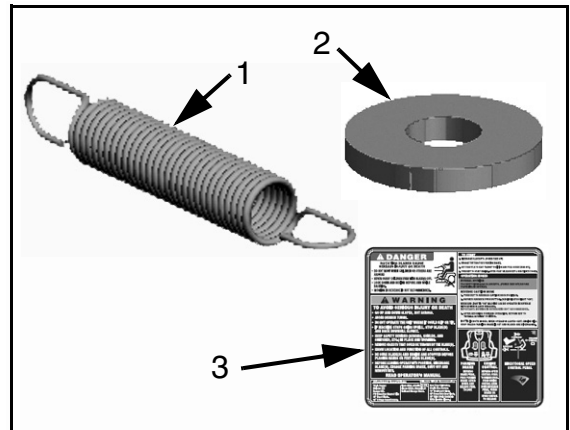

FIGURE 1

Pre-service Preparation:

1. Shut off the engine and remove the key from the ignition switch. Allow engine and muffler to cool.
2. Remove mower deck from tractor. Refer to the Operator's Manual for deck removal instructions.
3. Inspect the belt tensioning idler and pulleys for excessive debris build-up or damage that may impact free motion. Clean and/or repair as required.
4. If the units' date code falls between both date code ranges listed under **PURPOSE** section Items 1 and 2, proceed to Step 5. If the units' date code falls between **May 20, 2005 (Date Code "...E195H...")** and **June 21, 2005 (Date Code "...F215H...")**, proceed directly to Step 27.
5. Disconnect and secure the BLACK battery cable from the NEGATIVE battery terminal first.

6. Disconnect and secure the RED battery cable from the POSITIVE battery terminal.
7. Remove the battery and battery box from the fender well.

Idler Rattle Repair:

8. Release the seat lift extension spring, 732-1184, from the seat support bracket.

CAUTION! - The 732-1184 spring is a high load spring. Use spring puller tool 732-0571, or another suitable tool, to safely remove the spring hook from the seat bracket.

9. Remove the seat support brackets with seat as a sub-assembly from the fender.
10. Remove the shift lever and deck lift lever knobs.

11. On garden tractor units remove the plastic shift lever cover.
12. Remove the two screws securing the hydro control and the brake pedals and remove both pedals.
13. On the Instructional Label located on the deck portion of the fender at the base of the dash panel, locate the two screw heads that are under the label. Cut the label to provide access to the two screws. Option: Carefully remove the label using a low temperature heat gun. New labels are supplied in the kit.
14. Remove the two screws that are under the label.
15. Remove the hex nuts that attach the running board portion of the fender to the frames' outriggers.

Units with rubber foot pads: Carefully lift up the rubber foot pad at the outside corner and hold down the carriage bolt while removing the nut. There is no need to remove the rubber foot pads.

Units with abrasive foot pads: Locate the position of the carriage bolt under the foot pad with your finger. Press down with your thumb while removing the nut. There is no need to remove the abrasive foot pads.

16. Remove the fender.

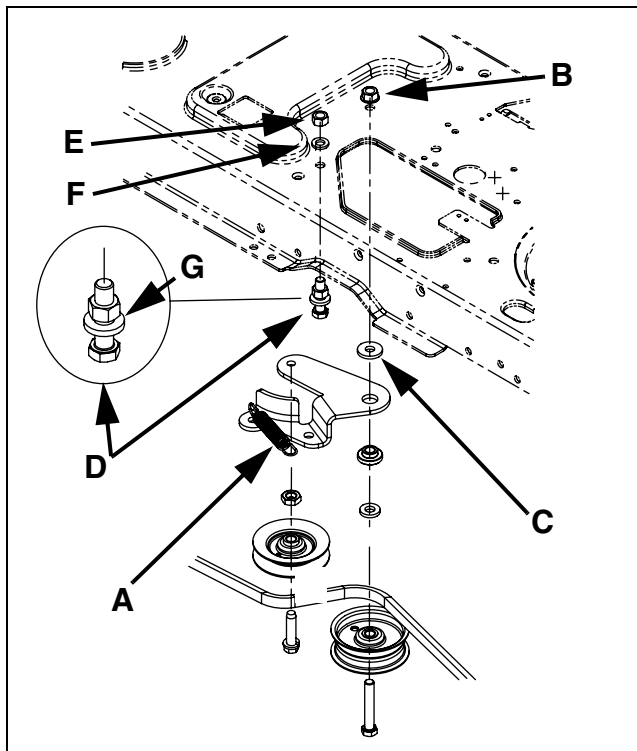

FIGURE 2

17. Slip the drive belt off of the fixed idler (not shown) on the left underside side of the frame. Unhook the extension spring, "A", from its' attach point at the bolt sub-assembly, "D".
18. Remove the hex nut "B" and lower idler bracket assembly.

19. Discard flat washer "C" and install new Flat Washer 736-0258, Item 2, in its place. Re-install idler bracket assembly to frame.

20. See Figure 2. Inspect spring attach bolt sub-assembly, "D", for a floating washer, "G", between the head of the bolt and the under the frame nut. If the washer is present, remove hex nut "E" and lock washer "F". Disassemble the bolt/nut/washer sub-assembly, "D" and remove the floating flat washer. Re-install the bolt sub-assembly as was originally installed less the floating flat washer.

21. Inspect drive belt for fraying, cracking or burn areas. Replace if required.

22. Re-install the fender, brake and hydro control pedals, seat bracket and seat sub-assembly and battery tray.

23. Remove old label and replace with the new Safety Label, Item 3.

24. Re-install battery. Connect the RED cable to the POSITIVE battery terminal first.

25. Connect the BLACK cable to the NEGATIVE battery terminal.

Idler Spring Upgrade:

26. Replace the existing extension spring 732-0429A with Extension Spring 732-04323A, Item 1. See Figure 2 Item "A". The spring **MUST** be hooked at the lowest point on bolt "D" (i.e. next to the head of the bolt). The orientation of the spring hooks relieves the twist in the spring when installed. The new spring also provides additional coil separation.

NOTE: If repairs were started at Step 26 there may be a floating flat washer on the spring attach point bolt "D". See Figure 2. The floating washer is not required with the new spring but can be left as is. However, the floating washer **MUST** be positioned between the spring hook and the frame.

27. With the deck off, test drive unit. With the engine running at full throttle, place the front wheels against a step and depress and release the hydro control pedal several times.

Ensure that the height of the step does not allow any other part of the tractor to come in contact with the step and damage the unit. Option: If there is no step suitable for this test, testing on a hill or incline should be performed.

This will test the drive belt system under an increased load. Ensure that the new extension spring remains attached.

28. This completes the service kit upgrade.