



Service Kit

753-04474

Date: June 11, 2004

Subject: 42 inch Service Deck Assembly - Complete

Models: 650 through 690 Series Box Frame Style Models manufactured after October 02, 2002 - serial number sequence (...J022...) and later

PURPOSE: Use this service kit when it is necessary to replace the complete 42 inch cutting deck assembly on the **Affected Models** listed above.

NOTE: *Save this Instruction Sheet. Refer to it when ordering replacement parts.*

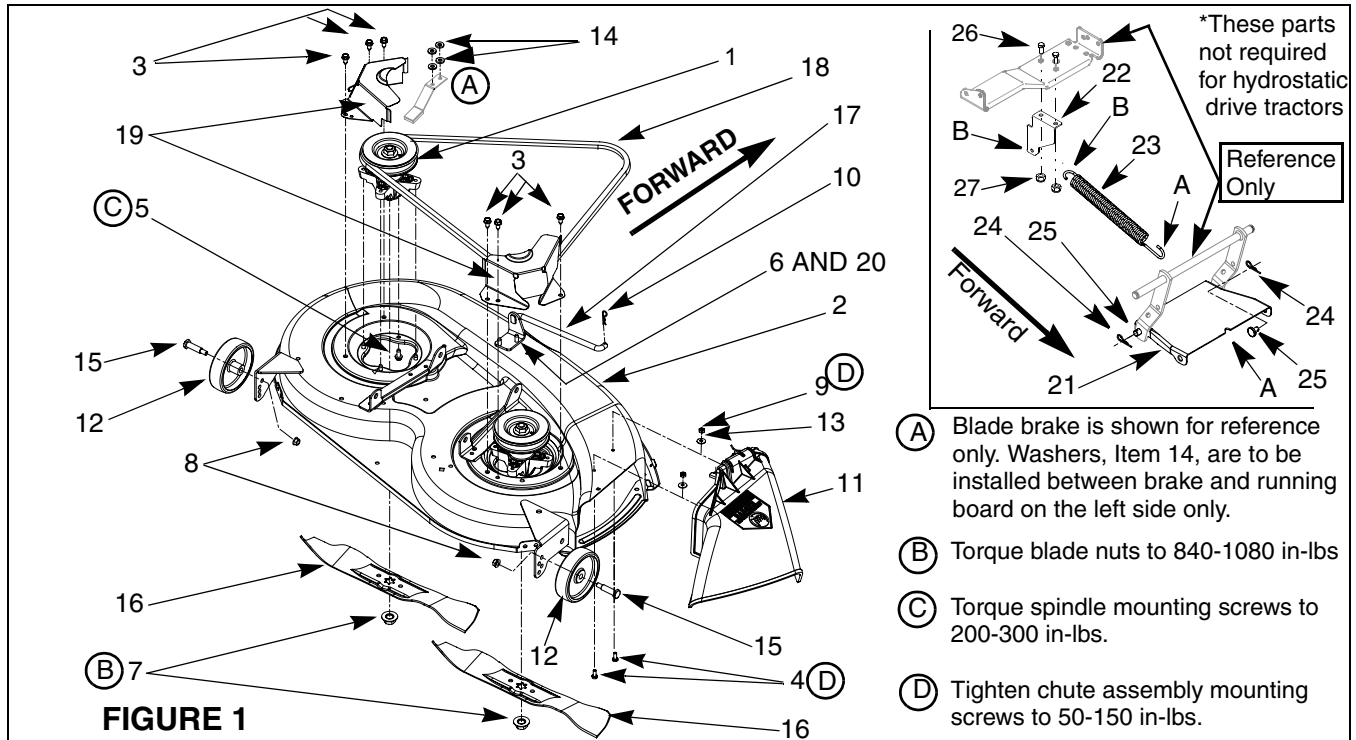

Service Kit Contents (See Figure 1)

ITEM NO.	PART NUMBER	QTY	DESCRIPTION	ITEM NO.	PART NUMBER	QTY	DESCRIPTION
1	618-0142A	2	SPINDLE:ASM:PULLEY: 5.75" DIA.	15	738-0373	2	SHLD: SCREW: .498 DIA. x 1.53 LG
2	683-04035A-0637 683-04035A-0650 683-04035A-0665 683-04035A-0691	1	DECK:ASM:42":600 W/WHEELS (Powder Black) (Metallic Red) (YardMan Green) (Black Jack)	16	742-0616A	2	BLADE:21.23" LG: STAR 3 IN 1
3	710-0726	6	SCREW: AB: 5/16-12 x .75: HXINDWSH	17	747-0418A	1	LINK: HANGER: DECK
4	710-0751	2	SCREW: 1/4-20 x .620: GR5: STD	18	754-0371A	1	BELT: V: 'B' SECT x 74.04" LG
5	710-1260A	8	SCREW: LD: 5/16-18 x .750: HXINDWSH	19	783-04149B-0637 783-04149B-0650 783-04149B-0665 783-04149B-0691	2	COVER: BELT: 5.0" DIA. (Powder Black) (Metallic Red) (YardMan Green) (Black Jack)
6	710-1611B	2	SCREW: TT: 5/16-18 x .750: PANTRXI	20	783-04211-0637	1	BRACKET: STABILIZER: ANTI-SWAY (Powder Black)
7	712-0417A	2	NUT: HEX: FLANG: 5/8-18	21	783-04294A-0637*	1	BRACKET: STABILIZER: DECK : 38"/42" (Powder Black)
8	712-0431	2	NUT: FLANGELOCK:3/8-16:GRF	22	783-04547-0637*	1	DECK: STABILIZER: SPRING MOUNTING (Powder Black)
9	712-3006	2	NUT: HEX: 1/4-20: GR5	23	732-04050D*	1	SPRING: EXT: 1.07 OD x 10.72 LG
10	714-04023	1	PIN:COTTER: .080 x1.56: INT	24	714-0145*	2	PIN: CLICK: .092 x1.64 LG
11	731-1032B	1	CHUTE ASM: SIDE DISCHARGE	25	711-1421*	2	PIN: CLEVIS: 3/8" DIA. x .75 LG
12	734-0973	2	WHEEL: DECK: 5.0 x 1.38	26	710-3008*	2	SCREW:HEX: 5/16"-18 x .75: GR5
13	736-0270	2	WASHER: BELL: .265 x .75 x .062	27	712-0429*	2	NUT: LOCK: NYLON: 5/16"-18
14	736-3008	4	WASHER: FLAT: .344 x.750 x .120	28	769-01186B	1	THIS INSTRUCTION SHEET

Pre-Service Preparation:

1. Turn off engine and remove ignition key. Allow engine and muffler to cool before proceeding.
 2. Remove spark plug wire(s) from spark plug(s) and ground wire(s) to engine block.
 3. Depress the clutch/brake pedal and set the parking brake ON.
 4. Refer to the Operator's Manual Section 8, "Service", "Cutting Deck Removal" and the Illustrated Parts List. Remove existing cutting deck and deck drive belt.
- NOTE: If the lawn tractor is a hydrostatic drive, skip to Step 16.**

NOTE: Left and right are determined from the operator's position facing forward.

5. Look at the unit's stabilizer bracket/deck tensioning spring setup to determine which configuration is present on the unit. (See Figure 2)

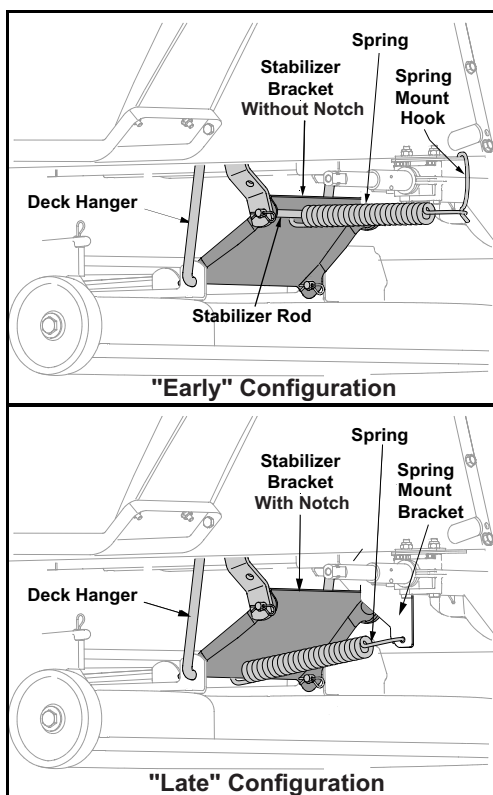

FIGURE 2

6. If you have the "Early" Configuration proceed with Step 7. If you have the "Late" Configuration skip to Step 16.
7. Remove and discard the Spring Mount Hook, Spring, Stabilizer Rod and Deck Stabilizer (without Notch). See Figure 2 "Early" Configuration.

- 8A. Cut out the template, at the bottom of Page 3, along the dotted lines. With a ruler, check the center-to-center distance between the to-be-drilled holes on the template. They must measure 1.750". If the measurement is 1.750" proceed to Step 9.

- 8B. If the to-be-drilled holes' center-to-center distance on the template **DOES NOT** measure 1.750", place the Spring Mounting Bracket, Item 22, over the template as shown by the bracket outline on the template.

Position the Spring Mount Bracket so that the hole in the bracket aligns over the circle on the template that is closest to the ARROWS on the template. Mark the template for the corrected holes location.

9. Refer to Figure 3. From the left underside of the unit locate the torque bracket.

NOTE: The torque bracket is a frame cross member found just forward of the transmission. It has two surfaces at different levels. The left side of the torque bracket is the lower and wider of the two levels.

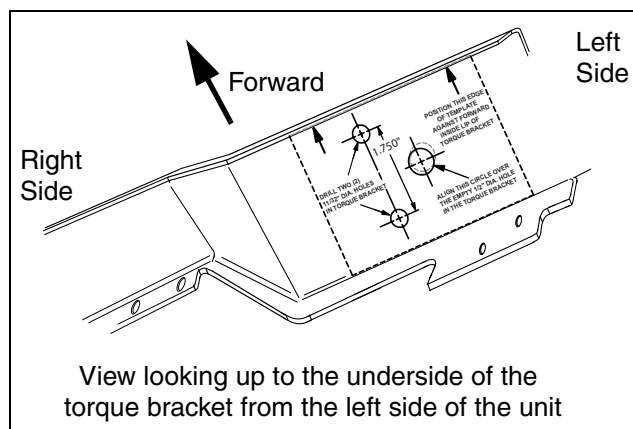

FIGURE 3

10. Locate the empty 1/2" diameter hole in the lower level of the torque bracket. See Figure 3.
11. Place the template on the underside of the torque bracket. Align the template arrows towards the forward lip of the torque bracket and the 1/2" diameter circle on the template over the existing 1/2" diameter hole in the torque bracket. Tape in place.
12. Center punch the to-be-drilled holes location onto the underside of the torque bracket. Remove template.
13. Using an 11/32" drill bit and electric drill, drill two holes through the torque bracket at the center punched locations. Carefully, remove any burrs around the new holes on both sides of the torque bracket.
14. Refer to Figure 1 for proper orientation of the Spring Mount Bracket. Mount the Spring Mount Bracket, Item 22, using the two (2) Hex Screws, Item 26, and two (2) Nylok Hex Nuts, Item 27. Tighten hardward.

15. Install the new Deck Stabilizer Bracket, Item 21, to the stabilizer shaft assembly using two (2) 3/8" Clevis Pins, Item 25, and two (2) Click Pins, Item 24.

16. Refer to the Operator's Manual for installing the new cutting deck assembly. Install the new cutting deck in the reverse order of "Cutting Deck Removal".

NOTE: For units with the new Extension Spring, Item 23, on those units that have the new Spring Mount Bracket, Item 22, and new Deck Stabilizer Bracket, Item 21... Install the spring so that the longer hook end is attached in the notch on the Deck Stabilizer Bracket as shown in Figure 1 inset.

17. Remove the blade spindle brake assembly from under the left side running board. Install two (2) Flat Washer, Item 14, **between the running board and the blade spindle brake assembly** for each bolt. Re-attach the blade spindle brake assembly and tighten hardware.

18. This completes the installation of this Service Kit.

Post-service check-out:

19. Reconnect spark plug wire(s) to spark plug(s).

20. Set Deck Engagement & Lift Lever to the "disengaged" position.

21. Start unit. The blades must not be rotating (engaged).

22. Set the Deck Engagement & Lift Lever to the highest cutting position. The blades should be engaged.

23. Set Deck Engagement & Lift Lever to the "disengaged" position, the blades must come to a quick stop.

24. If any of the engage and disengagement checks fail refer to the "Making Adjustments - Deck Engagement Adjust" section of the Operator's Manual to correct.

NOTES

