



# Service Advisory W-114

**Model:** Z180, Z200, Z180L serial number 1F308G90000 and before

**Date:** September 01, 1998 (REVISED 10/12/98 - Destroy previous copy)

**Subject:** DECK IDLER PULLEY KIT 759-3873

A product improvement has been made to the idler pulleys on the 48" and 54" decks to help prevent the deck belt from jumping off. A product update kit has been developed that contains the necessary parts and instructions. Parts ordering and warranty information can be found below.

Use the illustration below as a supplement to your Z Series parts catalog.

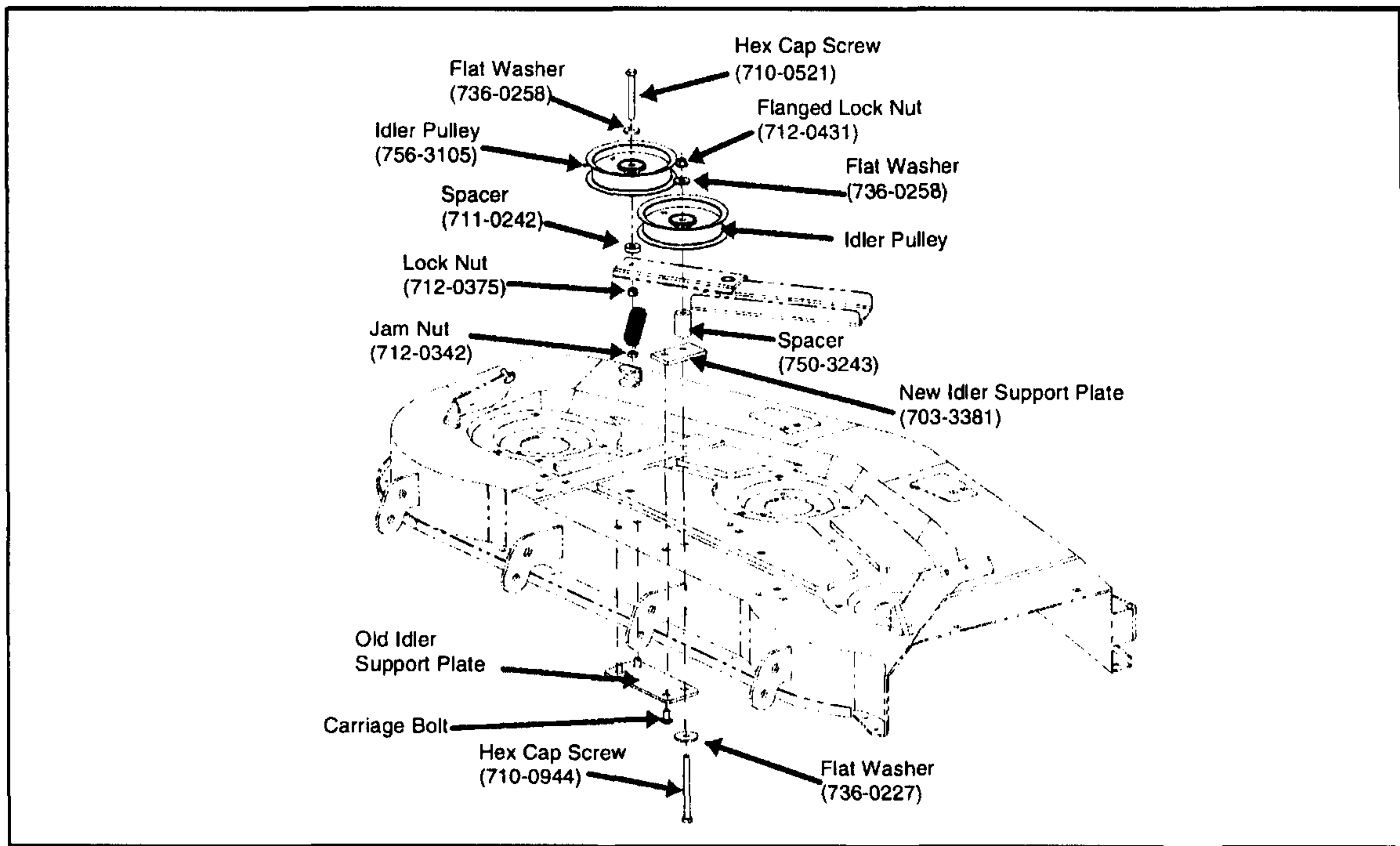

**Warranty Allowance:** If you get a complaint from a customer of the deck belt jumping off, order and install part number 759-3873 Deck Idler Pulley Kit. The kit will be available from Shelby Parts Distribution at **NO CHARGE**. Submit a warranty claim in the usual manner for .6 of an hour labor and memo part number 759-3873 at no charge. **NOTE:** Installation of the no charge kit and labor will be allowed for any unit in dealer's inventory.

| Service Manager | Parts Manager | Service Tech. | Service Tech. | Service Tech. |
|-----------------|---------------|---------------|---------------|---------------|
|                 |               |               |               |               |

Circulate and Initial