



Service Kit

753-06413

753-06414

Date: April 27, 2010

Subject: 50" Deck Idler Bracket and Belt Guard Upgrade

Models Affected: Various Models

REF. S/A: CC-671 / MTD-115

Read and understand these instructions thoroughly before proceeding.

PURPOSE: These service kits provides the hardware required to install the latest production belt guard and idler arm bracket for those 50" decks on lawn tractors (753-06413) that used the wire form belt guard or on RZT units (753-06414) that did not have a belt guard on the tensioning idler.

NOTE: These materials are prepared for use by trained technicians who are experienced in the service and repair of equipment of the kind described in this publication, and are not intended for use by untrained or inexperienced individuals. Such individuals should seek the assistance of an authorized service technician or dealer.

NOTE: Save this Instruction Sheet. Refer to it when ordering replacement parts.

Service Kit 753-06413 Contents for Lawn Tractors

(See Figure 1)

ITEM NO.	PART NUMBER	QTY	DESCRIPTION
1	783-06361A-0637	1	BRKT:IDLER ARM (for LAWN TRACTOR)
2	783-06368A-0637	1	GUARD:BELT: 46" OFFSET
3	*	1	THIS INSTRUCTION SHEET

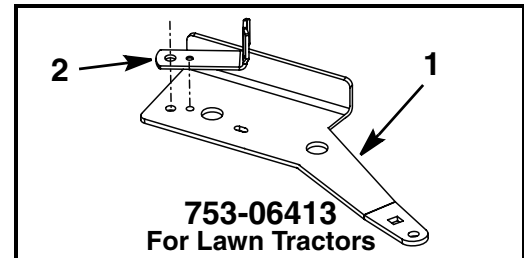

FIGURE 1

Service Kit 753-06414 Contents For RZT Units

(See Figure 2)

ITEM NO.	PART NUMBER	QTY	DESCRIPTION
1	703-05825C-0637	1	BRACKET: IDLER ARM (for RZT)
2	783-06368A-0637	1	GUARD:BELT: 46" OFFSET
3	710-3144	1	SCREW: 3/8"-16 x 2.0" LG: GR5
4	*	1	THIS INSTRUCTION SHEET

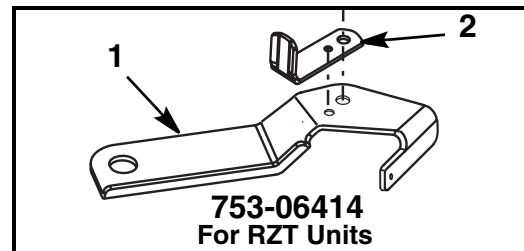

FIGURE 2

* - Not Available Separately

Pre-Service Preparation:

1. Place unit on a flat and level surface.
2. Turn off the engine, remove the ignition key, set the parking brake to ON.
3. Allow engine and muffler to cool before proceeding.
4. Remove spark plug wire(s) from the spark plug(s) and ground to the engine block.

Removal Procedure:

5. Position the cutting deck to the height that places the PTO belt level with the belt at the electric clutch pulley.
6. If so equipped, loosen one side of the engine pulley belt guard sufficiently to be able to slip the belt off of the electric clutch pulley in the next step.

6. Remove the tension on the PTO belt by carefully moving the deck's tensioning idler away from the belt and slipping the belt off of the electric clutch pulley.

7. Remove the deck from under the rider. **NOTE: Refer to the Operator's Manual for deck removal procedure.**

8. Locate the PTO belt's pivoting idler on the deck.

753-06413 For Lawn Tractors

9. Remove and retain the pivoting idler pulley and it's mounting hardware from the idler arm bracket. Discard the wire form belt guard.

NOTE: The screw is a self-tapping screw.

10. Remove the extension spring from the idler arm bracket.
 11. Remove the idler arm bracket from the deck. Retain the mounting hardware and fixed idler pulley. Discard the pivoting idler bracket.
 12. Grease the bottom side of the new Idler Arm Bracket, 783-06361A (Ref. Item 1), and the shoulder spacer's and idler bracket's mating surfaces.
 13. Install the new idler arm bracket and stationary idler pulley onto the deck using the hardware removed in Step 11. See Figure 3.
 14. Place the new Belt Guard, 783-06368A (Item 2), onto the new idler arm bracket. Ensure that the boss on the bottom of the belt guard sets into the hole provided in the idler arm bracket to properly orient the belt guard. See Figure 1.
 15. Refer to Figure 3. Using the parts removed in step 9, place the spacer, 750-3119, between the new belt guard and the pivoting idler pulley, 756-04129B.
- Place the thin washer, 736-0300, on top of the pulley hub followed by the thick washer, 736-3010.
16. Secure the pivoting idler assembly to the pivoting idler bracket with the existing self-tapping screw, 710-1008.
 17. Re-install the extension spring. See Figure 3.
 18. Re-install the deck drive belt. Replace if damaged.
 19. Re-install deck under the lawn tractor.

753-06414 For RZT Units

20. Remove the idler pulley and its' mounting hardware from the existing idler arm bracket. Discard the 3/8"-16 x 1.75" long screw only.
21. Remove the idler arm bracket from the deck. Retain the all mounting hardware. Discard the idler arm bracket.
22. Grease the bottom side of the new Idler Arm Bracket, 703-05825C (Item 1), and the shoulder spacer's and idler arm bracket's mating surfaces.
23. Install the new idler arm bracket onto the deck using the hardware removed in Step 21. See Figure 4.
24. Place the new Belt Guard, 783-06368A (Item 2), onto the new idler arm bracket. Ensure that the boss on the bottom of the belt guard sets into the hole provided in the idler arm bracket to properly orient the belt guard. See Figure 2.
25. Secure the idler pulley on top of the new belt guard to the new idler arm bracket with the new 3/8"-16 x 2.0" Hex Head Screw (Item 3) and hardware removed in step 20.
26. Re-install the extension spring. See Figure 4.
27. Re-install the deck drive belt. Replace if damaged.
28. Re-install deck under the RZT rider.

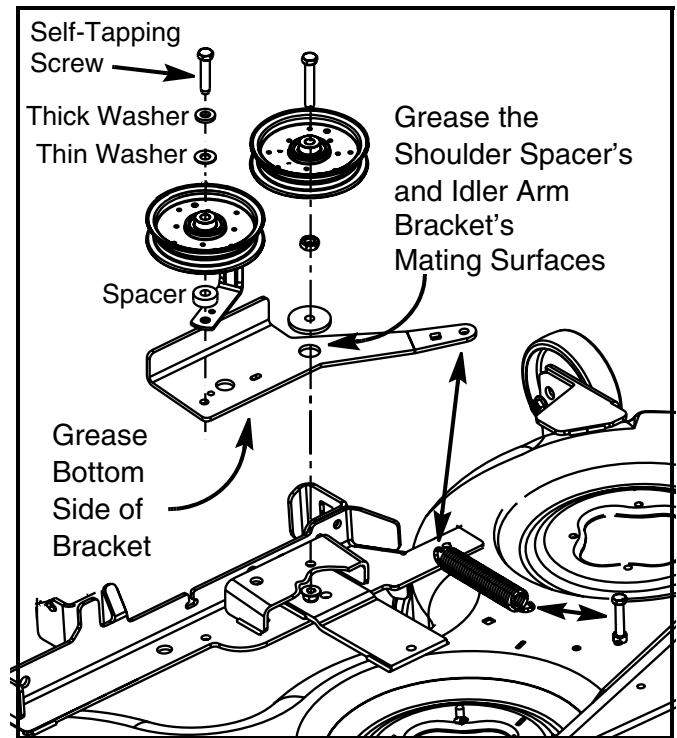

FIGURE 3

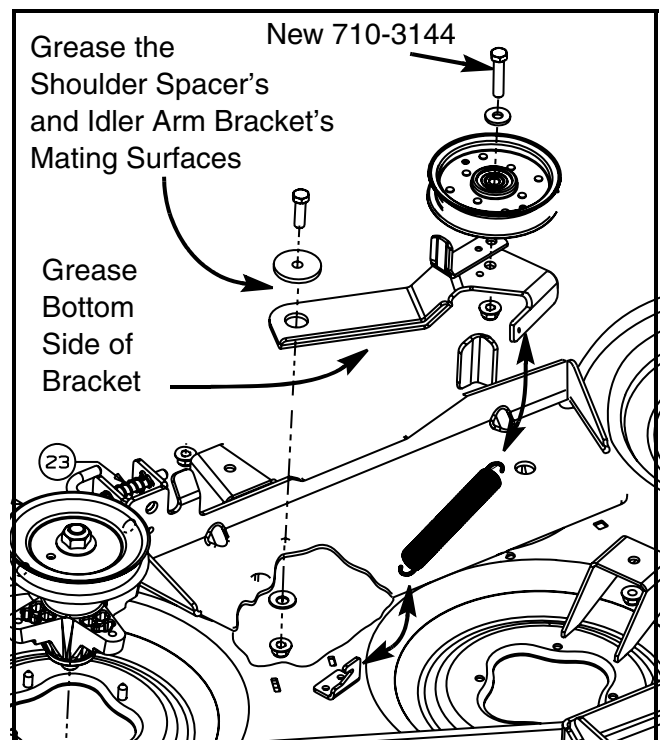

FIGURE 4