



# Service Kit 753-06116

Date: 1/29/2009

Subject: Service Replacement for the  
687-02150-0637 Belt Guide

Models Affected: N/A

**Read through and understand these instructions completely before proceeding with repair.**

**PURPOSE:** This kit provides the hardware and installation instructions for the service replacement of the belt guide 687-02150-0637 which is no longer available.

This kit is applicable to 21" cut 400 and 500 Series walk behind mower models where the engine mounts directly to the metal deck with the belt slot stamped into the metal deck.

This kit is not applicable to 21" cut models with the black plastic spacer between the engine and metal deck and 22" cut models. There is no supplemental baffle for these models.

**NOTE:** *These materials are prepared for use by trained technicians who are experienced in the service and repair of equipment of the kind described in this publication, and are not intended for use by untrained or inexperienced individuals. Such individuals should seek the assistance of an authorized service technician or dealer.*

**NOTE:** *Save this Instruction Sheet. Refer to it when ordering replacement parts.*

## Service Kit Contents

(See Figure 1)

ITEM NO.	PART NUMBER	QTY	DESCRIPTION
1	731-06029	1	BAFFLE
2	787-01593	1	CLIP
	*	1	THIS INSTRUCTION SHEET

\* - Not Available Separately

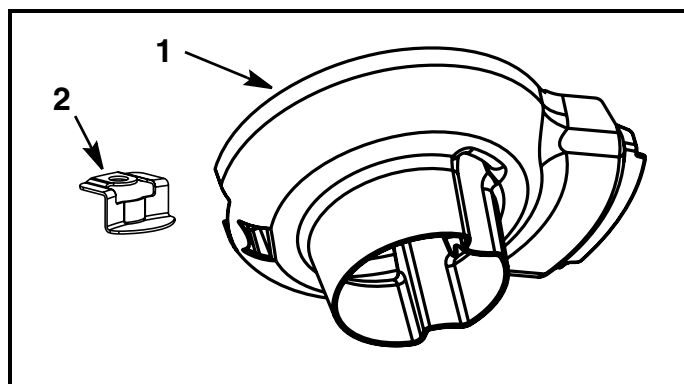

**FIGURE 1**

### Pre-Service Preparation:

1. Place mower on a flat and level surface, turn off engine and allow muffler and engine to cool before proceeding.
2. Remove spark plug wire from the spark plug and ground to the engine block.
3. Drain the fuel tank. (Preferred). Ensure the oil fill port or dipstick is tight.

Optional: Remove the fuel cap. Place a piece of thin plastic sheet over the fuel tank opening and replace the cap tightly.

4. Remove the front transmission cover. Remove any cut grass and/or debris that has accumulated under the cover. Ensure there is no grass packed in the engine or transmission pulley's "V" belt channel.

5. Place mower on its side so that the carburetor/air filter are pointed up. Ensure that fuel is not leaking from fuel tank.

6. Using a 5/8" socket and ratchet, remove the bolt retaining the blade to the crankshaft. Remove the blade. There is no need to remove the blade adapter.

**Installation of the 931-06029:**

7. Using a 1/2" socket, extension and ratchet, remove the one engine self-tapping screw shown in Figure 2.

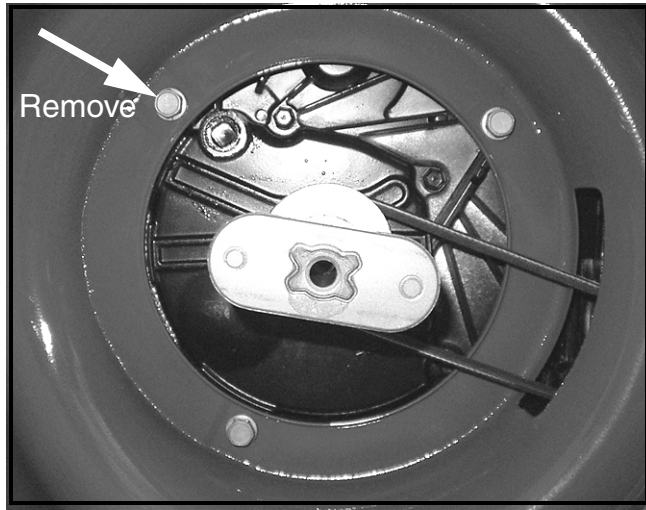

**FIGURE 2**

8. Install the metal clip with the engine screw removed in Step 7. Torque to 200 - 350 In-Lbs. See Figure 3 Inset.

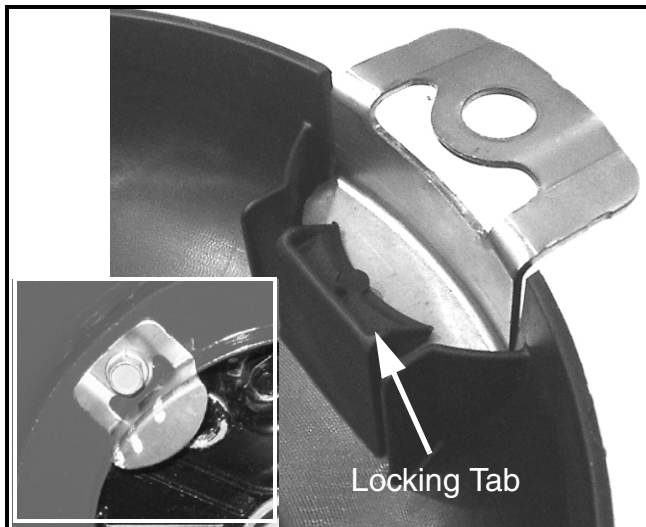

**FIGURE 3**

9. Place the 931-06029 baffle over the blade adapter and insert the baffle's bill into the deck slot. See Figure 4. Ensure that the lip on the bill seats into the deck slot as shown in Figure 4 Inset.

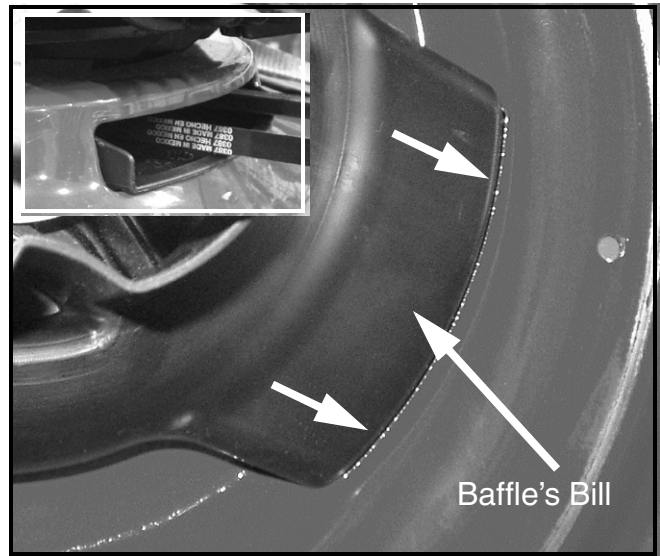

**FIGURE 4**

10. Rotate the back end of the baffle up towards the clip and using a wide flat blade screwdriver, press the locking tab, see Figure 3, in towards the crankshaft while pushing the baffle against the deck. Ensure the locking tab fully grips the clip by pulling on the baffle. See Figure 5 for finished installation.

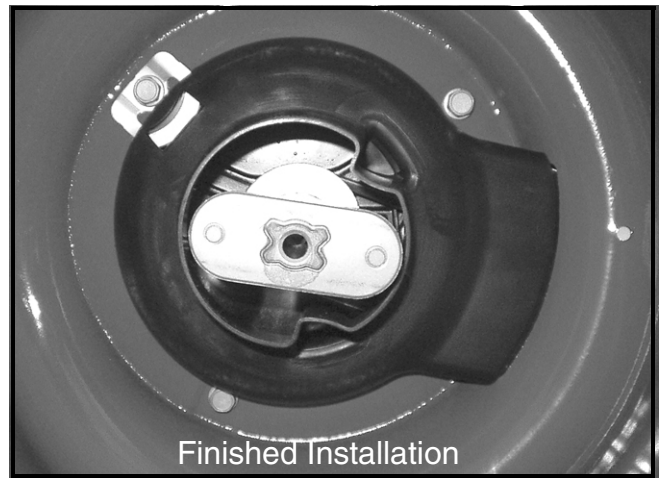

**FIGURE 5**

11. Lubricate the engine crankshaft and the inner surface of the blade adapter with light oil. When re-installing the cutting blade ensure that the blade bolt is torqued to 450 to 600 In-Lbs.

This completes the service kit installation repair.