

Ref #	Part Number	Qty	S/P/F	Description
1	981-0156A-0638	1	/P	Handle Bracket Ass'y RH
1	981-0155A-0638	1	/P	Handle Bracket Ass'y LH (Not Shown)
2	749-04163-0637	1		Upper Handle
3	720-0279	1	/P	Knob
4	710-1205	1	/P	Eye Bolt
5	781-1056-0637	1	/P	Upper Handle Bracket
6	710-0726	1	/P	Hex Cap Screw, 5/16-12 x.750
7	720-04072A	1	/P	Handle Knob, 5/16-18
8	710-1174	1	/P	Carriage Bolt
9	731-04911	1		Nozzle Handle Clip
10	749-04165-0637	1	/P	Lower Handle
11	711-1293	1	/P	Studs
12	710-0703	1	/P	Carriage Screw, 1/4-20 x.75
13	912-0397	1	/P	Wing Nut, 1/4-20
14	710-1611B	1	/P	TT Screw, 5/16-18 x .750
15	710-0599	1	/P	Screw, 1/4-20 x .500
16	912-0442	1	/P	Cap Lock Nut, 1/4-20
17	912-0291	1	/P	Hex Lock Nut, 1/4-20
18	731-06445	1		Hose Extension
19	723-04008A	1	/P	Chute Strap
20	911-04069	1	/P	Pin
21	782-7598	1		Belt Keeper
22	936-3020	1	/P	Flat Washer.271 ID x.630 OD
23	781-04266-0638	1		Upper Flail Housing
24	746-04156	1		Drive Control Cable
25	731-1820	1	/P	Cable Guide
26	681-04088-0638	1		Chipper Chute Assembly
27	746-04155	1		Speed Control Cable
28	710-1122	1	/P	Hex Screw, 1/4-20 x 2.50
29	710-04666	1		Screw, 1/4-20 x .75
30	712-04064	1	/P	Flange Lock Nut, 1/4-20
31	748-0457	1		Spacer
32	731-2478	1		Hose Nozzle
33	710-3288	1		Hex Cap Screw, 1/4-20 x 2.625
34	723-0295	1	/P	Adjustment Clamp
35	749-1270A	1	/P	Nozzle Handle
36	764-0648A	1	/P	Vacuum Hose
37	720-0369	1		Handle Plug
38	731-2292	1		Hose Adapter
39	747-04305A	1		Drive Control
40	725-0157	1	/P	Cable Tie
41	918-04460	1	/P	Transmission Assembly
42	981-04027	1		Idler Assembly (Incl. Ref.# 74-80)
43	710-1650	1	/P	Shoulder Screw, #12-24 x .30 x .46
44	710-1220	1	/P	Screw, #12-16 x .750
45	911-04245	1	/P	Impeller Hub
46	915-0221	1	/P	Dowel Pin
47	781-04082-0637	1	/P	Front Wheel Support Brace
48	781-04081-0637	1	/P	Rear Wheel Support Brace
49	914-0104	1	/P	Cotter Pin
50	916-0104	1	/P	E-Ring
51	936-3004	1	/P	Flat Washer, .406 x .875 x .105
52	936-0232	1	/P	Wave Washer, .531 ID x.781 OD

Ref #	Part Number	Qty	S/P/F	Description
53	738-1015	1		Shoulder Screw, 3/8-16
54	734-04018A	1	S	Wheel, 8 x 2.125
55	716-0865	1	/P	Snap Ring
56	741-04242	1		Height Adjustment Bearing
57	687-02342	1		Pivot Arm Assembly
58	720-0426	1	/P	Height Adjustment Knob
59	732-1026	1		Spring Lever
60	736-0741	1	/P	Bell Washer, .760 ID x.25 OD
61	738-1172	1	/P	Shoulder Screw, .750 x.500
62	987-02051	1	/P	Height Lever Assembly (Incl. Ref.# 58-59)
63	734-04033	1	/P	Wheel 8 x 2
64	710-1652	1	/P	Screw, 1/4-20 x .625
65	712-04065	1	/P	Flange Lock Nut, 3/8-16
66	731-04879	1		Belt Cover
67	936-0314	1	/P	Thrust Washer, .375 ID x.70 OD
68	731-04643	1	/P	Wheel Cover
69	732-04217	1		Extension Spring, .375 x 2.95
70	936-0369	1	/P	Flat Wash, .508ID x1.00OD x.020
71	738-0930	1	/P	Shoulder Screw, .560 x.165
72	741-04108	1		Drive Axle Bushing
73	781-04078-0637	1	/P	Transmission Mounting Bracket
74	710-0597	1	/P	Screw, 1/4-20 x 1.00
75	717-1762	1		Spur Gear - RH
75	717-1761	1		Spur Gear - LH (Not Shown)
76	941-0124	1	S	Ball Bearing
77	750-1050	1		Flange Spacer,.260 x.659 x.517
78	954-0369	1	/P	Belt, 3/8 x 32.5
79	781-04077-0637	1	/P	Idler Bracket

Ref #	Part Number	Qty	S/P/F	Description
1	964-04031	1	/P	Bag Assembly
2	681-0154-0637	1	/P	Screen Assembly
3	710-1054	1	/P	Hex Screw, 5/16-24 x 1.0
4	981-0490	1	/P	Chipper Blade
5	781-0735	1		Pin Clip
6	719-0329	1		Flail
7	715-0166	1		Spiral Pin
8	711-1401	1		Clevis Pin
9	912-0411	1	/P	Lock Nut, 5/16-24
10	936-0119	1	/P	Lock Washer, 5/16
11	981-0152	1	/P	Impeller Assembly (Incl. Ref.# 3 - 10)
12	781-0721B-0638	1	/P	Lower Flail Housing
13	712-04063	1	/P	Flange Lock Nut, 5/16-18
14	710-0607	1	/P	Screw, 5/16-18 x.500
15	747-04297	1		Hinge Pin
16	981-04031	1	/P	Nozzle
17	781-1064	1		Base Adapter Door
18	732-1156	1		Torsion Spring
19	926-0106	1	/P	Cap Speed Nut, 1/4
20	711-1551	1		Pivot Rod
21	731-04967	1		Nozzle Door Lever
22	710-1256	1	/P	Hex Screw, #8-18 x 1.25
23	750-1294	1		Shoulder Spacer
24	732-3118	1		Extension Spring
25	732-1151A	1		Nozzle Door Torsion Spring
26	731-2294A	1	/P	Nozzle Door
27	664-04029	1		Bag
28	631-0083	1		Chute Assembly
29	736-0247	1	/P	Flat Washer, .375 ID x 1.25 OD
30	936-0217	1	/P	Lock Washer, 3/8
31	710-1273	1		Hex Cap Screw, 3/8-24 x 2.75
32	631-04118	1		Engine Spacer Assembly
33	710-1008	1		Screw, 3/8-16 x 1.875
34	925-1700	1	/P	Switch Cover
35	925-3166	1	/P	Safety Switch
36	931-1613	1	/P	Safety Switch Cover
37	910-0224	1	/P	Hex Washer Screw, #10-16 x.50
38	629-0920A	1	/P	Wire Harness
39	914-0104	1	/P	Cotter Pin
40	732-0962	1		Compression Spring
41	781-0778A-0637	1	/P	Mounting Bracket
42	747-1153	1		Lock Rod
43	710-3195	1		Hex Cap Screw, 5/16-18 x 4.5
44	710-3025	1	/P	Hex Cap Screw, 5/16-18 x.625
45	710-1220	1	/P	Screw, #12-16 x.750
46	710-0351	1	/P	Screw, #10 - 16 x.500
47	736-0607	1	/P	External L-Washer, 5/16
48	726-0139	1	/P	Speed Nut
49	710-0726	1	/P	Hex Index Screw, 5/16-12 x.750
50	710-1650	1	/P	Shldr. Screw, #12-24 x .30 x .46
51	681-0195	1	/P	Hose Base Adapter Assembly (Incl. Ref.# 52-54)
52	916-0104	1	/P	E Ring, .500 Dia

24B-070J766 CSV070 Chipper Shredder Vac (2009)
Impeller Assembly

Page 6 of 10

Ref #	Part Number	Qty	S/P/F	Description
53	932-3035	1	/P	Compression Spring
54	711-1571	1		Clevis Pin
55	710-0599	1	/P	Screw, 1/4-20 x .500
56	936-3020	1	/P	Flat Washer, .271 ID x.630 OD
	723-0400	1	/P	Safety Glasses (Not Shown)

REF.: If Ethanol Information
Is Not Supplied By Engine
Manufacturer, Place 777X43688
On Engine Close To Fuel Cap

777S32432



777D12665



Model Plate

777S33200

Place Under Chipper Chute
On Side Of Housing

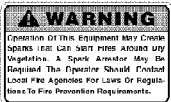

777S33123

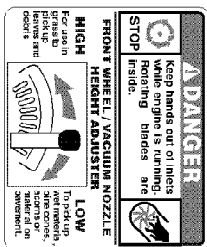

777I22415
Line Up To Shifter

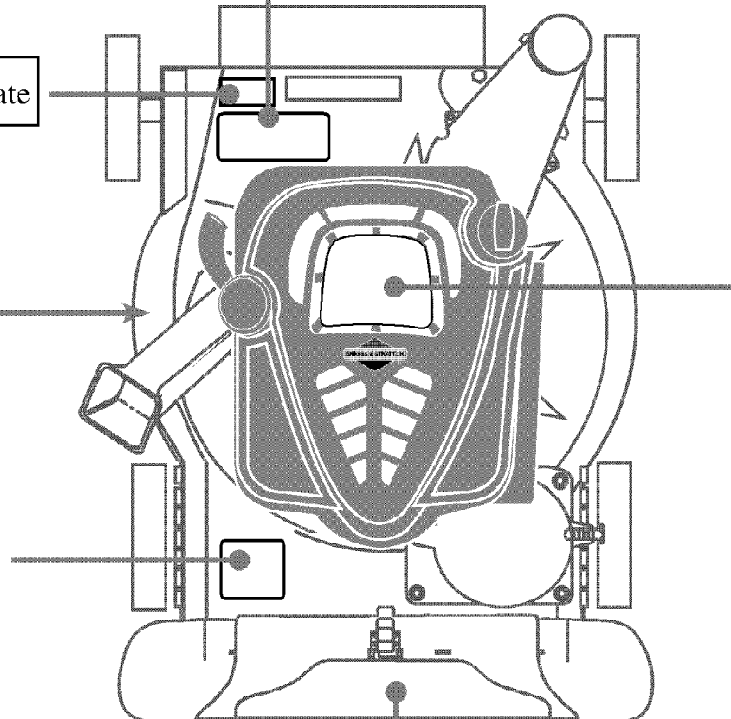
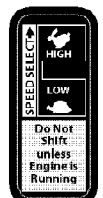

777I22840

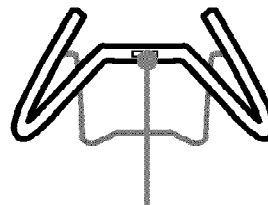
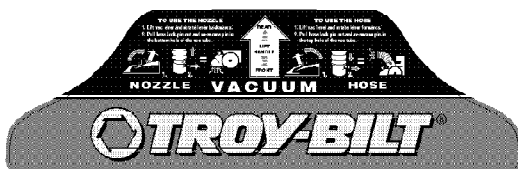

777I22416
Center On Top Of Handle

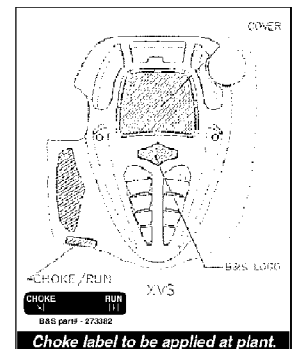

24B-070J766 CSV070 Chipper Shredder Vac (2009)
Label Map

Page 8 of 10

Ref #	Part Number	Qty	S/P/F	Description
777S32432	777S32432	1		LABEL-DECK
777S33200	777S33200	1		LABEL-WARNING SPARKS
777S33123	777S33123	1		LABEL-CSV BLADES DANGER
777I22840	777I22840	1		LABEL-CSV NOZZLE TROY
777I22416	777I22416	1		LABEL-HANDLE
777I22415	777I22415	1		LABEL-HANDLE
777D12665	777D12665	1		LABEL-CSV SHROUD TROY
777X43688	777X43688	1		LABEL-ETHANOL

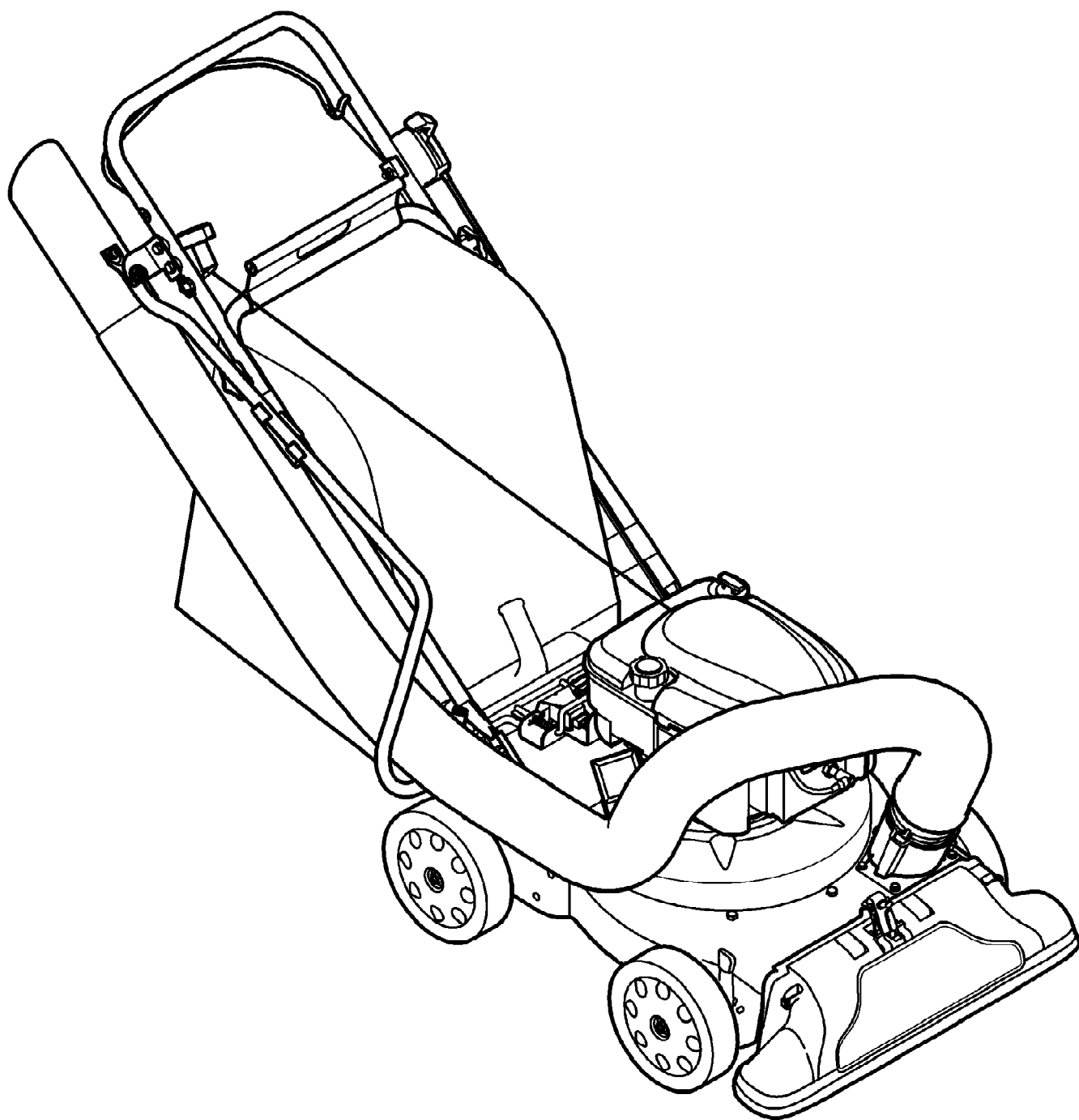

Ref #	Part Number	Qty	S/P/F	Description
	759-3336	1	/P	Spark Plug
	BS-493537S	1	/P	Pre Filter
	BS-491588S	1	/P	Air Filter
	981-0152	1	/P	Impeller Assembly
	981-0490	1	/P	Chipper Blade
	719-0329	1		Flail Blade
	681-0154-0637	1	/P	Screen Assembly
	681-04088	1		Chipper Chute
	754-0369	1	S	Drive Belt
	746-04156	1		Drive Control Cable
	746-04155	1		Speed Control Cable
	N/A	1		Chain
	925-3166	1	/P	Safety Switch
	720-04072	1	S	Handle Knob
	734-04033	1	/P	Wheels - Front
	734-04018A	1	S	Wheels - Rear
	N/A	1		Hub Cap
	664-04029	1		Grass Bag
	964-04031	1	/P	Bag Chute Assembly
	764-0648A	1	/P	Vacuum Hose