



SERVICE BULLETIN 116

INFORMATIONAL

ISSUED: September 1993

REVISED: June 2001

SUBJECT: Recoil Identification

During the past few years we have introduced you to several new styles of recoil assemblies. These recoils are used on all small and medium frame series engines. To assist you in making repairs, we have developed the quick reference illustrations below. By looking at the direction and style of ribs between the inner and outer parts of the pulley, you can use this chart to obtain the correct parts. Due to various housings, these parts will not be shown. **When parts are needed in addition to the ones shown in these illustrations, complete replacement should be considered.**

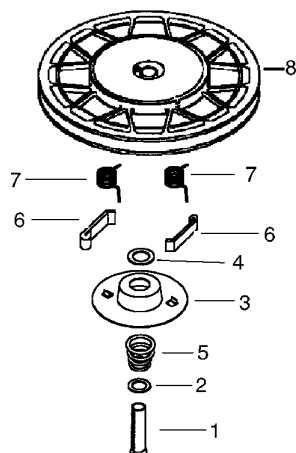

TYPE 1

- | | | |
|---|---------|-----------------------------------------|
| 1 | 590599A | Spring Pin (Incl. No. 4) |
| 2 | 590600 | Washer |
| 3 | 590696 | Retainer |
| 4 | 590601 | Washer |
| 5 | 590697 | Brake Spring |
| 6 | 590698 | Starter Dog |
| 7 | 590699 | Dog Spring |
| 8 | 590700 | Pulley & Rewind Spring Assy. (non-snow) |
| 8 | 590709 | Pulley & Rewind Spring Assy. (snow) |

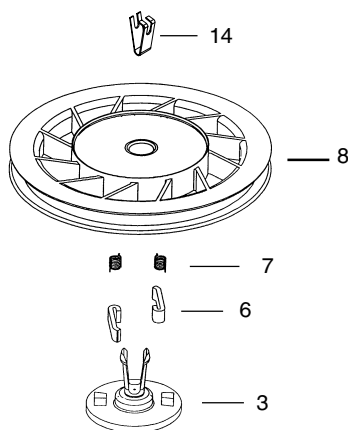

TYPE 2

- | | | |
|----|---------|-----------------------------------------|
| 3 | 590740 | Retainer |
| 6 | 590616 | Starter Dog |
| 7 | 590617 | Dog Spring |
| 8 | 590618A | Pulley & Rewind Spring Assy. (non-snow) |
| 8 | 590645A | Pulley & Rewind Spring Assy. (snow) |
| 14 | 590760 | Locking Tab |

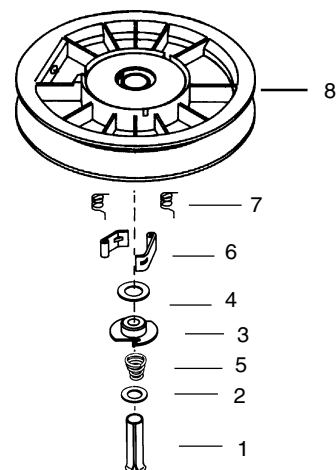

TYPE 3

- | | | |
|---|---------|-----------------------------------------|
| 1 | 590599A | Spring Pin (Incl. No. 4) |
| 2 | 590600 | Washer |
| 3 | 590679 | Retainer |
| 4 | 590601 | Washer |
| 5 | 590678 | Brake Spring |
| 6 | 590680 | Starter Dog |
| 7 | 590412 | Dog Spring |
| 8 | 590681 | Pulley & Rewind Spring Assy. (non-snow) |
| 8 | 590682 | Pulley & Rewind Spring Assy. (snow) |

TYPE 1, 2 & 3

- | | | |
|--------|---|--------------------------------------------|
| 590535 | - | Starter Rope (Length 98" - 9/64" diameter) |
| 590701 | - | Starter Handle (non-snow) |
| 590574 | - | Mitten Grip Handle (snow) |