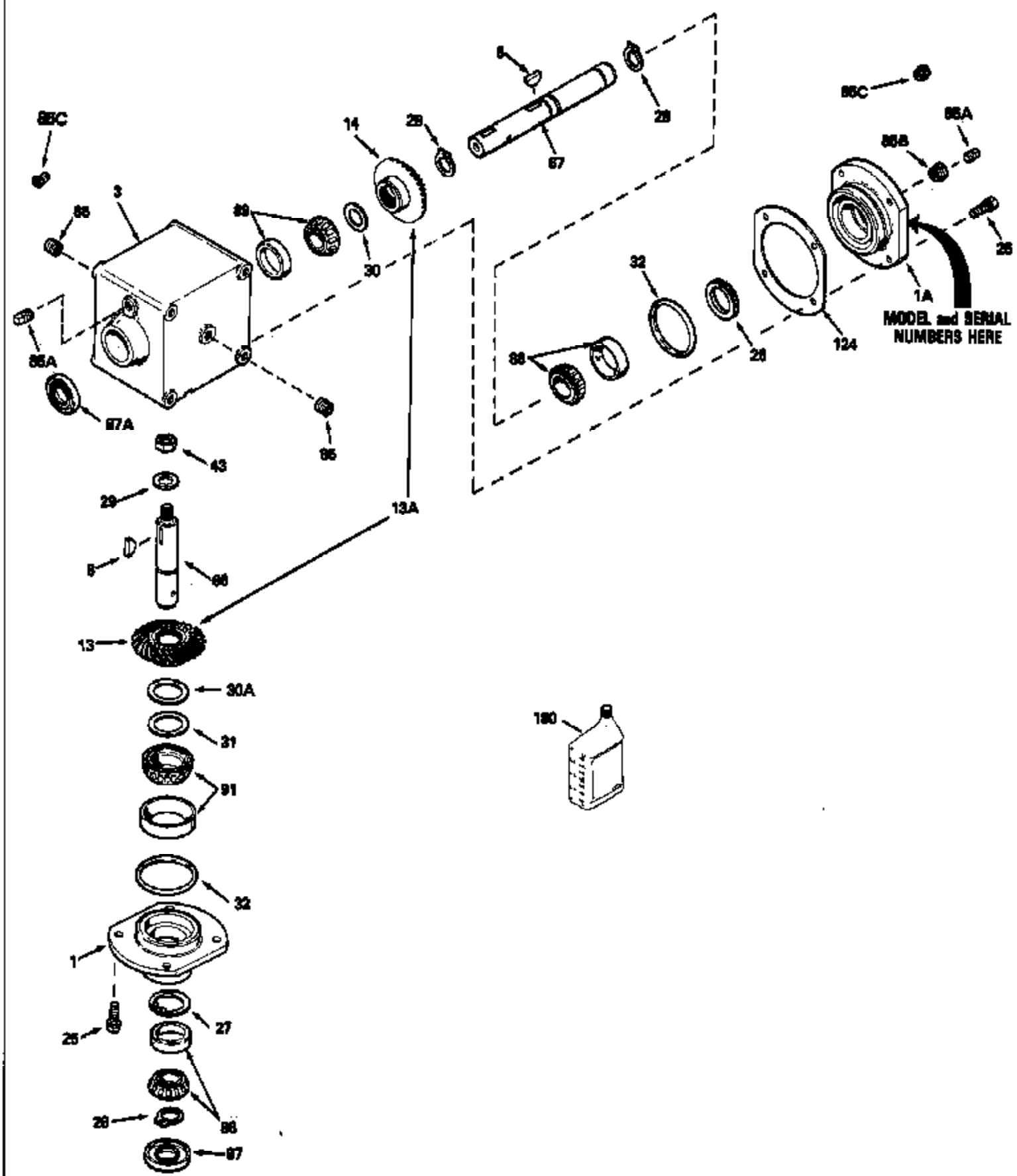

ILLUSTRATION SHOWS TYPICAL PARTS ONLY. ORDER BY PART NUMBER. PARTS NOT LISTED ARE SUPPLIED BY OEM.



MODEL and SERIAL NUMBERS HERE

Ref #	Part Number	Qty	Description
	794337		RA Drive Head Ass'y (Incl. 1 thru 124 )
1A	786106		Retainer Cap
1	786104A		Retainer Cap
3	770076		Right Angle Drive Housing
8	792114		Woodruff Key No. 807
13	778169		Bevel Gear (27 teeth)
14	778173		Bevel Gear (18 teeth)
25	792037		Screw, 5/16-18 x 1"
26	780137		Load Ring
27	792112		Retaining Ring
28	792113		Retaining Ring
29	792115		Flat Washer
30	780131	1100-1100-068	Shim Page 2 of 2
31	780138	Peerless	Shim
32	788063		"O" Ring
43	792110A		Hex Jam Nut, 3/4-16
66	776221		Input Shaft (4-7/8" long)
67	776223		Output Shaft (7-1/4" long)
85C	792118		Relief Valve
85	792116		Pipe Plug, 1/4-18
85A	792039		Pipe Plug, 1/8"
87A	788065		Oil Seal
87	788064		Oil Seal
88	780132		Bearing & Cup Ass'y (SEE REPAIR MANUA L)
89	780132		Bearing & Cup Ass'y (SEE REPAIR MANUA L)
91	780134		Bearing & Cup Ass'y (SEE REPAIR MANUA L)
124	780136		Retainer Cap Shim
180	730229A		Gear Oil 80W90