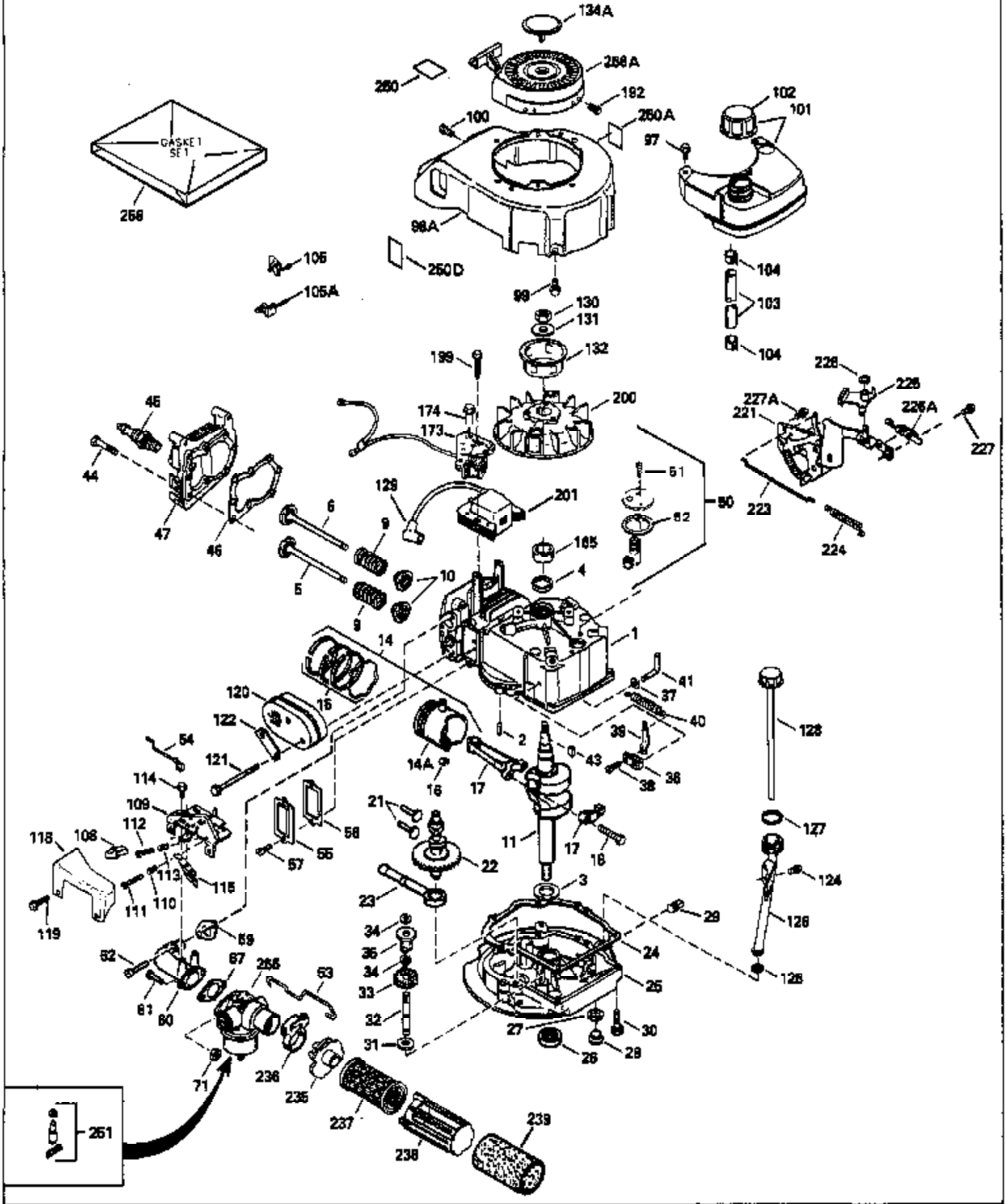

ILLUSTRATION SHOWS TYPICAL PARTS ONLY. ORDER BY PART NUMBER. PARTS NOT LISTED ARE SUPPLIED BY OEM.



Ref #	Part Number	Qty	Description
1	34959		Cylinder (Incl. 2, 4, 50, 51 & 52) (2 -5/8")
2	26727		Pin, Dowel
3	32323		Washer, Thrust
4	32600		Seal, Oil
5	29313C		Exhaust Valve (Std.) (Incl. 10) (Conventional Ports)
5	29315C		Exhaust Valve (1/32" OS) (Incl. 10) (Conventional Ports)
6	29314B		Intake Valve (Std.) (Incl. 10) (Conventional Ports)
6	29315C		Intake Valve (1/32" OS) (Incl. 10) (Conventional Ports)
9	31672		Spring, Valve
10	31673		Cap, Lower valve spring
11	35166		Crankshaft
14	35544		Piston, Pin & Ring Set (Std.) (2-5/8" Bore)
14	35545		Piston, Pin & Ring Set (.010" OS)
14	35546		Piston, Pin & Ring Set (.020" OS)
14A	35541		Piston & Pin Ass'y. (Incl. 16)(Std.)(2-5/8")
14A	35542		Piston & Pin Ass'y. (Incl. 16) (.010" OS)
14A	35543		Piston & Pin Ass'y. (Incl. 16) (.020" OS)
15	35547		Ring Set (Std.) (2-5/8" Bore)
15	35548		Ring Set (.010" OS)
15	35549		Ring Set (.020" OS)
16	20381		Ring, Piston pin retaining
17	30963B		Rod Assy., Connecting (Incl. 18)
18	32610A		Bolt, Connecting rod
21	27241		Lifter, Exhaust valve
22	33148A		Camshaft
23	29914		Pump Assy.
24	35261		* Gasket, Mounting flange
25	34311B		Flange Ass'y. (Incl. 26, 28, 29 & 32)
26	27897		Seal, Oil
28	27244		Plug, Oil drain
30	650488		Screw, 1/4-20 x 1-1/4"
31	30590A		Washer, Flat
32	30574		Shaft, Mechanical governor
33	30591		Gear Assy., Governor (Incl. 31)
34	29193		Ring, Retaining
35	30588A		Spool, Governor
36	31335		Clamp, Governor lever
37	28277		Washer, Flat
38	650548		Screw, 8-32 x 5/16"
39	31383A		Lever, Governor
40	31361		Spring, Governor
41	30589		Rod, Governor (Incl. 37)
43	611004		Key, Flywheel
44	6021A		Screw, 5/16-18 x 1-1/2"
45	35395		Resistor Spark Plug (RJ-19LM)
46	32643		* Gasket, Cylinder head
47	34335		Head, Cylinder
50	34215		Breather Assy. (Incl. 51 & 52)
51	30200		Screw, 10-24 x 9/16"
52	32760		* Gasket, Breather
53	34336		Link, Governor-to-throttle
54	34337		Link, Governor spring
55	32755		Cover, Valve spring box
56	27234		* Gasket, Valve spring cover
57	650128		Screw, 10-24 x 1/2"
59	34690		* Gasket, Intake
60	31384A		Pipe, Intake (Incl. 59)
61	6201		Screw, 1/4-28 x 7/8"

Ref #	Part Number	Qty	Description
62	650451		Screw, 1/4-20 x 1"
67	26756		* Gasket, Carburetor
71	29752		Nut & Lockwasher, 1/4-28
97	28763		Screw, 10-32 x 19/32"
99	650831		Screw, 1/4-20 x 1/2"
100	30200		Screw, 10-24 x 9/16"
101	34369A		Fuel Tank (Incl. 102 & 104)
102	35355		Fuel Cap
103	30705		Fuel Line (Braided 16")
104	26460		Clamp, Fuel line
108	32410		Knob, Speed control
109	33205A		Control Bracket (Incl. 110,111,112,113 & 115)
110	33802		Spring, Compression
111	650777		Screw, 6-32 x 17/32"
112	650549		Screw, 6-50 x 7/16"
113	31342		Spring, Compression
114	30200		Screw, 10-24 x 9/16"
115	610973		Terminal Assy.
118	35177		Cover, Speed control
119	650807		Screw, 10-32 x 7/16"
121	792005		Screw, 1/4-20 x 2-1/2"
122	33753		Plate, Lock
124	650562		Screw, 10-32 x 1/2"
125	34265		Gasket, Oil fill tube
126	35577		Tube Assy., Oil filler
127	35499		"O" Ring
128	35578		Dipstick, Oil
130	650816		Nut, Flywheel
131	650815		Washer, Belleville
165	34080		Spacer, Flywheel Key
192	650802		Screw, 1/4-20 x 5/8"
199	650814		Screw, 10-24 x 1"
200	611046A		Flywheel
201	34443A		Solid State Assy.
235	35067		Collar, Air cleaner
236	35068		Clamp, Air cleaner
237	35066		Element, Air cleaner
238	35065		Cover, Air cleaner
239	35435		Filter, Pre-air (Use as required) (Po ly)
250	34442A		Decal, Instruction
251	631021		Inlet Needle, Seat & Clip Assy.
255	632389		Carburetor (Incl. 67) (Refer to Division 5, Section A, page 196 for breakdown)
258	33238B		* Gasket Set (Incl. items marked *)

Ref #	Part Number	Qty	Description
51	30200		Screw, 10-24 x 9/16"
92	34231		Ground Wire
98	34480		Housing, Blower
100	30200		Screw, 10-24 x 9/16"
102	35355		Fuel Cap
120A	33556		Muffler
121	792005		Screw, 1/4-20 x 2-1/2"
122	33753		Plate, Lock
130	650816		Nut, Flywheel
131	650815		Washer, Belleville
134	34113		Plug, Screen
192	650802		Screw, 1/4-20 x 5/8"
256	590531		Side Mount Rewind Starter (Refer to Division 5, Section C, page 32 for breakdown)