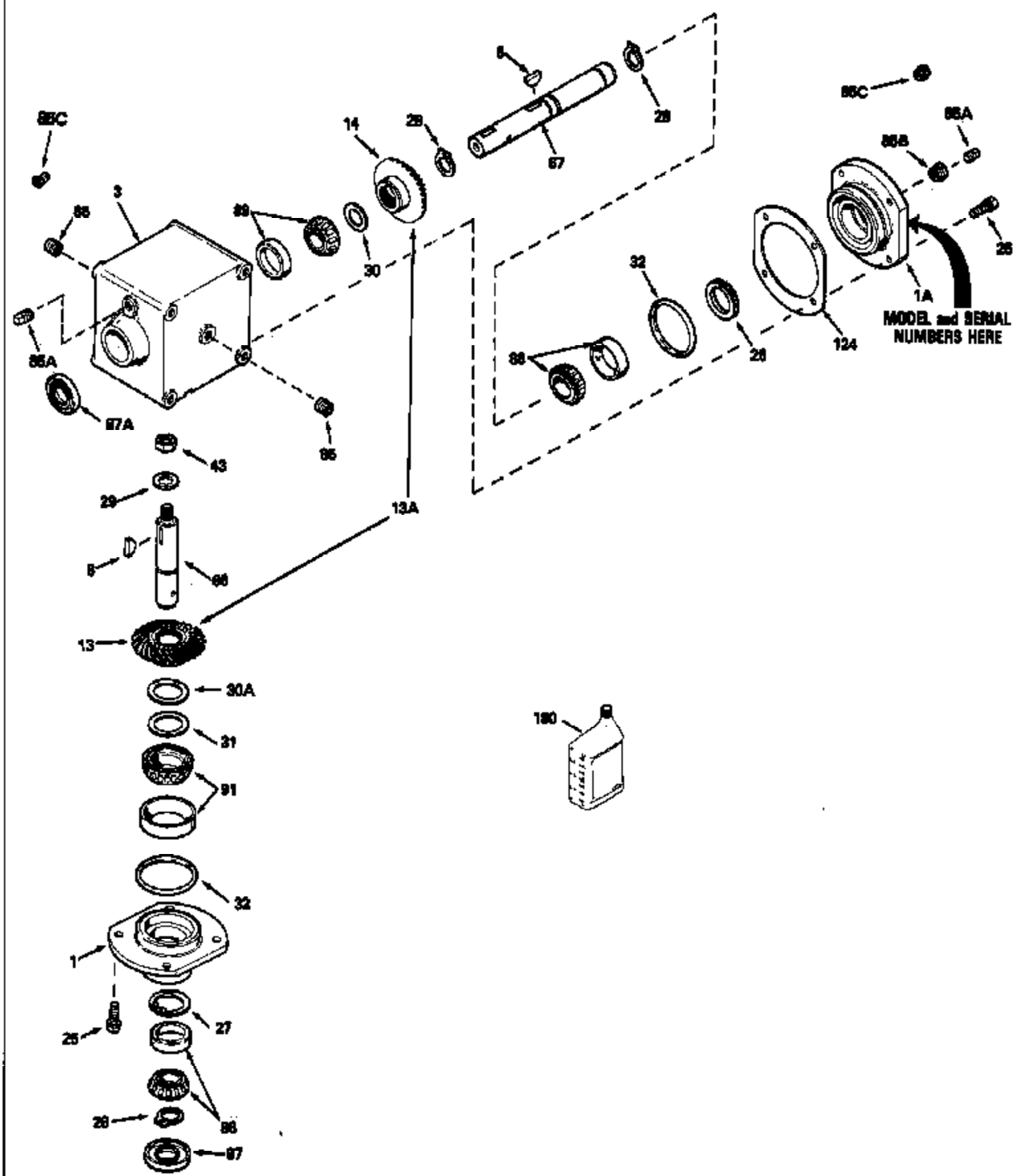

ILLUSTRATION SHOWS TYPICAL PARTS ONLY. ORDER BY PART NUMBER. PARTS NOT LISTED ARE SUPPLIED BY OEM.



MODEL and SERIAL NUMBERS HERE

Ref #	Part Number	Qty	Description
1A	786106	1	Retainer Cap
1	786125	1	Retainer Cap
3	770076	1	Right Angle Drive Housing
8	792114	1	Woodruff Key
13	778233	1	Bevel Gear (14 teeth)
14	778232	1	Bevel Gear (28 teeth)
25	792037	8	Screw, 5/16-18 x 1"
26	780137	1	Load Ring
28	792113	3	Retaining Ring
29	792127	1	Washer
30	780131	1	Shim (1-1/2" OD x 1-1/64" ID x .002 t hick)
30A	780101	1	Washer
31	780147	1	Shim
32	788063	1	"O" Ring
43	792126	1	Hex Jam Nut
66	776268	1	Input Shaft (4.935" long)
67	776223	1	Output Shaft (7-1/4" long)
85B	792118	1	Relief Valve (1/8-27 to 7/16")
85C	792117	1	Reducer Bushing (1/8-27 to 1/4-18)
85	792116	2	Pipe Plug, 1/4-18
85A	792039	2	Pipe Plug, 1/8-27
87A	788065	1	Oil Seal, 1"
87	788064	1	Oil Seal, 1"
88	780132	3	Bearing & Cup Assembly (SEE REPAIR MA NUAL)
91	780148	1	Bearing & Cup Assembly (SEE REPAIR MA NUAL)
124	780136	1	Shim
180	730229A	1	Gear Oil 80W90

1100-1100-033 Shim Page 2 of 2
Peerless