



| | |
|---------------------|-----------------|
| Service Note | N0207001 |
| | 2002-02 |

Models 145 BT/ BF 165 BT
Involved: 155 BT/ BF

Subject: Fan Intake Cover

In order to prevent the accumulation of leaves or other debris in the fan intake area, a fan intake cover (part # 695 00 08-12) has been designed to install between the fan housing and the backpack frame.

During assembly, please ensure that this cover is securely installed onto the fan housing. When positioned correctly, a "click" will be heard when the cover is pressed on.

See pages 2 & 3 for pictures of the installation.

Fan Intake Cover
695 00 08-12

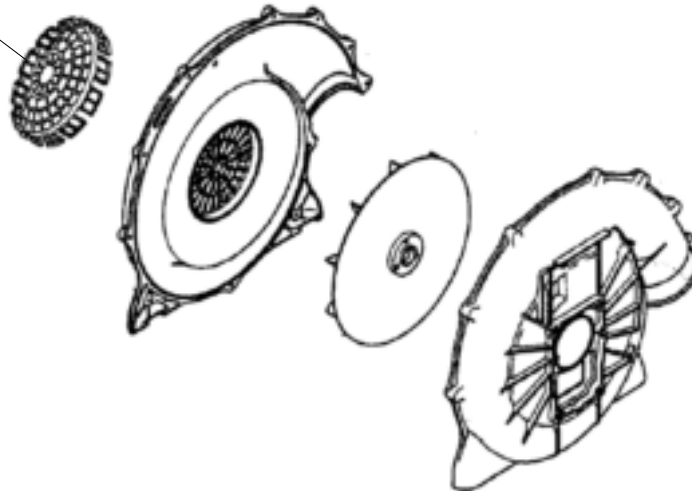

Installation of fan cover

Positioning fan cover

• Fan cover

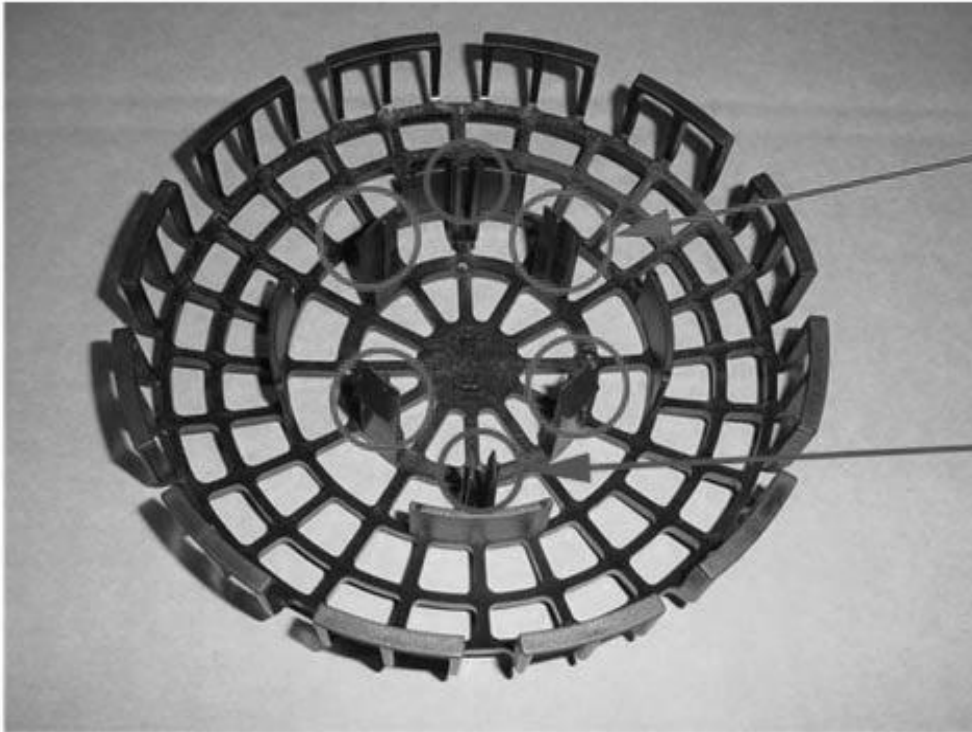

Claw "A" (4 locations)

Claw "B" (2 locations)

• Fan case



Rib "A" (4 locations)

Rib "B" (2 locations)

Position the rib to be pointing straight up



Picture 1

• **Insert from the side of the unit.**

• **Set the claw of the fan cover to the rib of the fan case.
(Refer to Page 2 for illustration)**

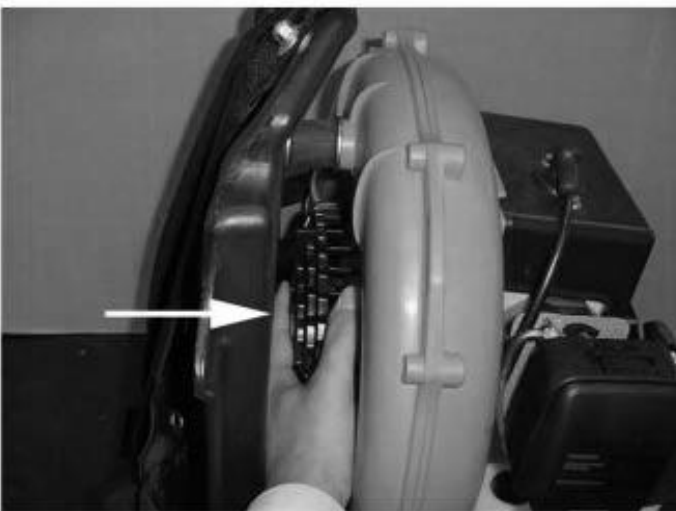

Picture 2

• **Push the fan cover against the fan case until a click is heard.**



Picture 3

• **After attaching, ensure that the fan cover is securely locked in place.**