





SERVICE 		4
		B9800016

SB, 365, Carburettor, 1998-06

To lock the choke shaft in closed position, a spring-loaded ball is mounted in the carburettor housing. This implies a new carburettor housing and a number of new parts. The carburettor is also given a new description.

Parts with description EPA only apply to carburettor C3M-EL8A. Previous carburettors can not be rebuilt to the later type of choke valve.

New Ref. No.	Description	Excl. Ref. No.	Remark
503 28 32-03	Carburettor C3M-EL2B	503 28 32-01	
503 28 32-04	Carburettor C3M-EL8A	503 28 32-02	EPA
503 94 23-01	Jet		EPA
503 94 24-01	Low speed needle		EPA
503 94 25-01	High speed needle		EPA
503 93 67-01	Lever	503 47 88-01	
537 01 27-01	Choke shaft	503 69 36-01	
537 01 23-01	Choke shaft and lever		
537 01 24-01	Spring, choke axle		
537 01 25-01	Ball		
537 01 26-01	Spring		

When changing complete carburettor, there is full interchangeability.

Introduced from serial number: 365 8200901

compl 503 28 32-02
 compl 503 28 32-04 EPA

Zama C3M-EL2B
Zama C3M-EL8A

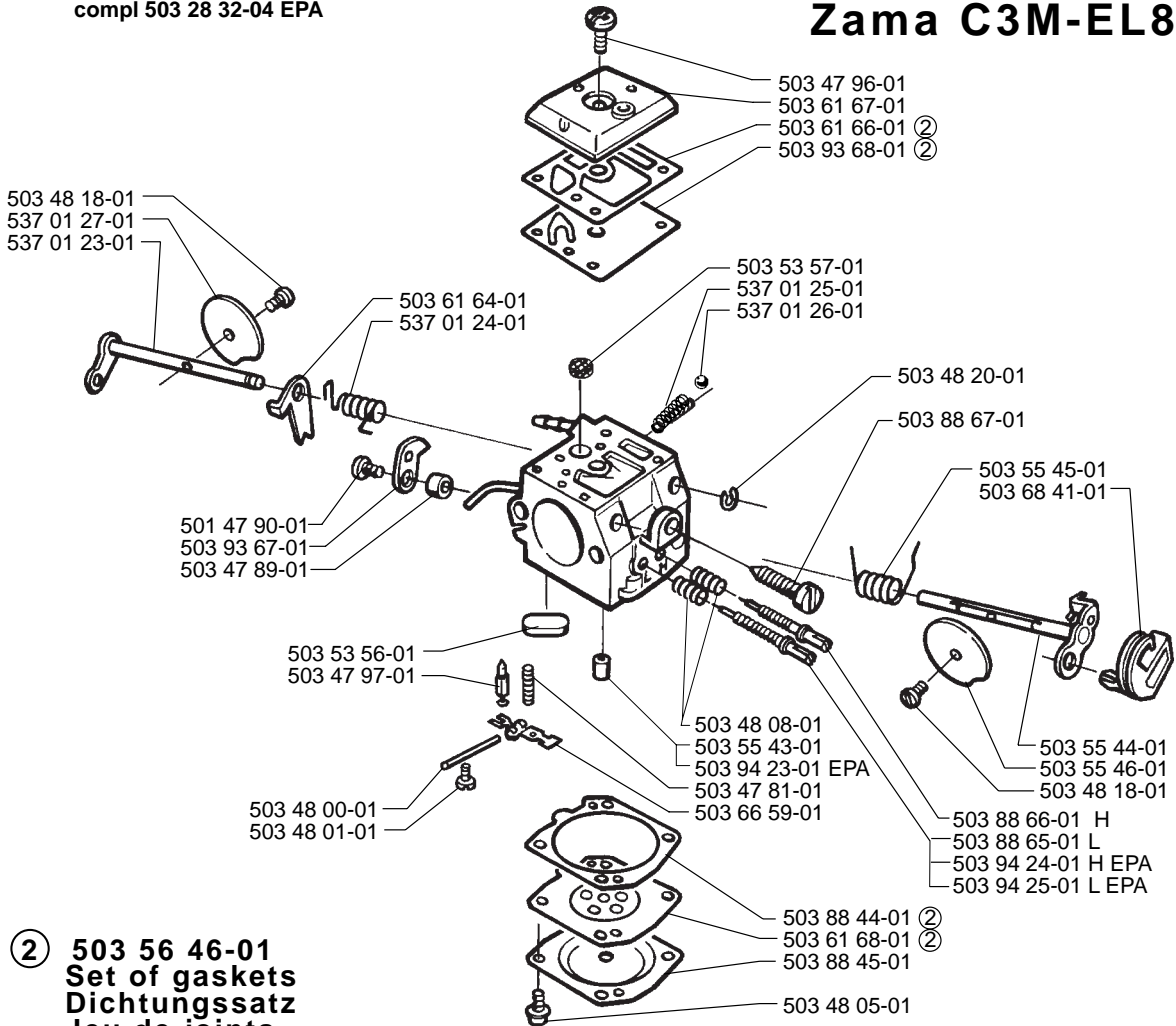

② **503 56 46-01**
Set of gaskets
Dichtungssatz
Jeu de joints
Juego de juntas
Packningssats