

Model 39/ 240/ 245 R/RX

New driver and new gear housing lid on the bevel gear. New compl. ref. no. on the bevel gear

The old turned driver is replaced by a moulded driver.

In order to maintain a good grass sealing the gear housing lid is also changed in order to fit the new driver. A steel washer is also added between the gear housing lid and the gear housing. The support flange and the nut have the same design as before. The new parts are marked with an "N" on the fig. 1. If driver or gear housing lid should be changed on an old bevel gear, the three new parts must be mounted i.e. driver, gear housing lid and washer. The old parts are excluded. On fig. 2 a cut is presented which shows the difference between an old and a new driver.

The new gear housing lid must, as the old one, be centred with a sleeve around the blade shaft.

For the old gear housing lid a sleeve with ref. no. 502 52 05-01 is used according to the service bulletin 10:X 92.145.

We introduce a new sleeve to the new gear housing lid because the centre hole in the gear housing lid is somewhat bigger.

The new sleeve will also fit the old gear housing lids. The sleeve is manufactured with a somewhat smaller diameter in one end for the old gear housing lids and larger in the other end for the new gear housing lids. Fig. 3.

The new combined sleeve has ref. no. 502 52 15-01

New Ref. No.	Description	Excl. Ref. No.	Remark
502 26 90-03	Bevel gear compl.	502 26 90-02	*
502 27 25-01	Driver	502 11 15-01	
502 27 26-01	Lid	502 11 14-01	
502 27 28-01	Washer		

* Introduced from serial number: 240/245R/RX 4140001

Fig. 1

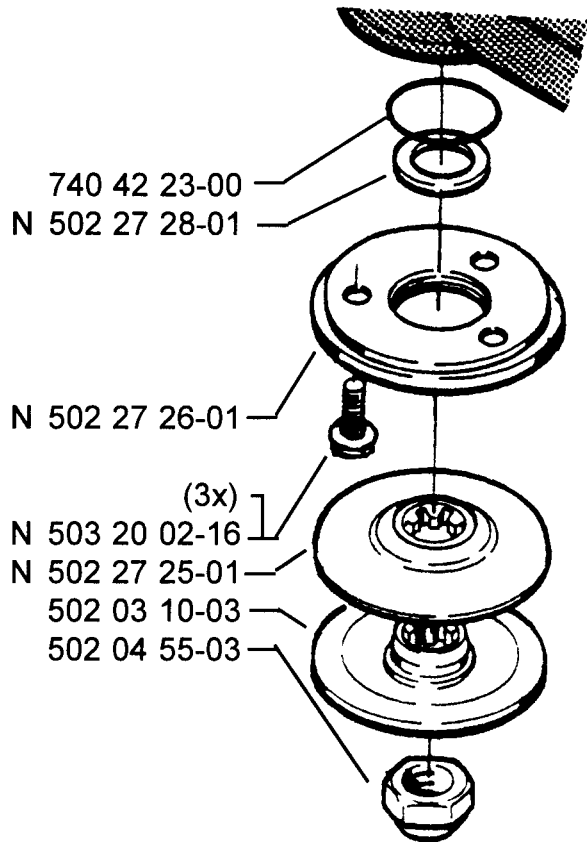

Fig. 2

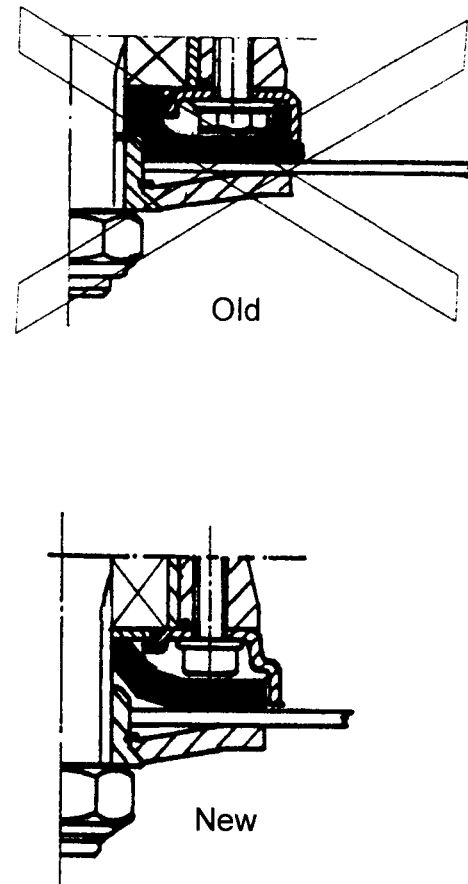
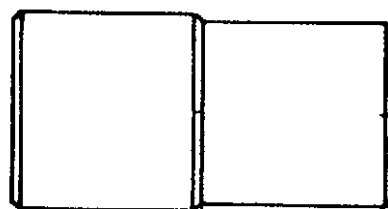

Fig. 3



502 52 15-01