



Service Bulletin	B0402003
	2004-02

Products: All LTH/ YTH/ & GTH Ride Mowers
with Serial Numbers Prior to 092203xxxxxxx

Subject: New Washer for Front Wheel Spindles

We have found that some original front wheel spindle washers on these units are too soft. This can cause the washer to become deformed due to rubbing from the clip ring and could eventually cause the clip ring to fall off.

A new hardened washer has been developed that solves this problem and was implemented into production on 9-22-03.

If you encounter this problem on units in the field or if you have unsold inventory of the affected tractors, please replace the original outermost washer (silver finish) on both the left and right sides with the new hardened washer (black finish). As a precautionary measure, you should also replace the clip rings. Warranty time allowed for this update is 18 minutes.

NOTE: Only the clip rings and the outermost washers need to be replaced, reuse the other washers. See the assembly diagram shown below for the type of tractor you are working on.

Part No.	Description
532 18 89-67	hardened washer
812 00 00-29	clip ring (E-clip)

LTH /YTH Models

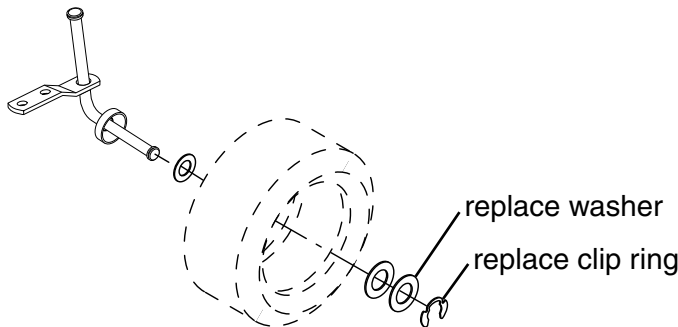

GTH Models

