



<b>Service Bulletin</b>	<b>B0302006</b>
	<b>2003-08</b>

**Products:** Royal 53S Walk Behind Mower  
(Serial Number 24600001 to 31000205)

**Subject:** Blade Attachment Kit

**Note:** This kit is required for mowers already put into service.  
If the mower is new and unused, kit # 531 30 01-41 should be used.

Due to a potential torque issue with the original blade bolt and washer, an update kit has been developed as part of a voluntary recall in association with the Consumer Products Safety Commission (CPSC).

The kit contains a new blade bolt, a new bushing (that was not used in the original design), a new style compression washer, a replacement blade, a replacement backside washer, a replacement blade spacer (with a modified machined surface) and a blade adapter. **All original parts removed during this update should be discarded and replaced with the new parts included in the kit.**

Carefully follow the steps on page two of this service bulletin to properly remove the original components and to reinstall the new components included with this kit.

Normal warranty procedures apply, completely fill out a regular warranty form for each unit updated and return the forms to Husqvarna. Time allotted to perform this repair is 24 minutes per mower.

Part No.	Description
*531 30 01-40	blade attachment kit

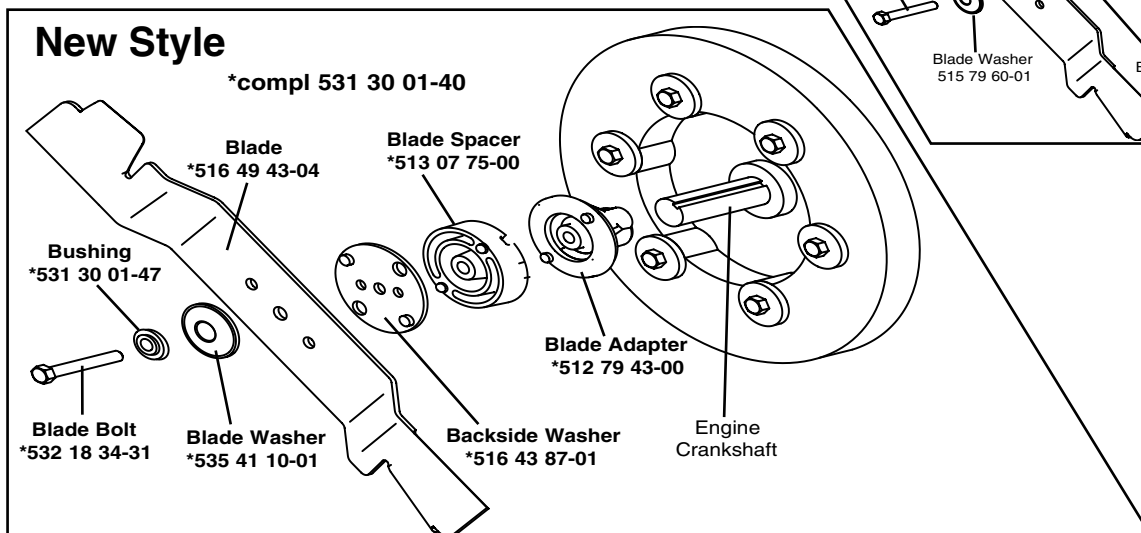
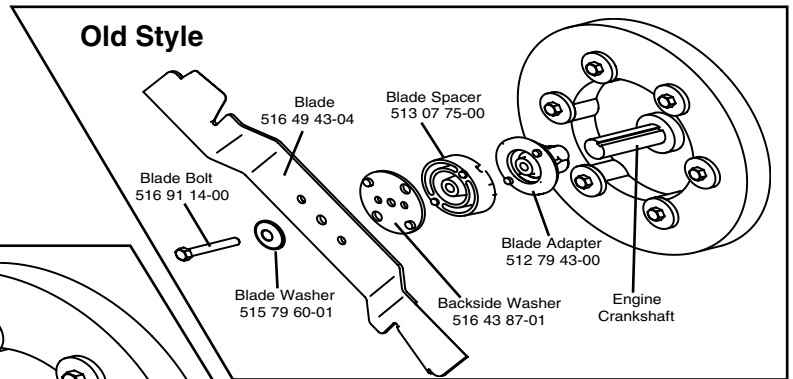



<b>Service Bulletin</b>	<b>B0302006</b>
	<b>2003-08</b>



**Warning:** Before performing any work, remove the spark plug to prevent engine from accidentally starting. When the engine is cold, drain the fuel into a suitable container to prevent leakage when the mower is tipped up. Always place the mower on its left hand side (with the air filter facing up) on a secure and level surface.

**Tools/ Materials Required**

- 1/2" ratchet wrench
- 9/16" or 14mm socket or box wrench
- torque wrench
- 2"x4" wood block
- wheel puller (if the blade adapter is difficult to remove)

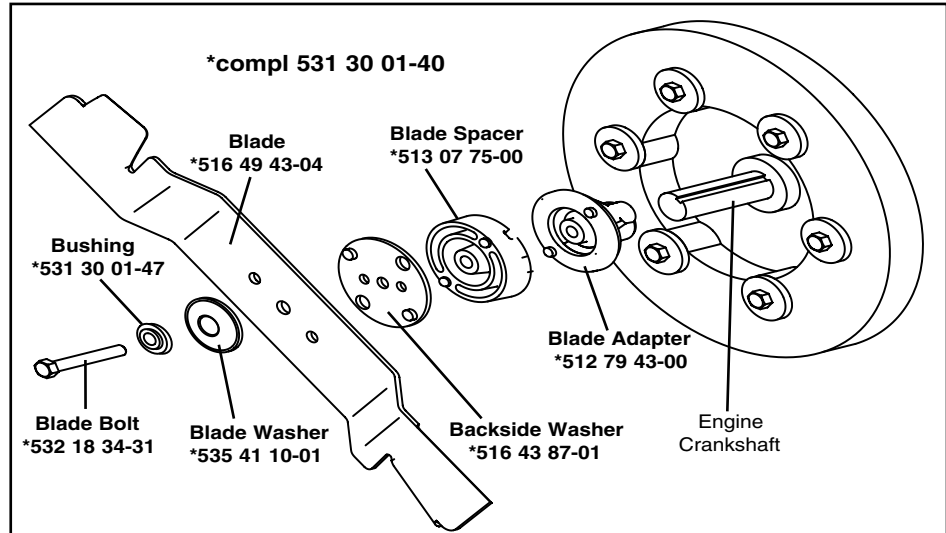

**Disassembly**

**Sharp edges can cause injury. USE GLOVES.**

1. Wedge the wood block in the deck to prevent blade movement during service. Using a 9/16" or 14mm socket or boxed end wrench, remove the blade bolt and old washer.
2. Remove the blade, the backside washer and the blade spacer.
3. Remove the blade adapter from the engine crankshaft.

**Note:** If the adaptor cannot be removed by hand, the adaptor may have been damaged. Use a wheel puller to remove the adaptor. Be careful not to damage the crankshaft during removal.

4. All original parts removed during this update should be discarded and replaced with the new parts included in this kit.

**Reassembly**

**Sharp edges can cause injury. USE GLOVES.**

1. Attach the adaptor to the crankshaft, ensuring the key in the adaptor (A2) is aligned to the groove in the crankshaft (A1). Be sure it is fully seated.
2. Place the blade spacer onto the blade adaptor ensuring the pegs on the blade adaptor (A3) fit into the location slots in the blade spacer (A4).
3. Place the backside washer onto the blade spacer ensuring the pegs in the blade spacer (A5) fit into the holes in the backside washer (A6).
4. Place the blade onto the backside washer ensuring the pegs on the backside washer (A7) fit into the holes in the blade (A8). Be sure to install the blade as shown in the illustration. The side with stamped lettering will face up, toward the engine.
5. Place the new blade bolt through the new bushing (not used in the original design) and the blade washer, then insert the bolt through the center hole in the blade.

**Note:** It's important to ensure that the washer is installed with the concave side facing the blade (B1).

6. Again, use the wood block to prevent blade movement and tighten the blade bolt to a torque of 45-50 Nm (33-36 ft. lbs.). The washer will flatten against the blade as shown in diagram C1, but do not stop tightening when the washer is flat.

**Note:** It is critical that the blade bolt is tightened to the correct torque of 45-50 Nm (33-36 ft. lbs.), do not estimate.

