



<b>Service Bulletin</b>	<b>B0302002</b>
	<b>2003-06</b>

---

**Products:**           **55B21HV**  
                              **55R21HV**

**Subject:**           **Pinion/ Pawl Drive Control and Wheel Repair Kit**

---

A repair kit has been developed to assist with drive issues for the model 55B21HV and the 55R21HV. Before installing this kit, it is recommended to perform the troubleshooting recommendations found in the previous service bulletin (B0302001) to determine if this kit is necessary.

If problems do persist on these two models after performing the recommended troubleshooting, order and install kit # 532 18 82-51. This kit will contain a new drive assembly with a longer cable and a softer spring. This new cable design results in a "softer" engagement and also solves the "difficult to pull back" problem.

In addition, O-rings and washers are also included in the kit to replace the current wave washers. This reduces the axial clearance between the wheels and axles.

A detailed instruction sheet is also included in the kit to assist with the installation.

Kits are available free of charge and normal warranty procedures apply.

<b>Part No.</b>	<b>Description</b>
532 18 82-51	Drive Control & Wheel Repair Kit

## HI-VAC DRIVE CONTROL AND WHEEL REPAIR KIT NO. 188251

### Kit Contains:

	Part No.
(1) Drive Control Assembly	532185312
(3) Wire Ties	532066426
(1) Decal - Drive Control	532187356
(4) O-Rings	532188152
(4) Flat Washers	532088348

### DRIVE CONTROL REWORK INSTRUCTIONS

1. Remove screws retaining drive cover and remove drive cover from lawn mower housing.

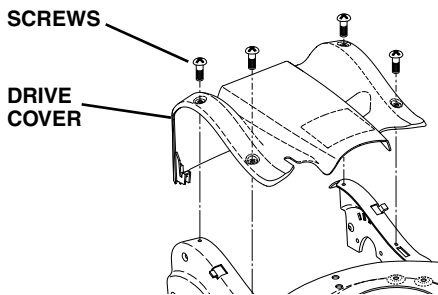

**NOTE:** Observe routing of drive control cable for routing of new drive control.

2. Remove drive cable from anchor by pinching the ears of the fitting to allow cable to be pulled away from anchor.
3. Unhook the spring from the idler arm assembly.

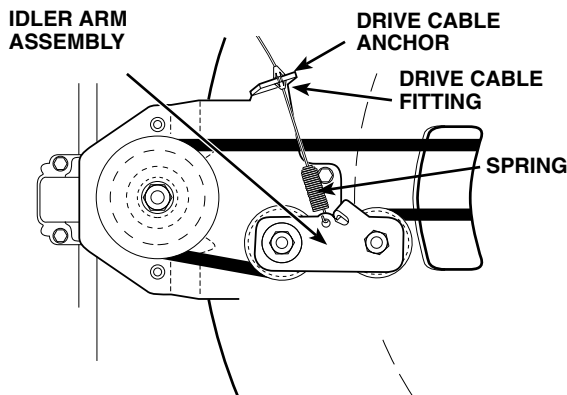

4. Remove (cut) wire ties securing drive cable to handles. **NOTE:** Observe routing of cable.
5. On the bottom side of control, remove the cap from control. Keep cap for reassembly to new control.

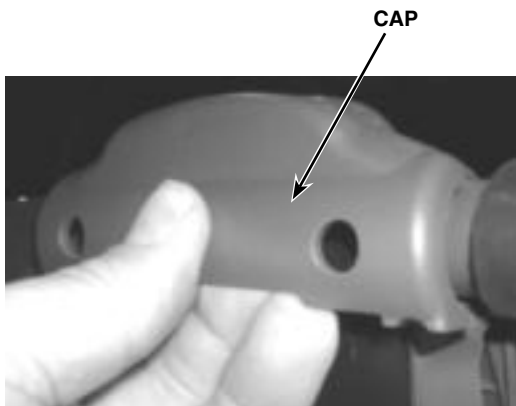

6. Remove the five (5) T-20 Torx screws securing the metal bottom cover to upper handle and control.
7. Install the metal bottom cover to the new drive control and upper handle with the same five (5) screws and tighten securely.

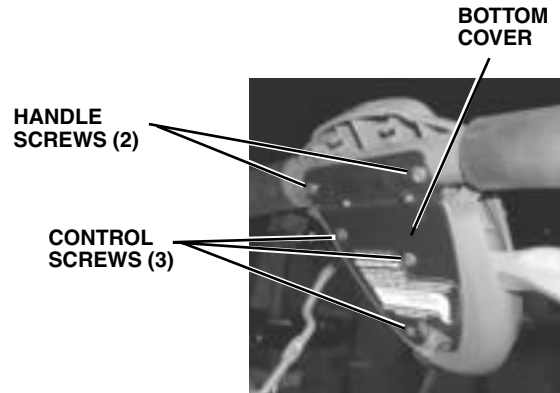

8. Reinstall the cap to the new control.
9. Route cable down to the rear of mower and hook the spring onto the idler arm assembly.
10. Position cable in anchor and push the fitting into the hole to secure.
11. Secure cable to handles with wire ties provided.
12. Apply new decal provided to top of drive control.

### WHEEL REWORK INSTRUCTIONS

Perform the following steps to all four wheels on the mower.

1. Remove hub cap and nut securing wheel and slide wheel off the axle pin.
2. Remove the two (2) wave washers from axle pin and discard.
3. Slide one (1) O-ring all the way on to the base of the axle.
4. Slide one (1) flat washer on to the axle up against the O-ring.
5. Install wheel, nut and hub cap. Be sure nut is tightened securely.
6. Repeat procedure for all the wheels.

