



Service Bulletin	B0201901
	2002-05

Models 41" Mulch Decks (Bioclip 103) used
Involved: on Rider 16 / Rider 15 / Rider Proflex 21

Subject: Blade Components and Blade Bolt Torque

It has come to our attention that there is an opportunity for confusion when servicing the 41" mulching deck, also know as a Bioclip 103 deck. Some deck components were redesigned between the production of the 2000 and 2001 model years.

When servicing the 41" mulch deck, please be aware of which type you are working on and use the correct parts list to order replacement parts.

The area that could cause the most confusion involves the shear pins and the tension washer (belleville washer) that support the blades. The following photo shows these components, but they are not the only changes that have been made to the deck. Page two and three of this bulletin show the complete deck assemblies for comparison.

In addition, it is recommended that the blade bolts be torqued to 45-50 Nm (35 ft/lbs.) during blade repair or replacement. Also be sure to use new tension washers and shear pins when servicing the blades. Used washers have been under torque and have lost their tension. So if they are reused when changing the blades, they will slip more easily and break shear pins. You should also use new shear pins, in case they have been weakened.

2001 and Newer
41" Mulch
(Bio 103)



*Blade Assembly
531 00 75-85

Tension Washer
535 41 10-01
(13/16" I.D. x 2 5/16" O.D.)

Shear Pin
535 41 09-01

2000 - 2001
41" Mulch
(Bio 103)



*Blade Assembly
531 00 75-24

Tension Washer
506 96 64-01
(1" I.D. x 1 15/16" O.D.)

Shear Pin
506 96 62-01

*Blade assemblies contain blade, tension washer and shear pin.



Service Bulletin	B0201901
	2002-05

**2000-2001
41" Mulch Deck
(BioClip 103)**

*compl 506 75 11-07 (a)
*compl 506 75 11-06 (b)

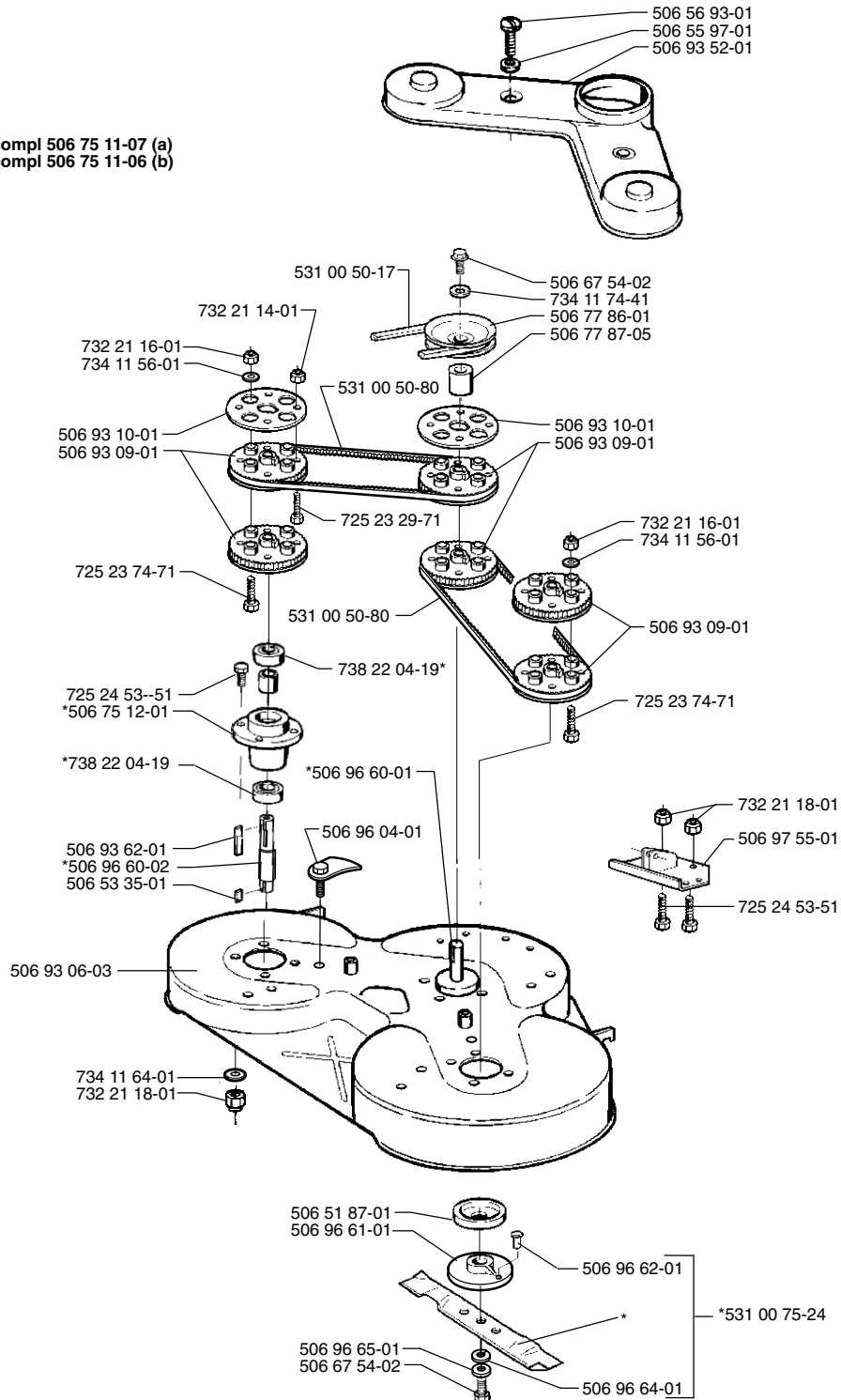

(a) = Yttre. Outer. Exterior. usser . Ulko.
(b) = Mitten. Center. Centre. Zentrum. Keski.

XXX XX XX-XX = New part



Service Bulletin	B0201901
	2002-05

**2001 and Newer
41" Mulch Deck
(BioClip 103)**

