

HIGH ALTITUDE JETS
 257207 ABOVE 3,000 FT. (#46)
 257208 ABOVE 6,000 FT. (#42)

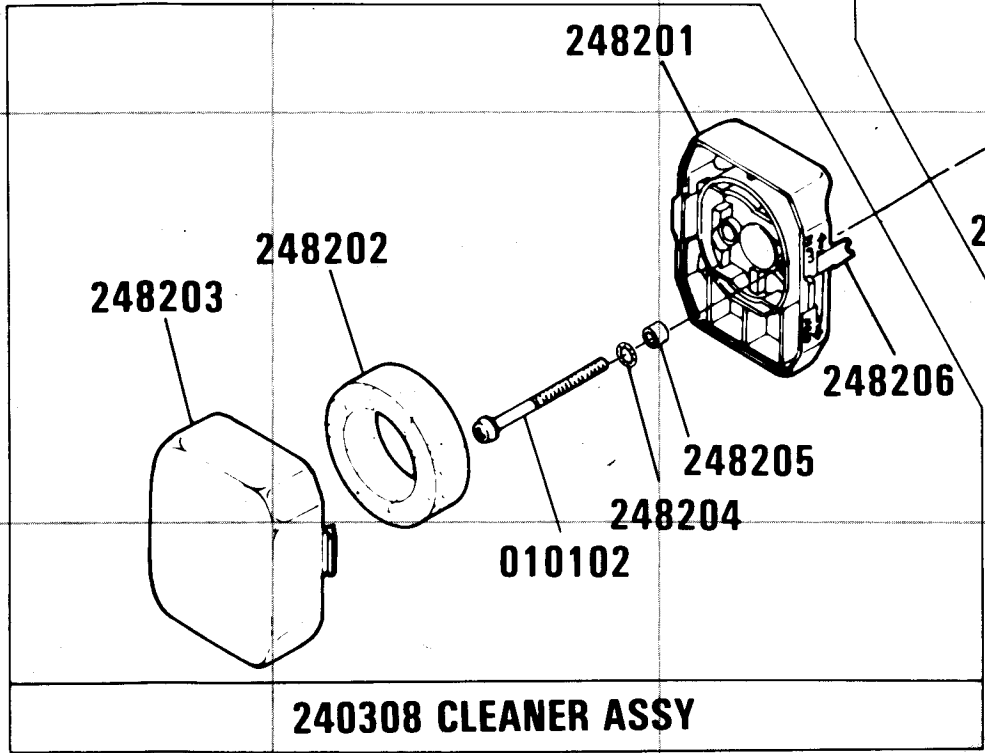

**FOLD PAGE OUT FOR
 ENGINE AND DRIVE SHAFT**

**240604
 CARB KIT**

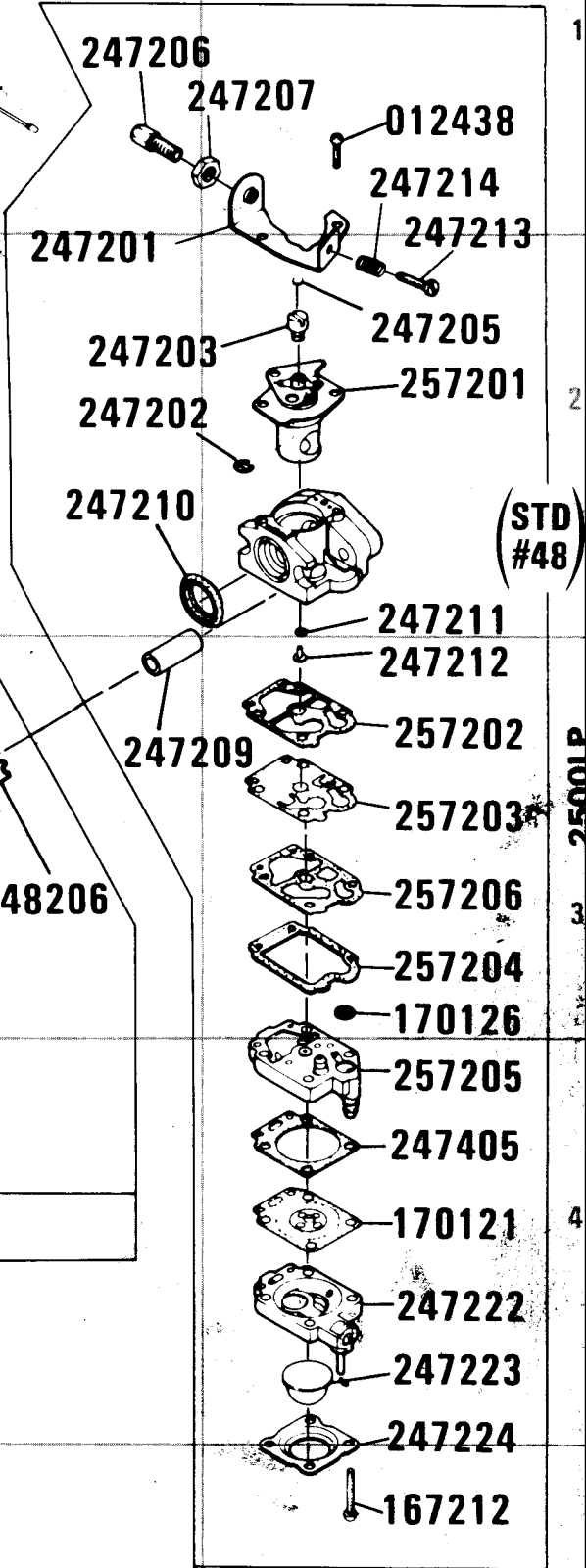

**240315
 CARB ASSY**



20710 ALAMEDA ST., LONG BEACH, CALIFORNIA 90810 • (213) 603-9888 • TELEX 96396

The Green Machine MODEL 2500LP

www.mymowerparts.com

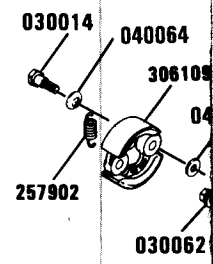
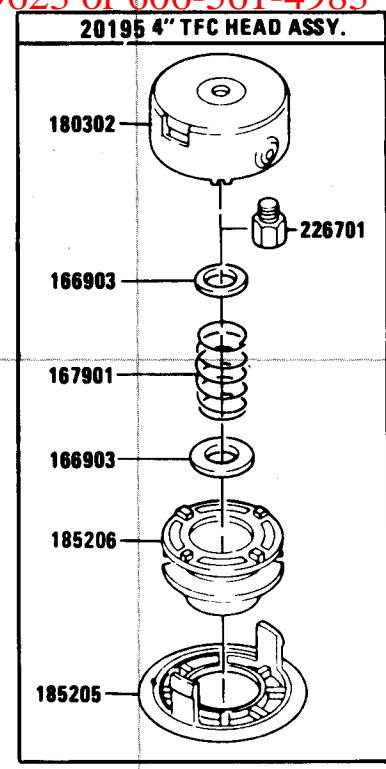
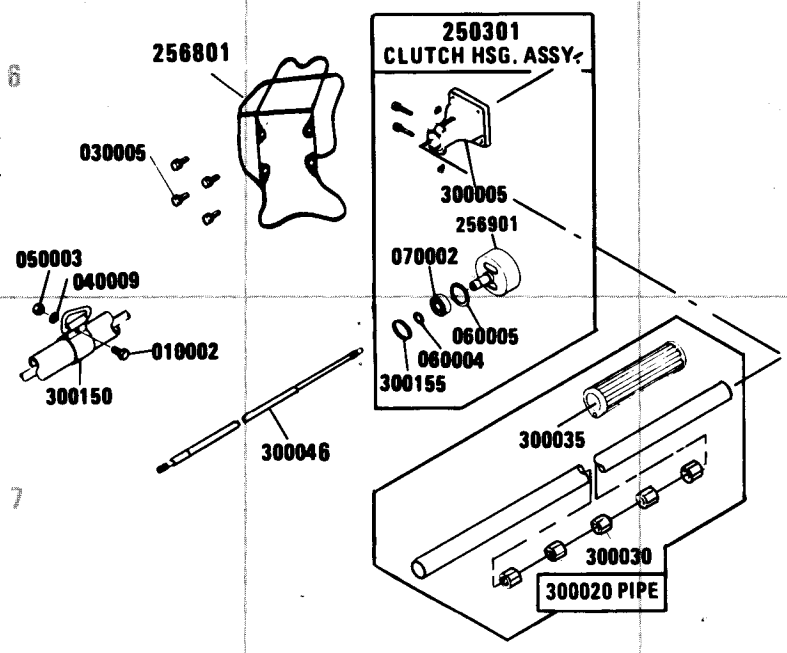

- 31005 1 LB 0.080 LINE
- 31004 3 LB 0.080 LINE
- 32007 SPOOL W/.080 LINE

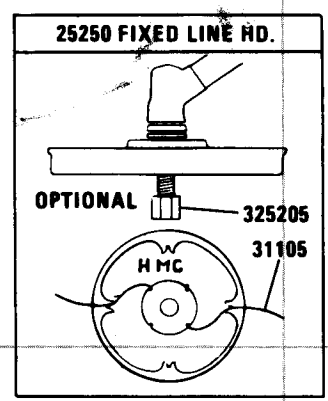
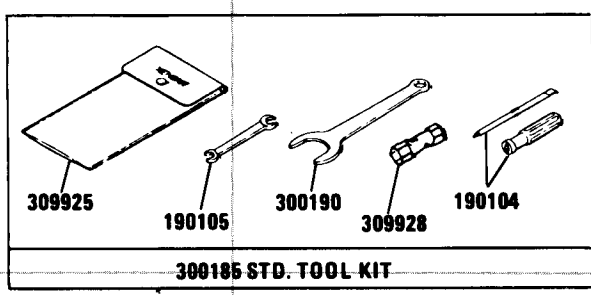
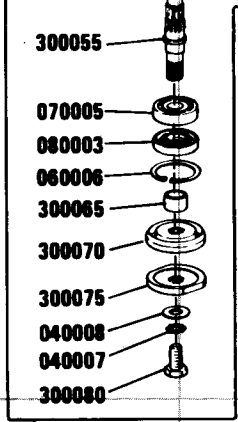
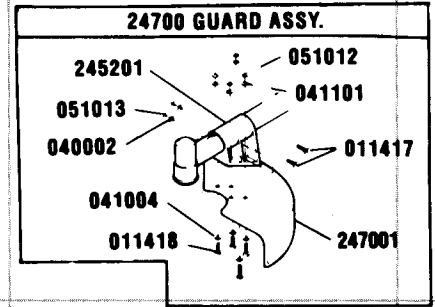
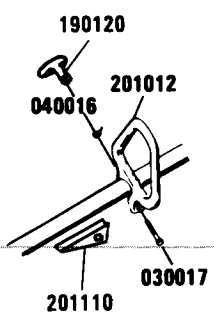
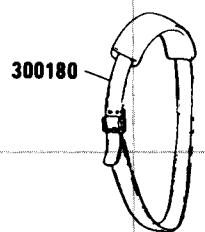
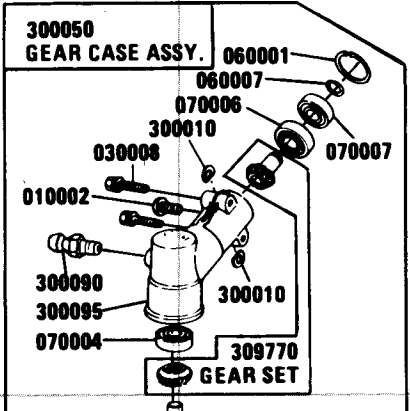

BLADE GUARD MUST BE INSTALLED WHENEVER METAL BLADES ARE USED

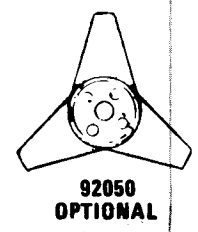
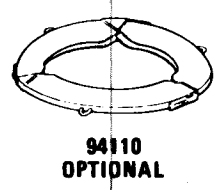
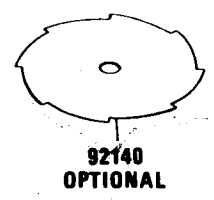
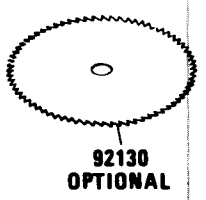

240312 MAGNETO ASSY
240602 GASKET SET
240204 SHORT BLOCK

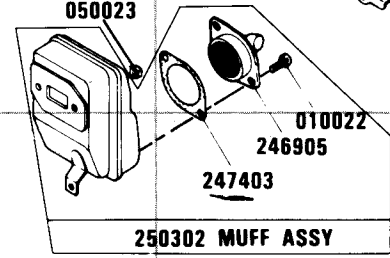
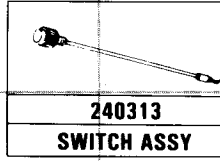
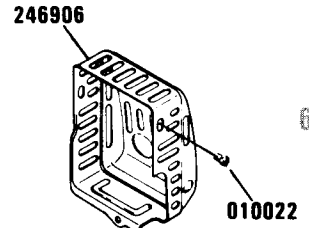
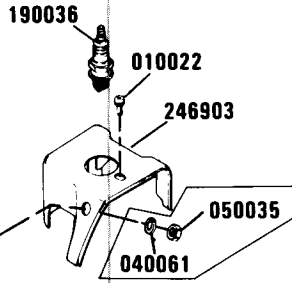

240313
SWITCH ASSY

250302 MUFF ASSY

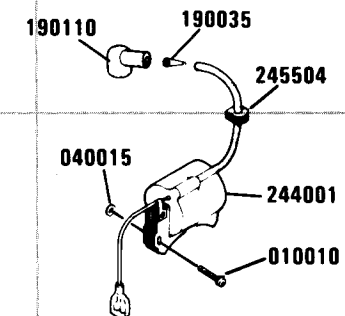
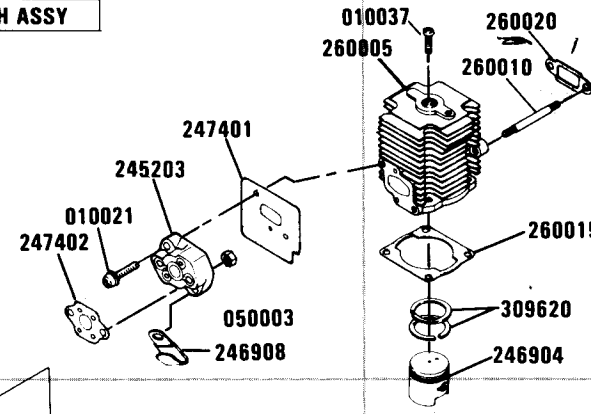
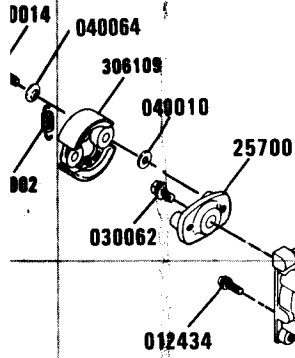

2
01
011417
47001

240316
CRANKCASE SET

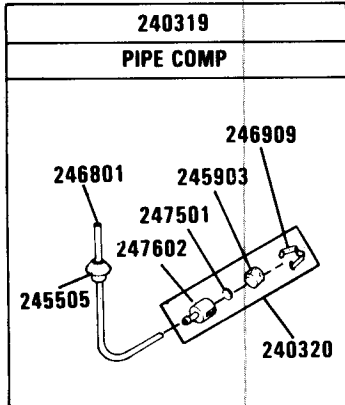
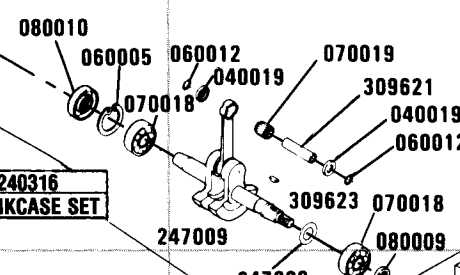

ND.
-325205
31105

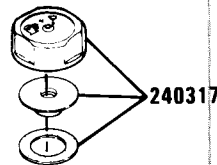

250304
TANK ASSY

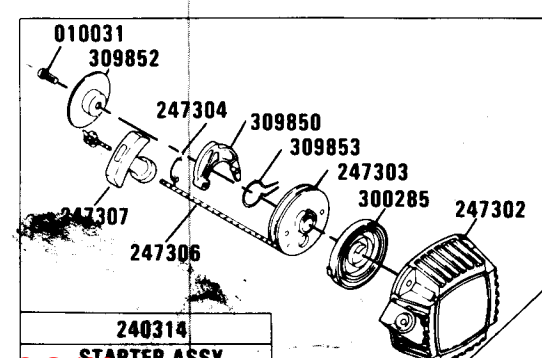
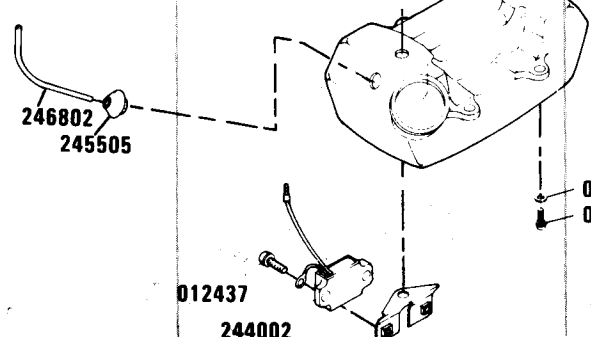
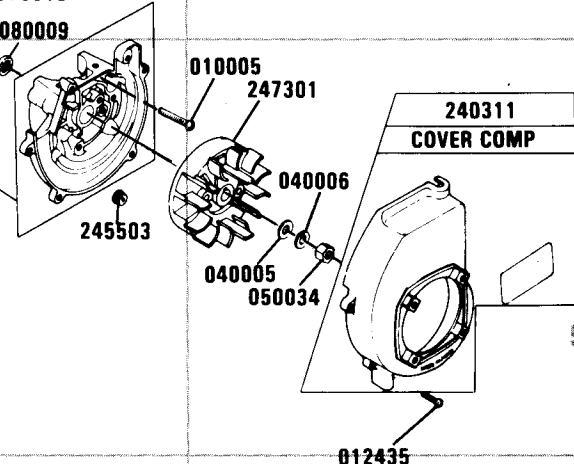

240314
STARTER ASSY

MODEL 2500LP NUMERICAL PARTS LIST

PART #	LOC	DESCRIPTION	PART #	LOC	DESCRIPTION	PART #	LOC	DESCRIPTION
20195	G-6	4" TFC CUTTING HEAD	190120	G-8	KNOB	257204	D-3	GASKET
24700	H-8	BLADE GUARD	201012	G-8	HANDLE	257205	D-4	PUMP BODY
25250	H-9	FIXED LINE HEAD	201110	G-9	SUPPORT	257206	D-3	GASKET
31004	F-8	3 LB. SPOOL .080 LINE	226701	H-6	ARBOR BOLT	257902	H-7	CLUTCH SPRING
31005	F-7	1 LB. BOX .080 LINE	240204	I-6	SHORT BLOCK	257207	A-2	HIGH ALTITUDE JET
31105	H-9	15 EA. 20" STRIPS .105 LINE	240308	B-4	AIR CLEANER ASSY.	257208	A-2	HIGH ALTITUDE JET
32007	F-8	.080 LINE ON SPOOL	240311	L-9	COVER COMP.	260005	K-7	CYLINDER
92050	H-10	FLEXIBLE TRI BLADE	240312	I-6	MAGNETO ASSY.	260010	K-7	MUFF. STUD
92130	E-10	9" SAW BLADE	240313	J-7	SWITCH ASSY.	260015	K-7	CYL. GSKT.
92140	F-10	8 TOOTH BRUSH BLADE	240314	K-10	STARTER ASSY.	260020	K-7	MUFF. GASKET
92180	G-10	4 TOOTH BRUSH BLADE	240315	D-5	CARB. ASSY.	260040	J-8	GASKET, CRANKCASE
94110	G-10	BLADE COVER	240316	J-8	CRANKCASE	300005	F-6	CLUTCH HSG.
010002	E-7 & E-8	SCREW	240317	J-9	FUEL CAP	300010	E-8 & F-8	SHIM
010005	L-9	SCREW	240319	I-9	PIPE COMP.	300020	F-7	PIPE ASSY.
010010	L-8	SCREW	240320	J-9	FILTER ASSY.	300030	F-7	BUSHING
010021	J-7	SCREW	240602	I-6	GASKET SET	300035	F-7	GRIP
010022	K-6 & L-6	SCREW	244001	L-8	COIL	300046	F-7	DRIVE SHAFT
010031	K-10	SCREW	244002	J-10	UNIT	300050	E-8	GEARCASE ASSY.
010037	K-7 & K-10	SCREW	245201	H-8	BRACKET	300055	E-9	GEAR SHAFT
010102	B-4	SCREW	245203	J-7	INSULATOR	300065	E-9	COLLAR
011417	H-8	SCREW	245503	K-9	PLUG	300070	E-9	HOLDER (A)
011418	H-8	SCREW	245504	L-7	GROMMET	300075	E-9	HOLDER (B)
012434	I-8	SCREW	245505	I-9	GROMMET	300080	E-9	BOLT L.H.
012435	L-9	SCREW	245903	I-9	FILTER	300090	E-8	ZERK FITTING
012437	J-10	SCREW	246801	I-9	FUEL PIPE	300095	E-8	GEARCASE
012438	D-1	SCREW	246802	I-10	FUEL PIPE	300150	E-7	HANGER
030005	E-6	BOLT	246903	K-6	CYL. COVER	300155	F-7	THRUST WASHER
030008	E-8	BOLT	246904	K-7	PISTON	300180	F-8	HARNESS
030014	H-7	BOLT	246905	L-7	SPARK ARRESTOR	300185	F-9	TOOL KIT
030017	G-9	BOLT	246906	L-6	MUFF. COVER	300190	G-9	SPANNER
030062	I-7	BOLT	246907	J-10	BRACKET	300285	L-10	SPRING, STARTER
040002	H-8	WASHER	246908	J-7	CLIP	306109	I-7	CLUTCH SHOE
040005	L-9	WASHER	246909	J-9	CLIP	309620	K-7	PISTON RING
040006	L-9	WASHER	247001	H-8	GUARD	309621	K-8	PISTON PIN
040007	E-9	WASHER	247008	K-9	SHIM	309623	K-8	KEY
040008	E-9	WASHER	247009	K-8	CRANKSHAFT	309770	F-8	GEAR SET
040009	E-6	WASHER	247201	C-2	BRACKET	309850	L-10	DOG
040010	I-7	WASHER	247202	C-2	CLIP	309852	K-10	PLATE
040015	L-8	WASHER	247203	C-2	SWIVEL	309853	L-10	SPRING, FRICTION
040016	G-8	WASHER	247205	D-2	PLUG	309925	F-9	TOOL POUCH
040019	K-8	WASHER	247206	C-1	CABLE ADJUSTER	309928	G-9	SOCKET
040031	K-10	WASHER	247207	D-1	NUT	325205	H-9	ARBOR BOLT
040061	K-6	WASHER	247209	C-3	SLEEVE			
041004	H-8	WASHER	247210	C-2	PACKING			
041101	H-8	WASHER	247211	D-2	RING			
050003	E-6 & J-7	NUT	247212	D-3	MAIN JET			
050023	K-6	NUT	247213	D-1	SCREW, IDLE ADJ.			
050034	L-9	NUT	247214	D-1	SPRING, IDLE ADJ.			
050035	K-6	NUT	247222	D-4	PUMP BODY			
051012	H-8	NUT	247223	D-4	PRIMER PUMP			
051013	H-8	NUT	247224	D-4	COVER			
060001	F-8	RING	247301	L-9	FLYWHEEL			
060004	F-7	RING	247302	L-10	STARTER HSG.			
060005	F-7 & J-8	RING	247303	L-10	SPOOL, ROPE			
060006	E-9	RING	247304	K-10	SPRING			
060007	F-8	RING	247306	K-10	ROPE			
060012	K-8	RING	247307	K-10	KNOB			
070002	F-6	BEARING	247401	J-7	GASKET			
070004	E-8	BEARING	247402	J-7	GASKET			
070005	E-9	BEARING	247403	L-7	GASKET			
070006	F-8	BEARING	247405	D-4	GASKET			
070007	F-8	BEARING	247501	I-9	VALVE			
070018	J-8	BEARING	247602	I-9	FUEL WEIGHT			
070019	K-8	BEARING	248201	B-2	CLEANER BODY			
080003	E-9	SEAL	248202	B-3	ELEMENT			
080009	K-8	SEAL	248203	A-3	CLEANER COVER			
080010	J-8	SEAL	248204	B-3, B-4	SPRING			
166903	G-6, G-7	SPRING PLATE	248205	C-3	SLEEVE			
167212	D-5	SCREW	248206	C-3	CHOKE LEVER			
167901	G-7	SPRING	250301	F-6	CLUTCH HSG. ASSY.			
170121	D-4	DIAPHRAGM	250302	L-7	MUFF. ASSY.			
170126	D-3	FILTER SCREEN	250304	K-9	TANK ASSY.			
180302	G-6	4" HEAD BODY	256101	I-7	HOUSING, CLUTCH			
185206	G-7	4" SPOOL	256801	E-6	ENGINE STAND			
186205	G-7	4" HEAD CAP	256901	F-6	CLUTCH DRUM			
190035	L-7	SPRING	257001	I-7	ADAPTOR			
190036	J-6	SPARK PLUG (NGK BM7A)	257101	C-1	THROTTLE CABLE			
190104	G-9	DRIVER	257201	D-2	THROTTLE VALVE			
190105	F-9	SPANNER	257202	D-3	GASKET			
190110	L-7	CAP	257203	D-3	DIAPHRAGM			