

2861 UT-26308
Power Blower Attachment

Page 1 of 2

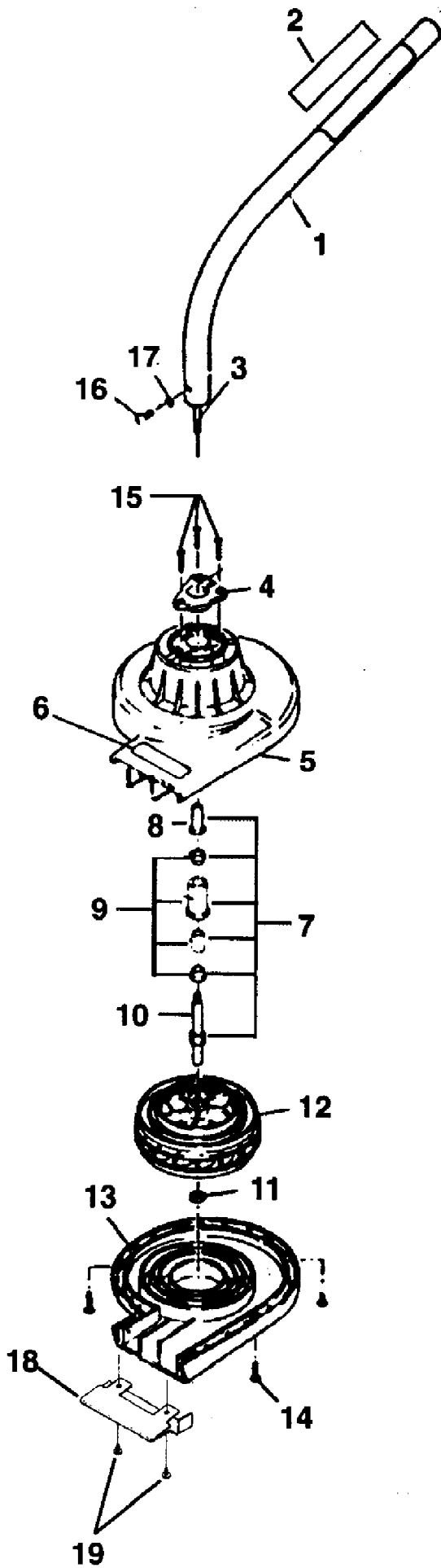

2861 UT-26308
Power Blower Attachment

Page 2 of 2

Ref #	Part Number	Qty	S/P/F	Description
1	A07929	1	S	TUBE ASSY
2	02985	1	S	LABEL, WARNING
3	A07844	1	/P	FLEX CABLE
4	GM235205	1	/P	CLAMP
5	07838	1	/P	UPPER HOUSING
6	07917	1		LABEL, MODEL
7	A07933A	1	S	ARBOR ASSY. (SNAP RING TYPE)
8	GM166501	1	/P	ARBOR ADAPTER
9	GM160305	1	S	ARBOR BUSHING ASSY.
10	08467	1	/P	ARBOR SHAFT (SNAP RING TYPE)
11	08468	1	/P	SNAP RING
12	GM235203	1	/P	IMPELLER
	GM167602	1		PAL NUT (USED 6/96 & PRIOR)
13	07839	1	/P	LOWER HOUSING
14	GM201044	5	S	SCREW Torque Specs: 35-45 In/Lbs; 4-5 Nm
15	GM011102	3	S	SCREW Torque Specs: 35-45 In/Lbs; 4-5 Nm
16	GM011401	1	/P	SCREW Torque Specs: 35-45 In/Lbs; 4-5 Nm
17	GM041101	1	/P	LOCK WASHER
18	GM286903	1	/P	GUARD, LOWER HOUSING
19	GM011108	2		SCREW Torque Specs: 5-20 In/Lbs; .5-2.3 Nm