



DIXIE CHOPPER
The World's Fastest Lawn Mower



Model # _____

Serial # _____

Date Purchased _____

2008 Vortex Installation/Owner's Manual

About This Manual



AUTHORIZED DEALER

This owner's manual is considered a permanent part of the accessory. It must be available to all of the operators and/or person(s) servicing the accessory. Should the accessory be resold, this manual must remain with the accessory.

All information, illustrations, and specifications contained in this manual were in effect at the time of publication. Dixie Chopper reserves the right to change, modify, and/or discontinue specifications and/or design without notice. If there is a change that has been made to your accessory which is not shown or reflected in this manual, please see your authorized Dixie Chopper Mower dealer before operating and/or servicing the equipment.

Congratulations on the purchase of your new Dixie Chopper mower accessory. We at Dixie Chopper are confident that this accessory will provide you with years of excellent performance, durability, and trouble free service when operated and maintained as directed in this manual.

Should you ever have any questions regarding the operation, maintenance, or safety of your accessory, please contact your authorized Dixie Chopper Mower dealer who has been specially trained on operation and service of Dixie Chopper Mower Accessories.

A space has been provided on the cover and below to record information about your new Dixie Chopper Mower Accessory. Please take time to record such information for future reference, especially when you contact an authorized Dixie Chopper Mower dealer with questions.

Date Purchased:	_____
Model Number:	_____
Serial Number:	_____
Purchased From:	_____

TABLE OF CONTENTS

Warranty Policies	2
Safety Information	3
Safety Precautions	4
Safety Decals	6
Kit Components	7
Blower Installation	12
Silver Eagle Hopper Installation	15
Standard Hopper Installation	16
Propane Hopper Installation	16
F2/F4/F5 Pre-Installation	17
F2/F4/F5 Hopper Installation	17
F4/F5 Door Linkage Adjustment	18
Counter Weight Installation	18
Diesel Hopper Installation	19

Warranty Policies

There are no understandings, agreements, representations, or warranties expressed or implied (including but not limited to any regarding the merchantability or fitness for a particular purpose), not specified herein, regarding the equipment which is the subject of this warranty.

Owner/Operator Knowledge Responsibility

As a condition of the Dixie Chopper warranty, the owner and operator(s) are fully responsible for having read, and reasonably understood the proper operation and care of the Dixie Chopper Bagger unit ***before attempting to operate the machine.***

Through the terms and conditions contained herein, Magic Circle Corporation, a.k.a. Dixie Chopper, warrants that it will adjust, repair, or replace any factory original part used in the manufacturing of a Dixie Chopper Bagger unit, found to be defective in material or workmanship.

Bagger Accessory

The warranty period is limited to one year from the date of retail purchase on behalf of the original owner of a Dixie Chopper bagger unit. This warranty will provide the cost of repair or replacement (at the discretion of Dixie Chopper) of the defective part, including labor.

Hose, Bags, and Belts

Hose, bags, and belts are considered to be consumable wear items, and are therefore warranted for an initial period of 90 days against materials or workmanship defects, not for wear or abuse.

Transportation for Warranty Repairs

A Dixie Chopper Bagger unit (including any defective part(s) requiring warranty repair, must be returned to an authorized Dixie Chopper Service Dealer within the warranty period. The expense of transporting the unit to and from the dealer for warranty work will be the responsibility of the unit owner.

Limitation of Warranty

The Product Registration/Dealer Delivery Certification must be mailed to Dixie Chopper within three days of the original retail purchase date to enable accurate validation of the warranty period provided. Proof of purchase may be required (invoice & copy of product registration) from the unit owner to substantiate any warranty claim..

All warranty work must be performed by an authorized Dixie Chopper Servicing Dealer, using only Dixie Chopper OEM parts. This warranty covers only Dixie Chopper Baggger units that are registered with the factory when purchased new, properly maintained, and operated under conditions considered normal for commercial turf equipment.

SAFETY INFORMATION

Read This Manual Carefully And Thoroughly Before Operating The Mower!

Training

1. Carefully and thoroughly read the owner's manual. Allow adequate time to fully understand the controls and operation of the equipment.
2. Never allow anyone to operate the mower that has not read and fully understood the owner's manual.
3. Do not carry passengers. Avoid mowing while people, especially children and pets are nearby, since rotating blades can throw rocks and other items with enough force to cause serious injury.

Before Use of Equipment

Operator:

Wear protective clothing while mowing. Long trousers and safety glasses will help reduce the risk of injury from thrown objects. It is recommended that steel toe shoes with aggressive soles or some other type of substantial footwear be worn to help protect your feet and maintain traction on slopes or uneven ground. Always wear hearing protection.

Mowing Area:

Thoroughly inspect the area where the equipment is to be used. Look for items such as stones, sticks, wire and other foreign objects. When struck by the mower, these and other objects may become projectiles that could lead to serious injury and/or death.

Mower:

For your safety and the long life of your mower, always inspect the mower before each use. Before inspection, make sure it is on a flat and level surface, the blades are disengaged, the ignition switch off with the key removed, and the spark plug wire is off of the spark plugs.

General Condition:

- Walk around the mower looking for any fluid spills or leaks on or underneath the mower. Remove any and all excessive debris, dirt, and/or fluids.
- Look for signs of damage or excessive wear. Check the tightness of all nuts, bolts, pins, and screws. Tighten any that may be loose and replace any that may have been lost during use.
- Be sure the safety interlock seat switch is operating properly so that the engine can not be started unless the operator is in the seat with the blades disengaged.
- Check the mower blades for any damage or abnormal wear and replace in sets so that they are balanced.
- Check the tire pressure on all four tires.
- Check all belts for proper wear and correct tension.
- Check engine oil and air filters as recommended in the engine manufacturers' operators manual.

GENERAL SAFETY PRECAUTIONS

1. Never allow individuals who have not read this Operator Manual to operate the mower.
2. Never allow children to operate mower. This mower is intended for adult use only.
3. Never operate the mower when barefoot or when wearing open sandals.
4. Thoroughly clear the work area of objects (wire, stones, sticks, bones, etc.) which may damage the mower or cause personal injury to the operator, bystanders, or other property.
5. Before attempting to start the engine, engage parking brake, disengage the deck and all attachment clutches and position the steering levers into the neutral lock position.
6. Give complete, undivided attention to the job at hand.
7. Whenever the deck is engaged, NEVER direct the discharge of material toward bystanders nor allow anyone near the mower while in operation.
8. Whenever possible, avoid operating the mower in wet grass.
9. Mow only in well lit areas.
10. Use EXTREME CAUTION when mowing and/or turning on hill sides.
11. Reduce speed and exercise EXTREME CAUTION on slopes to prevent tipping over or loss of control.
12. Never operate mower on slopes exceeding 15 degrees.
13. To avoid tipping over, avoid sudden motion when mowing uphill.
14. When mowing downhill, loss of traction may occur. Weight transfer to the front wheels may cause drive wheels to slip and result in loss of control. To help re-gain control, increase ground speed and gradually turn left or right followed by a decrease in ground speed to regain directional control.
15. Do not mow slopes when grass is wet.
16. Be especially cautious when changing direction on slopes.
17. Stay alert for holes, rocks and roots in the terrain, which may cause the mower to upset.
18. Keep away from drop-offs.
19. Do not operate the mower near any body of water, (lakes, ponds, riverbanks, etc.).
20. When backing up, make sure the area behind you is clear. Dixie Chopper's zero turning radius nearly eliminates the need for backing up. Simply turn the mower around within its own dimension and proceed forward.
21. Disengage power to attachments, set parking brake, and stop engine before leaving the operator position.
22. Disengage power to attachments, set parking brake, and stop engine before making any adjustments.
23. Disengage power to deck and other attachments when the mower is being transported or not in use.
24. Take all possible precautions when leaving mower unattended; such as disengaging deck, engaging parking brake, lowering attachments, placing steering levers into the neutral lock position, stopping the engine, and removing the key.
25. Never operate the mower with defective guards, shields, or covers. Always have safety shields, guards, switches, and other devices in place and in proper working condition.
26. Place ODCD in the down or operating position when discharge is toward road, street, or property.
27. Keep hands, feet and clothing away from rotating parts anytime the mower engine is running.
28. Do not mow with damaged or worn blades. Make sure blades are properly balanced.

GENERAL SAFETY PRECAUTIONS

29. Stop the engine, set parking brake, and remove the key:
 - After striking a foreign object. Inspect the mower for damage and make any repairs before starting and operating the mower.
 - Before making any adjustments or repairs.
 - Before unclogging discharge chute.
 - Before refueling.
 - Before exiting the mower.
30. Do not change the engine governor settings or overspeed the engine.
31. Use care when pulling loads or using heavy equipment.
 - Use only approved drawbar hitch points.
 - Limit loads to those you can safely control.
 - Do not turn sharply.
 - Use care when backing.
 - Use extreme caution on slopes.
 - Loads should not be pulled down slopes. Load may exceed braking capabilities of the mower causing serious injury or death.
32. Use caution when near or crossing driveways, parking lots, roads, and sidewalks.
33. Always run engine at idle for at least one minute (five minutes maximum) for each hour of previous running, before shutting down engine.
34. Never attempt to service or adjust the blower attachment while engine is running.

SAFETY INFORMATION DECALS

The following decals are intended to alert you to potential hazards and to provide you with important safety information. Should these decals become difficult to read or are missing from the mower, contact your Dixie Chopper dealer for a replacement.



PART IDENTIFICATION

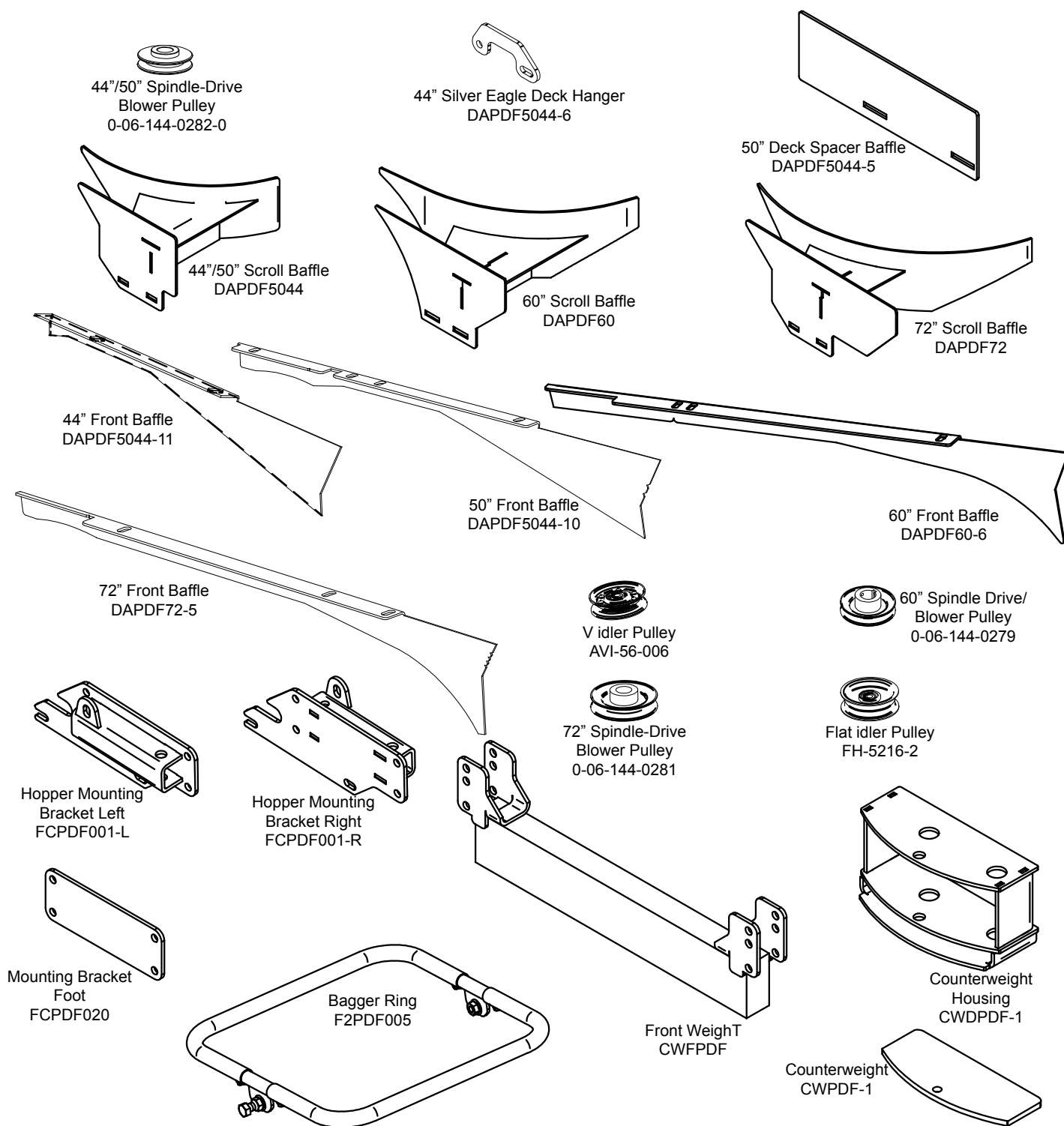

DCB037	Hose	DAPDF72Kit	72" Deck Kit
DCD077	F2 Bag	FCPDF001-D	Diesel Hopper Kit
2006A62R	A62 Belt	BLPDF020	Discharge Liner
DAPDF44Kit	44" Deck Kit	FCPDF029	Hardware Kit
DAPDF60Kit	60" Deck Kit	DAPDF50Kit	50" Deck Kit

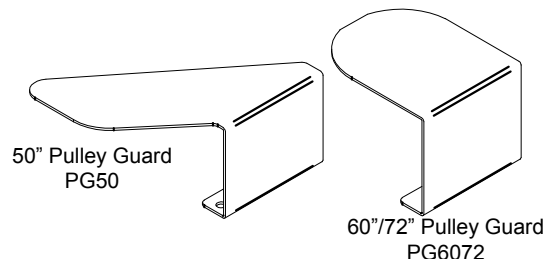

F5 PART IDENTIFICATION

Ref. #	Part #	Description
1	FCPDF002	Leg
2	FCPDF016-L	Angle Leg LH
3	FCPDF016-R	Angle Leg RH
4	F5PDF002	Main Body
5	FCPDF003	Inlet Tube
6	F5PDF003	F5 Door Assembly
7	F5PDF013	Handle Assembly
8	FCPDF026	Push Bar Straight
9	FCPDF028-R	Latch RH
10	FCPDF028-L	Latch LH
11	FCPDF027-L	Push Bar Left Bent
12	FCPDF027-R	Push Bar Right Bent
13	FCPDF023	Heat Shield
14	FCPDF024	L-Bracket
15	FCPDF025	Stabilizer
16	N/A	Clevis

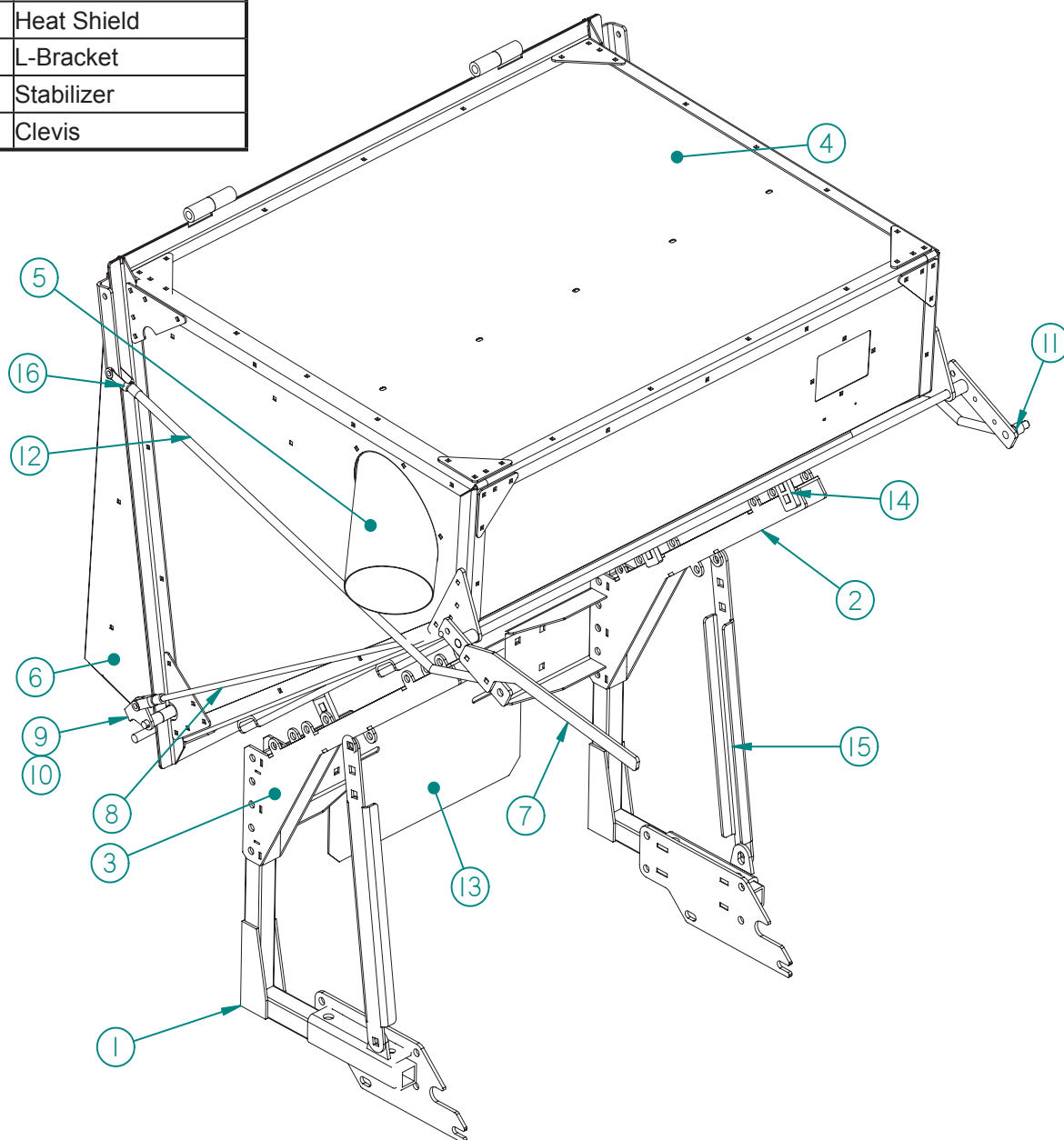

F4 PART IDENTIFICATION

Ref. #	Part #	Description
1	FCPDF002	Leg
2	FCPDF016-L	Angle Leg LH
3	FCPDF016-R	Angle Leg RH
4	F4PDF002	F4 Main Body
5	FCPDF003	Inlet Tube
6	F4PDF003	F4 Door Assembly
7	F4PDF013	F4 Handle Assembly
8	FCPDF026	Push Bar Straight
9	FCPDF027-L	Push Bar Left Bent
10	FCPDF027-R	Push Bar Right Bent
11	FCPDF028-L	Latch LH
12	FCPDF028-R	Latch RH
13	FCPDF023	Heat Shield
14	FCPDF024	L-Bracket

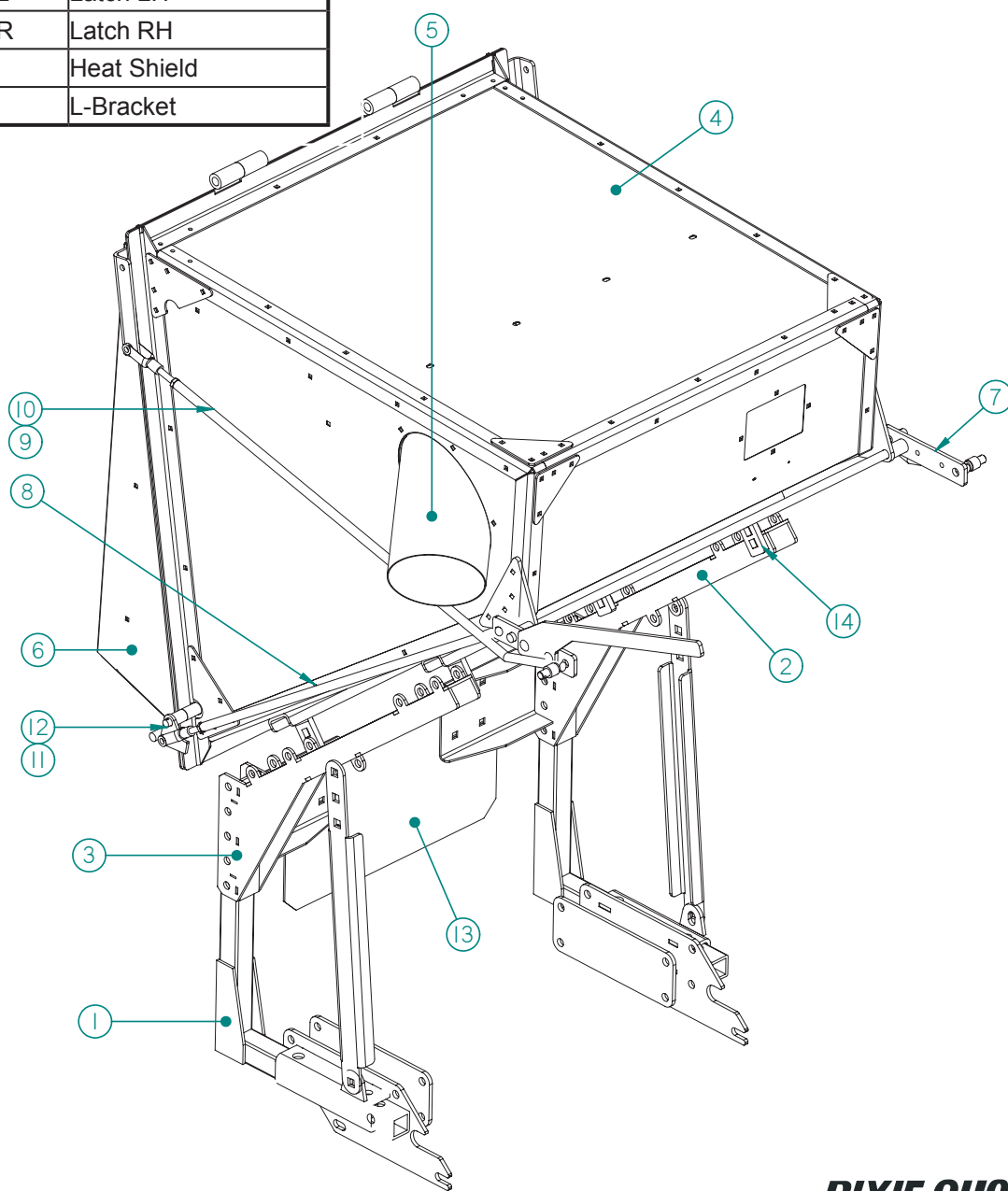

F2 PART IDENTIFICATION

Ref. #	Part #	Description
1	F2PDF004-R	Leg RH
2	F2PDF004-L	Leg LH
3	F2PDF002	Support Frame
4	F2PDF003	Hood
5	F2PDF005	Bag Hoop
6	F2PDF008	Square Tube
7	F2PDF009	Stabilizer Angle
8	F2PDF011	Hood Stop </td
9	F2PDF010	Stabilizer
10	F2PDF012	Heat Shield
	DCD022	Hood Latch

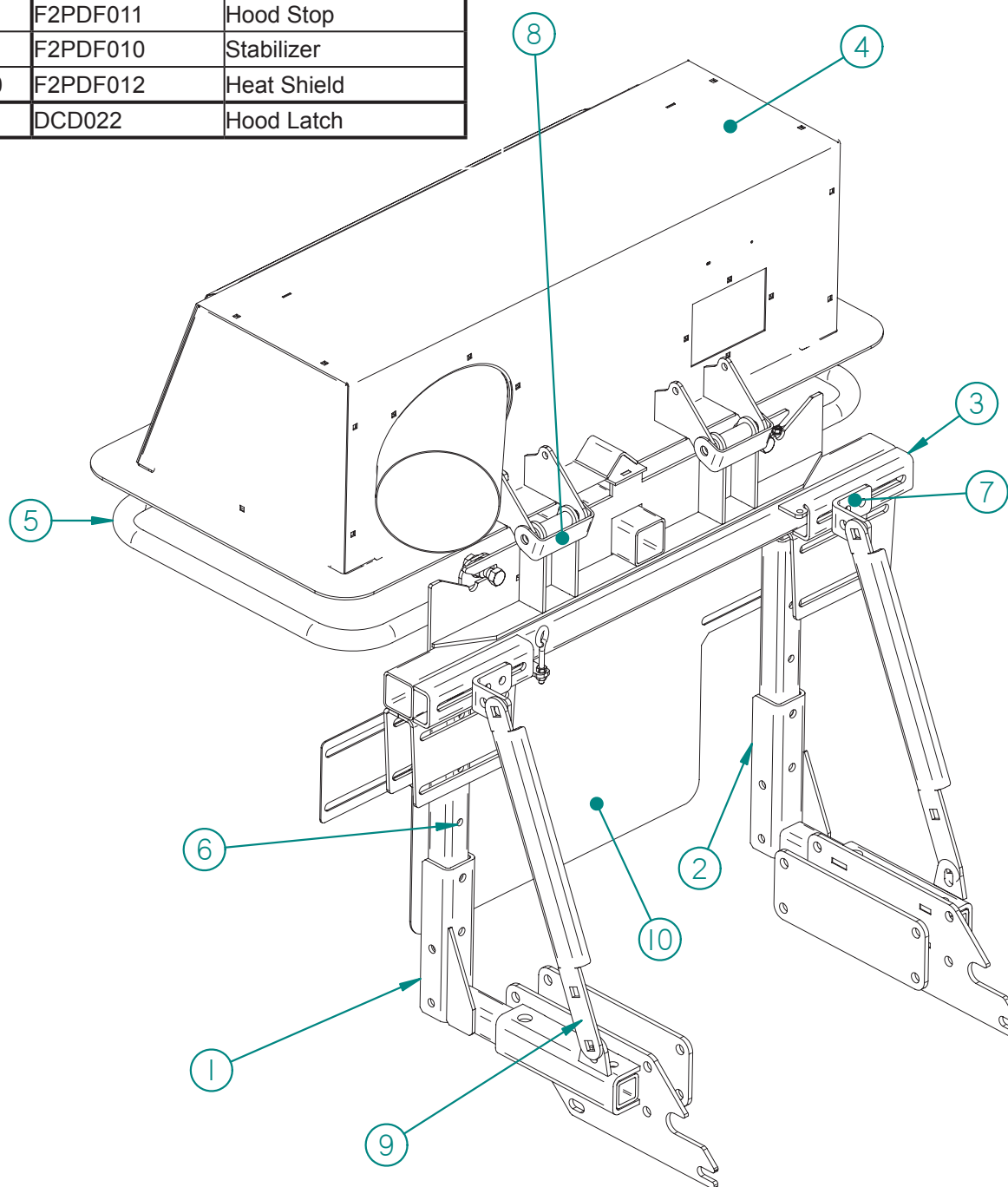

BLOWER ASSEMBLY PART IDENTIFICATION

Ref. #	Part #	Description
1	BLPDF002	Inlet Plate
2	BLPDF003	Sand Liner
3	BLPDF004	Impeller
4	BLPDF005	Mounting Plate
5	BLPDF006	Mounting Hitch (BLWR)
6	BLPDF007	Engaging Handle (BLWR)
7	BLPDF008	Vertical Alignment Brkt.
8	BLPDF009	Discharge Alignment Angle
9	BLPDF010	Pulley Cover
10	BLPDF011	Belt Take-up
11	BLPDF012	Hitch Adjustment Plate
12	BLPDF013	Handle
13	BLPDF014	Hook Latch
14	BLPDF019	Blower Housing
15	BLPDF016	Alignment Plate
	BLPDF020	Discharge Liner

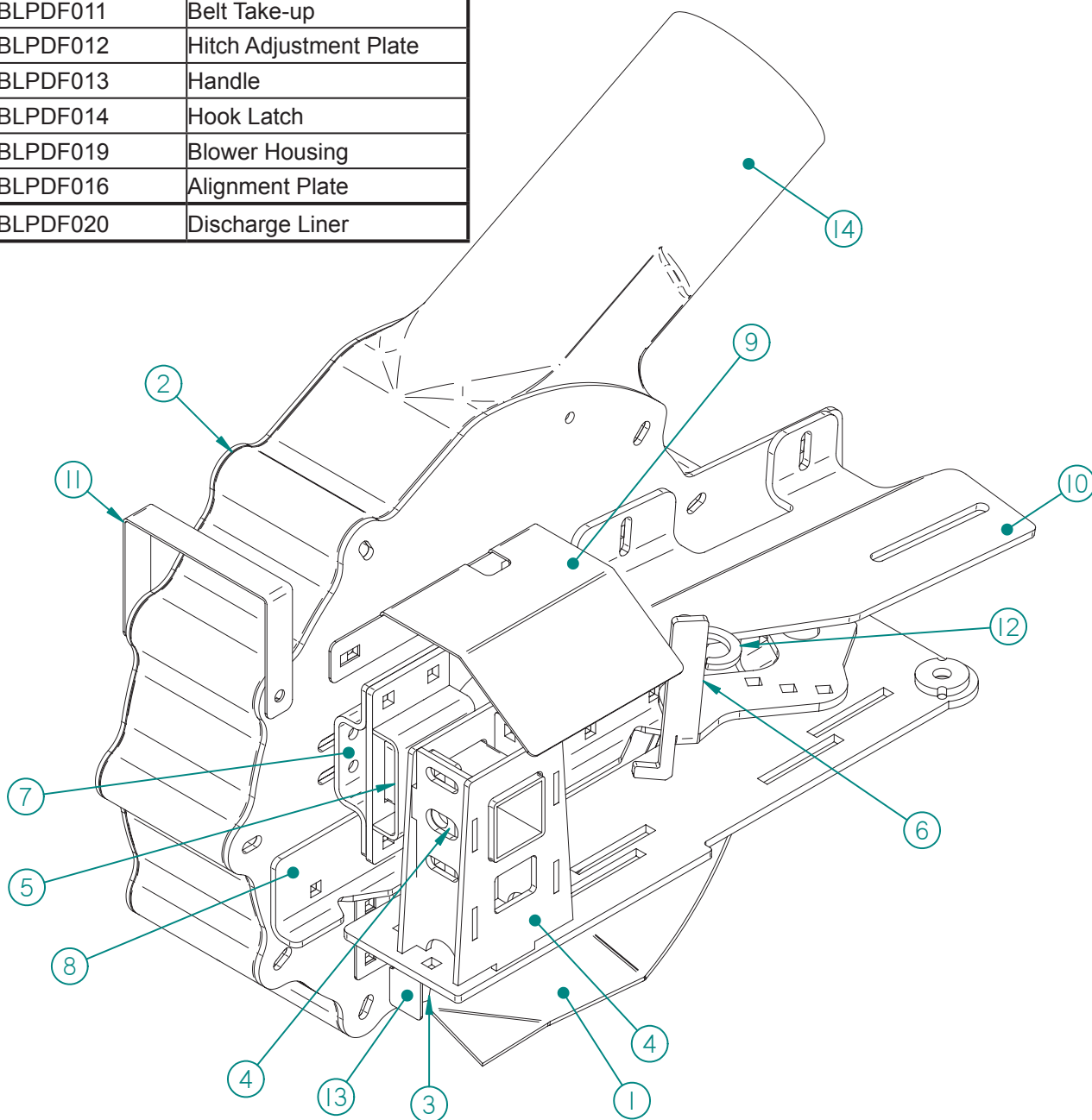

Bagger Installation Instructions

(specify deck size when ordering)

Blower Installation

1. Remove OCDC by taking out 3/8" carriage bolts. Save bolts and nuts for later use.
2. Remove pulley guard and discharge baffle, if equipped, (Fig. 1-1).
3. Remove hub spindle nut from discharge side with 1-1/2" socket.
4. Install spindle drive blower pulley (collar down), removing washers so that nut is flush with top of shaft, (Fig. 1-1A).
5. If your mower is a 44-inch Silver Eagle, replace the chain with the deck hanger for belt clearance (Fig. 1-2).

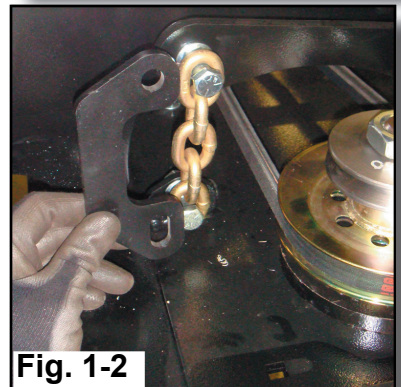
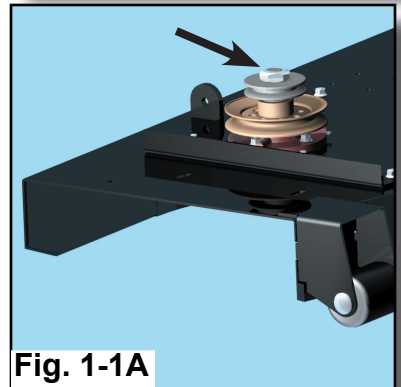
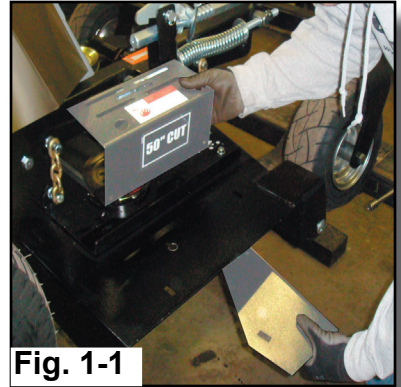

NOTE: *If the machine has a 50-inch deck, a spacer baffle must be installed, (Fig.1-3). Before installing the blower mounting bracket on a 50-inch machine, you must install the spacer.*

6. Using bolts removed from the OCDC earlier, mount the blower bracket to the deck and finger-tighten them.

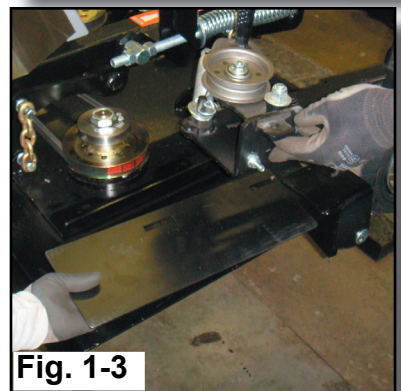

Blower Installation (continued)

7. Loosen the four receiver bolts on the receiver tower, (Fig. 1-4).

If your mower has a 44- or 50-inch deck, remove the small blow-out baffle from the blower assembly. (Fig. 1-5).

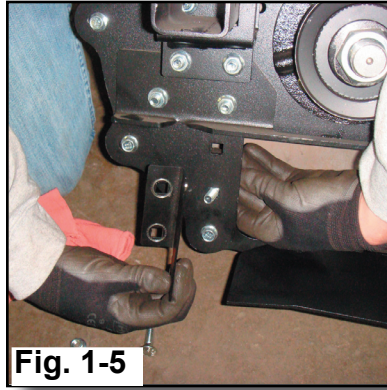
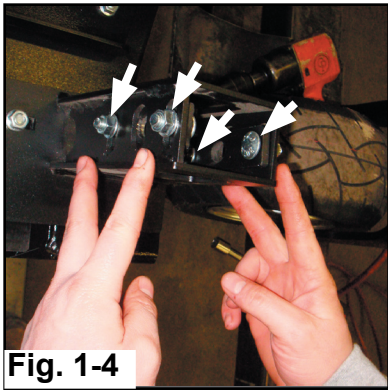

8. Install the blower to the receiver bracket. Secure it in position on the tower with the hairpin clip through the gold clevis pin. Secure the linch-pin at the rear of the assembly.

9. Locate the rear scroll baffle (component in specific deck kit) and loosen the two 5/16" bolts at the rear of the mounting bracket, (Fig 1-6). Install the baffle finger-tight. Note: Scroll baffle should be pushed up against the inside back and top of the deck as tightly as possible to be correctly seated, (Fig. 1-7,1-8).

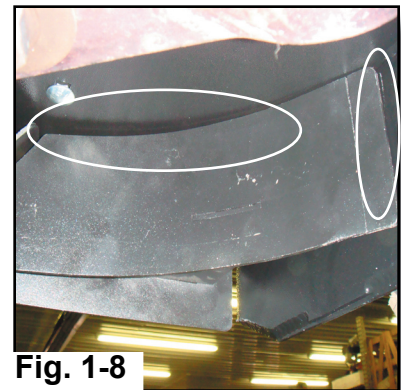
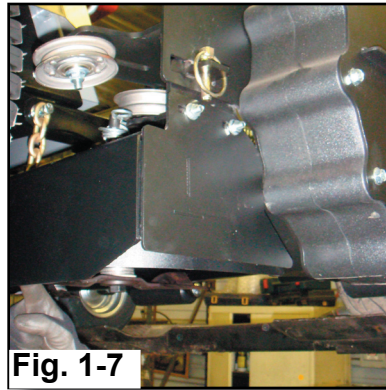
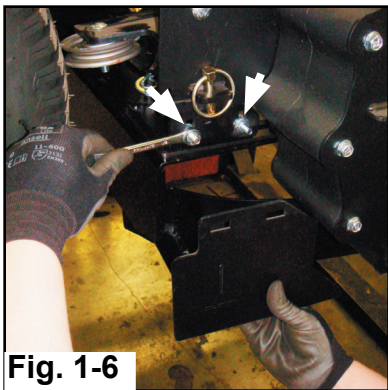

10. Tighten the two nuts that were left finger-tightened on the mounting bracket, (Fig. 1-6).

11. Tighten the four receiver tower bolts, making sure the blower is at a right angle (90 degrees) to the deck, (Fig. 1-4). You may have to adjust the blower in order to achieve proper alignment.

Blower Installation (continued)

12. Remove front blow-out baffle from deck (see photo 1-9). You need to identify the type of deck you have. The Elite deck has only two blow-out baffles (1-10), while the Standard deck has three blow-out baffles (one on each side with a short one in the middle). If it is not an Elite deck, blow-out baffles need to be cut at the notches on the baffles to accommodate the deck, (Fig. 1-11)

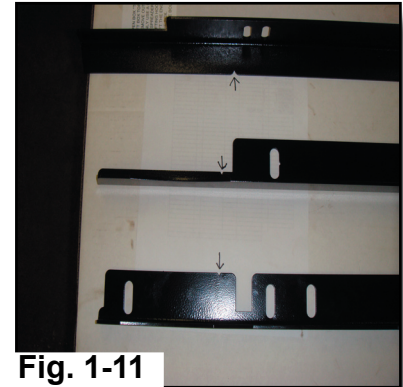
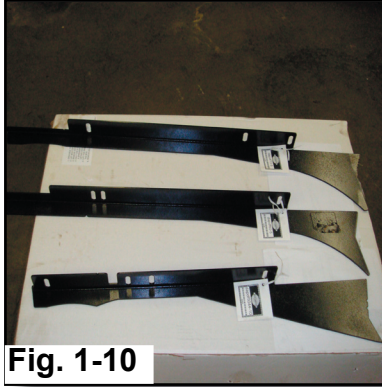
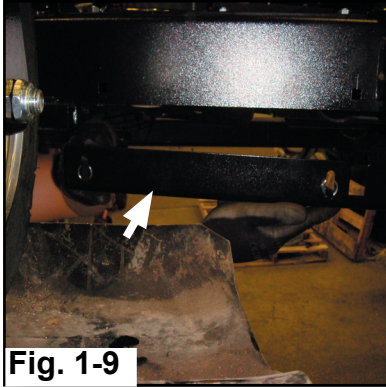

13. Install the blow-out baffle by making sure the wide, angled end slides into the blower mouth, (Fig. 1-12). Then tighten baffle down. Left side baffle should be lowered to the same level as the new blow-out baffle that has been installed. Once baffles are secure, fully tighten the mounting bracket bolts in step 6.



14. Installing the belt.

Procedure for 44" and 50" Deck, (steps 14A-14D)

- A. Remove the V-idler mounting bracket from the blower, (Fig. 2-1).
- B. Remove idler arm nut to change position of idler arm pulley (center hole is the factory-set hole). Move to the next bolt hole to the left (closest to the tire) to assure V-idler clearance with the back tire, (Fig. 2-1A).
- C. Reinstall idler arm and pulley (don't overtighten).
- D. Reinstall V-idler mounting bracket.

Procedure for all decks. (44" and 50" decks must first perform steps 14A-14D)

- E. Pull idler arm over and latch and hook into place, (Fig. 2-2).
- F. Using a 9/16" wrench, loosen the V-idler pulley and install an A62 belt, (Fig. 2-3).
- G. Push V-idler toward the tire, push by hand until the belt is somewhat taut and tighten the bolt on the bottom of the V-idler. **VERY IMPORTANT:** To ensure longevity of the belt, carefully check the belt alignment.
- H. Once tightened, release the idler arm from the hook.
- I. Before operating, be sure blower hub is full of grease.
- J. Install new pulley guard (Fig. 2-4).

Verify that all fasteners are fully tightened before proceeding.

Blower Installation (continued)

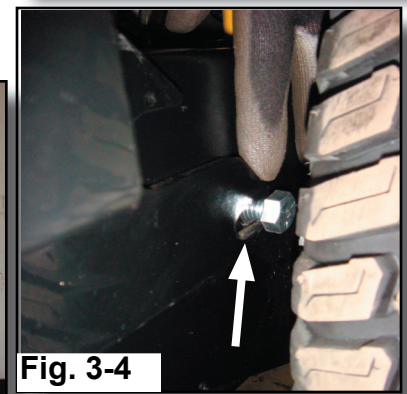
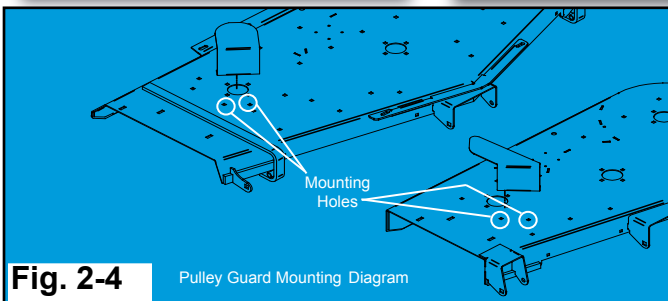
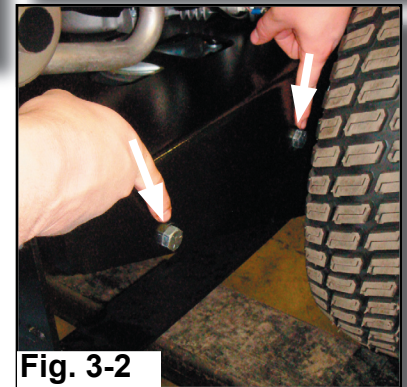
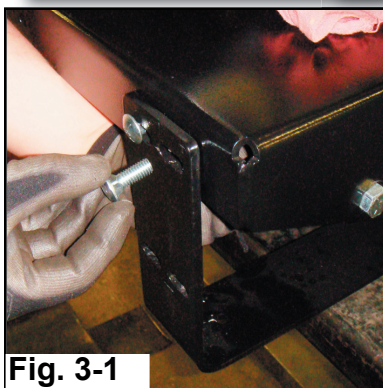
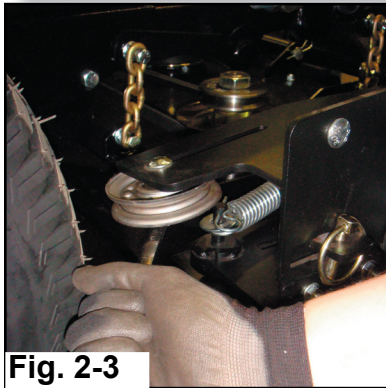
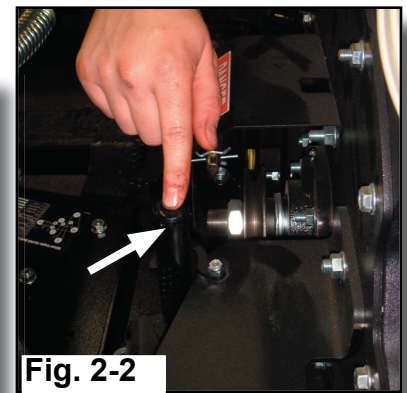
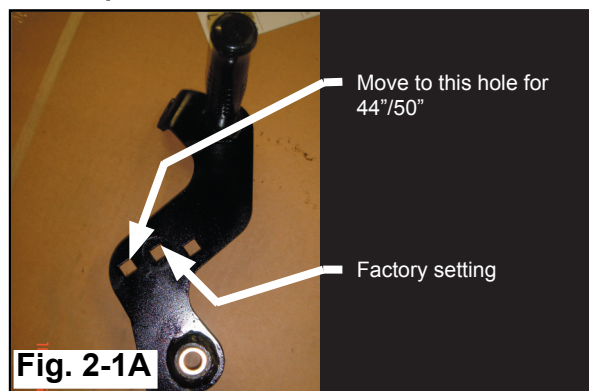
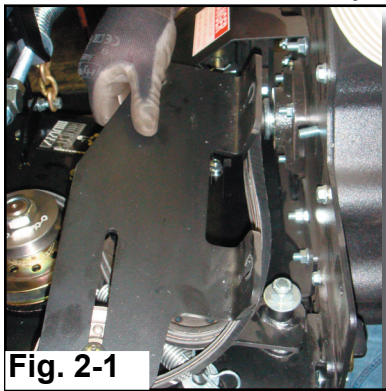

Hopper Installation Instructions

Silver Eagle Hopper Mounting Bracket Installation

1. Remove rear guard (If equipped, muffler guard, remains on the mower).
2. Using four 3/8"-18 x 1" carriage bolts, re-secure the wheelie bars to the frame (Fig. 3-1).
3. Using a 3/4" wrench, remove the 1/2" bolts on each side of the rear of the machine (Fig. 3-2).
4. Locate hopper mounting brackets and four 1/2"-13 x 1-1/4" bolts (Fig. 3-3).
5. Replace the front bolts with the 1/2"-13 x 1-1/4" bolts from the kit. In replacing the front bolts, leave 1/2" gap to enable the mounting bracket to slide into place (Fig. 3-4). Install the back bolts through the bracket (Fig. 3-5).
6. Securely tighten all four bolts.

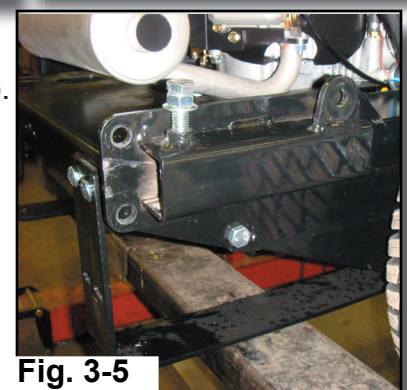

Hopper Installation Instructions (continued)

Standard machine (Classic, Xtremes) Mounting Bracket Installation

1. Remove rear guard (mowers equipped with a 90-degree tailpipe will need to have it removed).
2. Locate foot clamps and hardware. (Fig. 3-6)
3. Using foot clamps and hardware provided, attach the hopper mounting bracket to the frame. Pull back until against the hitch. (Fig. 3-7)
4. Securely tighten all eight bolts.

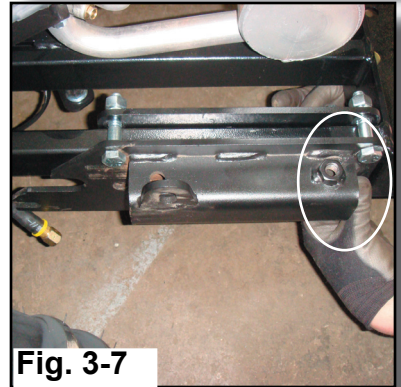
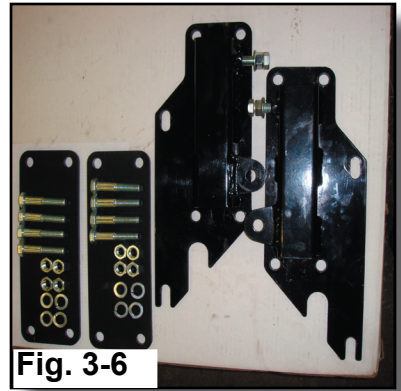

Propane/LP 3000 Left Side Mounting Bracket Instructions

1. Perform steps 1-4 for the standard machine mounting bracket installation for the right side bracket.

Follow the following steps, below, for the left side mounting bracket.

2. Attach mounting bracket to the frame with U-bolts, supplied in hardware kit, and coupler nuts from the engine guard for the left side of the propane mower (due to the presence of vaporizer). (Fig. 3-8).
3. Securely fasten the four bolts on right side and 4 coupler nuts on left side.

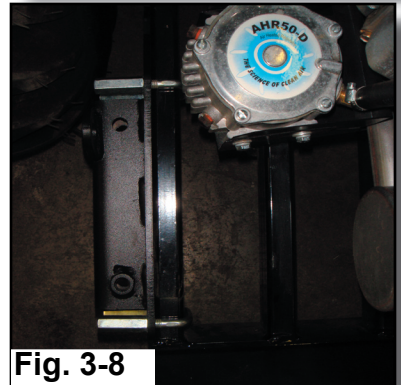

F2/F4/F5 Hopper Installation Instructions

Pre-installation notes:

F2 Hopper

- The legs may have been turned around due to shipping purposes.
- Loosen the four leg support bolts to accomodate differing frame widths. (Fig. 4-1).

F4/F5 Hopper

- Loosen the eight leg mounting bolts to accomodate differing frame widths. (Fig. 4-2).



Fig. 4-1

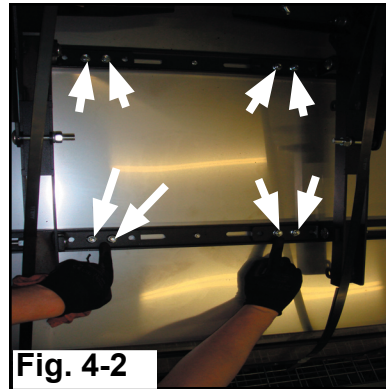

Fig. 4-2

Hopper Installation

1. Lift hopper into place, sliding the legs squarely into the mounting brackets.
2. Locate the two clevis pins and two hairclip pins, included with kit, and insert the clevis pin into the hole on the mounting bracket, (Fig. 4-3), then insert the hairpin clip in the clevis pin on bottom.
3. Using 3/4" wrench, tighten 1/2"-13 bolt on the mounting bracket to prevent wobbling, (Fig. 4-4).
4. Attach support arms to the mounting brackets with two 1/2"-13 carriage bolts and two 1/2"-13 whiz-flange lock nuts, provided in the kit.
10. Retighten the support arm mounting bracket on the hopper that were loosened during the pre-installation steps.

Note:

On some machines, it may be necessary to adjust the height of the legs to prevent hopper lid from hitting the air cleaner.

11. Find the short piece of hose that came with the bagger and the clamp that came with the hardware kit.



Fig. 4-3

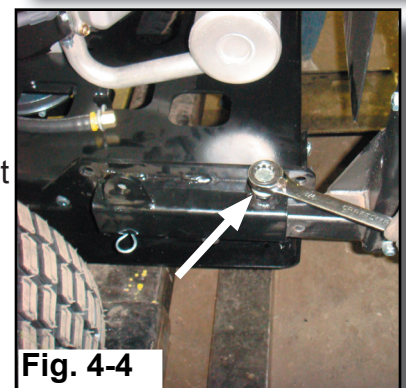

Fig. 4-4

Hopper Installation (continued)

12. Attach the hose to the hopper lid and use the clamp to tighten it down. (On some machines, the length of hose may need to be cut-off to fit properly.)

Note:

There is no clamp between the short hose and black connector pipe in order to facilitate ease in disconnecting or cleaning if clogging occurs.

F4/F5 Door Linkage Adjustment Procedure

1. Put the hopper arm at a position between 3:30 and 4:00 and hold in this position.
2. Push the door shut while still holding the handle, at the position in step 1, and attach the top yoke, (Fig. 4-5).

Final note: *Make sure everything that has been loosened is retightened before operating.*

Counterweight Installation

1. Remove the two carriage bolts from the trim side of the mower deck, (Fig. 5-1).
2. Using the same bolts from previous step, fasten the counterweight to the deck (Fig. 5-2).
3. Install the front counterweight

A. Silver Eagle

The weight will slide over the frame rails and bolt to the frame (Fig. 5-3).

B. Standard Mowers

The front bumper will need to be loosened and the weight will slide under it. After fastening weight to the frame, re-tighten bumper hardware (Fig. 5-4).

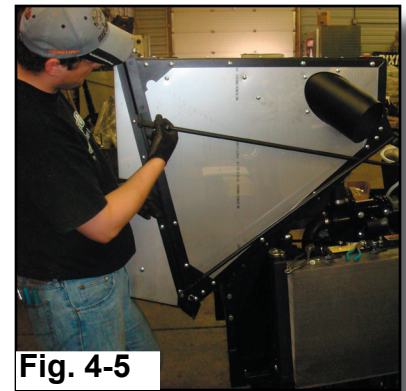

Fig. 4-5

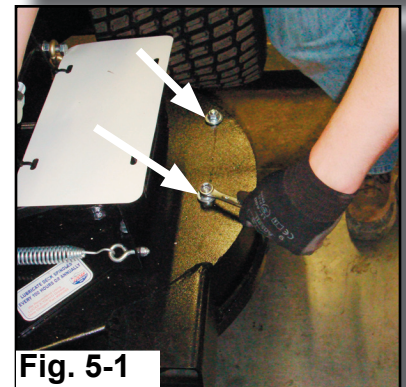

Fig. 5-1

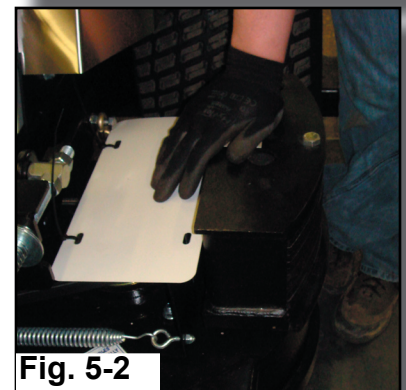

Fig. 5-2

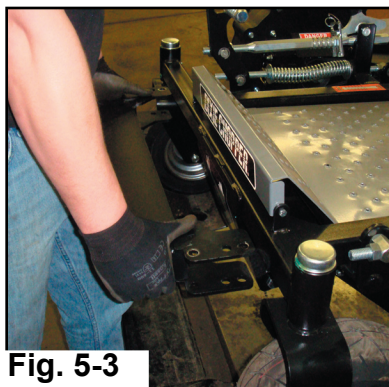

Fig. 5-3



Fig. 5-4

Notes:

Upon completion of hopper and blower installation, check deck for proper level and pitch. Center the hopper to the seat so that its weight is distributed evenly.

Diesel Hopper Installation Instructions

1. Remove rear guard and radiator brace (with stainless pulley guard).
2. Unclamp the hose from the radiator to the overflow tank and remove hose.
3. Loosen radiator U-bolts and slide radiator forward as much as possible without touching the hydraulic hoses.
4. Install the updated declutch arm supplied in kit (Fig. 6-1).

Tip: Relieve pressure from the declutch spring by placing spacers over the threaded rod and lock them down with a nut. This will allow removal of declutch cable yoke (Fig. 6-2).

5. Attach foot brackets for new pulley guard with 1/4" carriage bolts and finger-tighten (Fig. 6-3).
6. Locate the hopper mounting brackets, foot clamps, and eight 1/2"-13 x 3" bolts that are included in the diesel hopper mounting kit.
7. Install left mounting bracket on the top of the outer frame rail with hopper brace ("ear") facing forward (Fig. 6-4).

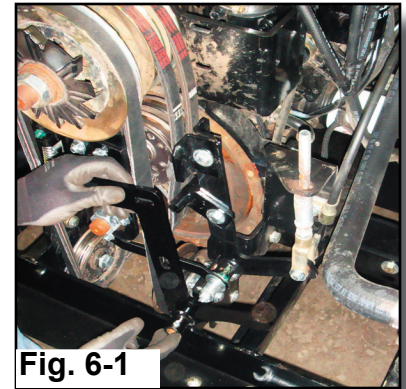

Fig. 6-1

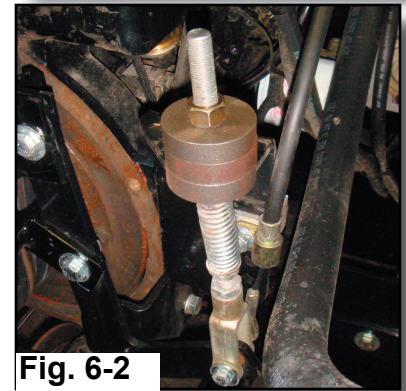

Fig. 6-2

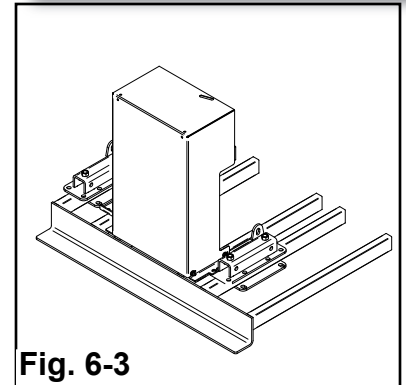

Fig. 6-3

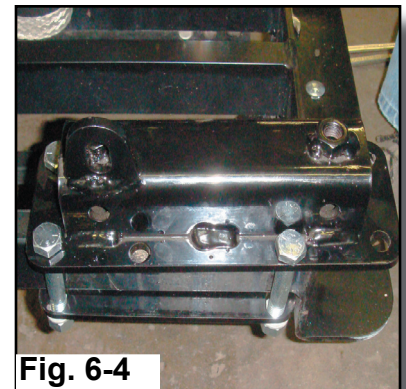

Fig. 6-4

Diesel Hopper Installation Instructions (continued)

Important notes:

- On the 72" diesel, the receiver bracket will stick out past the hitch two inches (Fig. 6-5).
- On the 60" diesel, the receiver bracket will be up even against the rear of the hitch (Fig. 6-6).

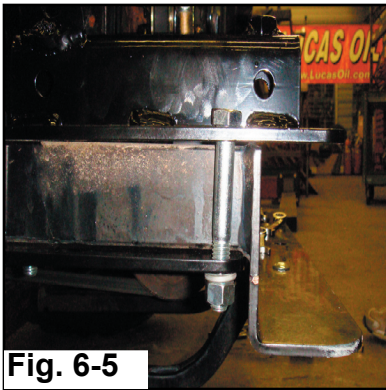

Fig. 6-5

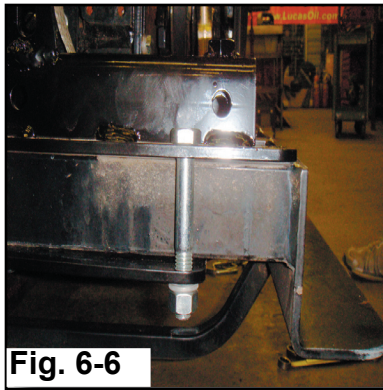

Fig. 6-6

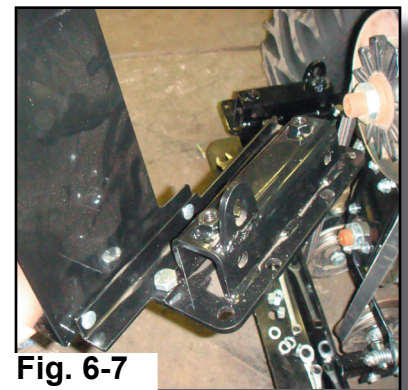

Fig. 6-7

9. Use the 1/2"-13 x 1" bolt and 1/2"-13 whiz nut, included in kit, to connect pulley guard to the mounting bracket (Fig. 6-7).

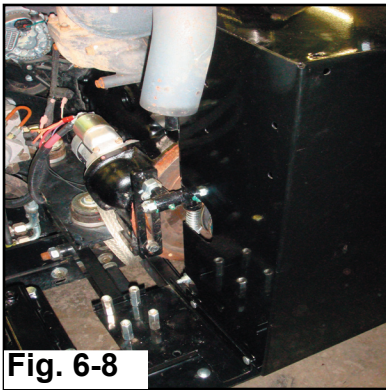

Fig. 6-8

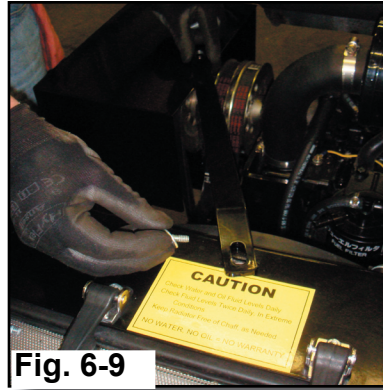

Fig. 6-9

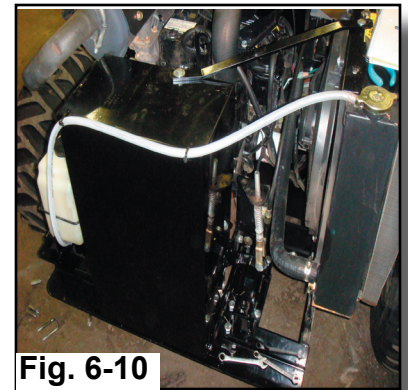
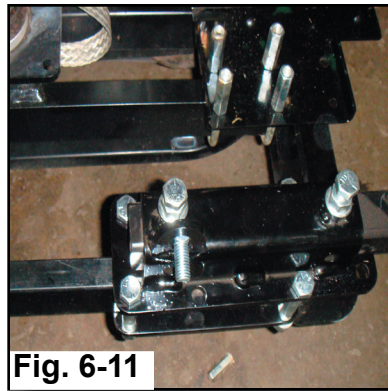

Fig. 6-10

10. In attaching the pulley guard, use the U-bolts and coupler from the engine guard to attach the support bracket to the left side of the frame (Fig. 6-8). Be sure new pulley guard has clearance from the muffler and any other components. Tighten the 1/4"-20 carriage bolts on the pulley guard.
11. Move the radiator support bracket to the middle hole of the radiator (only on the 72") and reattach strap to the pulley guard (Fig. 6-9).
12. Remove radiator overflow tank from rear guard. Mount overflow tank to the left side of the pulley guard. The old hose will not be long enough now, so take the new braided hose that comes with the kit and run a new line (Fig. 6-10).
13. Loosen the bolts that hold the legs of the hopper to accommodate the proper width before sliding legs into the mounting brackets.

Diesel Hopper Installation Instructions (continued)

Note: On 72" diesel machines a 1/4" of the left leg should be sticking out through the left bracket (Fig. 6-11).



14. Take the lockdown bolts that came with the bagger and secure the hopper legs (Fig. 6-11).
15. Install the new tailpipe provided in the kit. You will attach the new tailpipe to the 90-degree tailpipe for clearance purposes. **Failure to perform this step will damage overflow tank.**

Final notes: *Re-tighten all fasteners before operating.*

For Dixie Chopper Discount Parts Call 606-678-9623 or 606-561-4983

DIXIE CHOPPER

The World's Fastest Lawn Mower

6302 E. County Road 100 North

Coatesville, IN 46121

Phone 1-765-CHOPPER

www.dixiechopper.com

Dixie Chopper, Magic Circle, and the Magic Circle Atom Logo are all trademarks of Magic Circle Corporation and may not be reproduced without permission.

Printed In USA

Specifications and instructions subject to change without notice.

Print Date 4/08

www.mymowerparts.com