

92500 to 92599

Illustrated Parts List

Model Series

92500 to 92599

NON-COMPLIANCE

TYPE NUMBERS
0110 through 0280
0600 through 1096

TO FIND

THE CORRECT NUMBER OF THE PART YOU NEED:

FOLLOW THE INSTRUCTIONS BELOW

- A. Refer to Engine Model, Type and Code Number that is stamped on the blower housing of engine. Engine type numbers such as 012301 are listed herein only as 0123. The two digits (01 or 02, etc.) to the right of the space are not needed for parts identification. Then use the Illustrated Parts List covering the Model Series.
- B. Refer to Illustrated Parts section and compare the old part with illustration. The number on the illustration is the Reference Number. Assemblies include all parts shown in frames. All parts shown in assembly frames on which individual reference numbers are given can be purchased separately.
- C. After the Reference Number has been identified, refer to the Numerical Parts List, where Reference and Master Part Number are listed. **THE MASTER PART IS USED ON ALL TYPE NUMBERS EXCEPT THOSE TYPE NUMBERS UNDER "NOTE"**.
- D. If a "Note" appears below the Master Part Number, this means that this part differs from the Master Part for certain types. If the Type number is listed under "Note", order the part referred to.
- E. *If the Engine Type Number does not appear after any part number listed under "Note", use the Master Part Number.*
- F. For Type Numbers higher than those covered by this book, please refer to the factory if you are unable to identify the part by comparison.

PRINTED IN U.S.A.

COPYRIGHT©



92500 to 92599

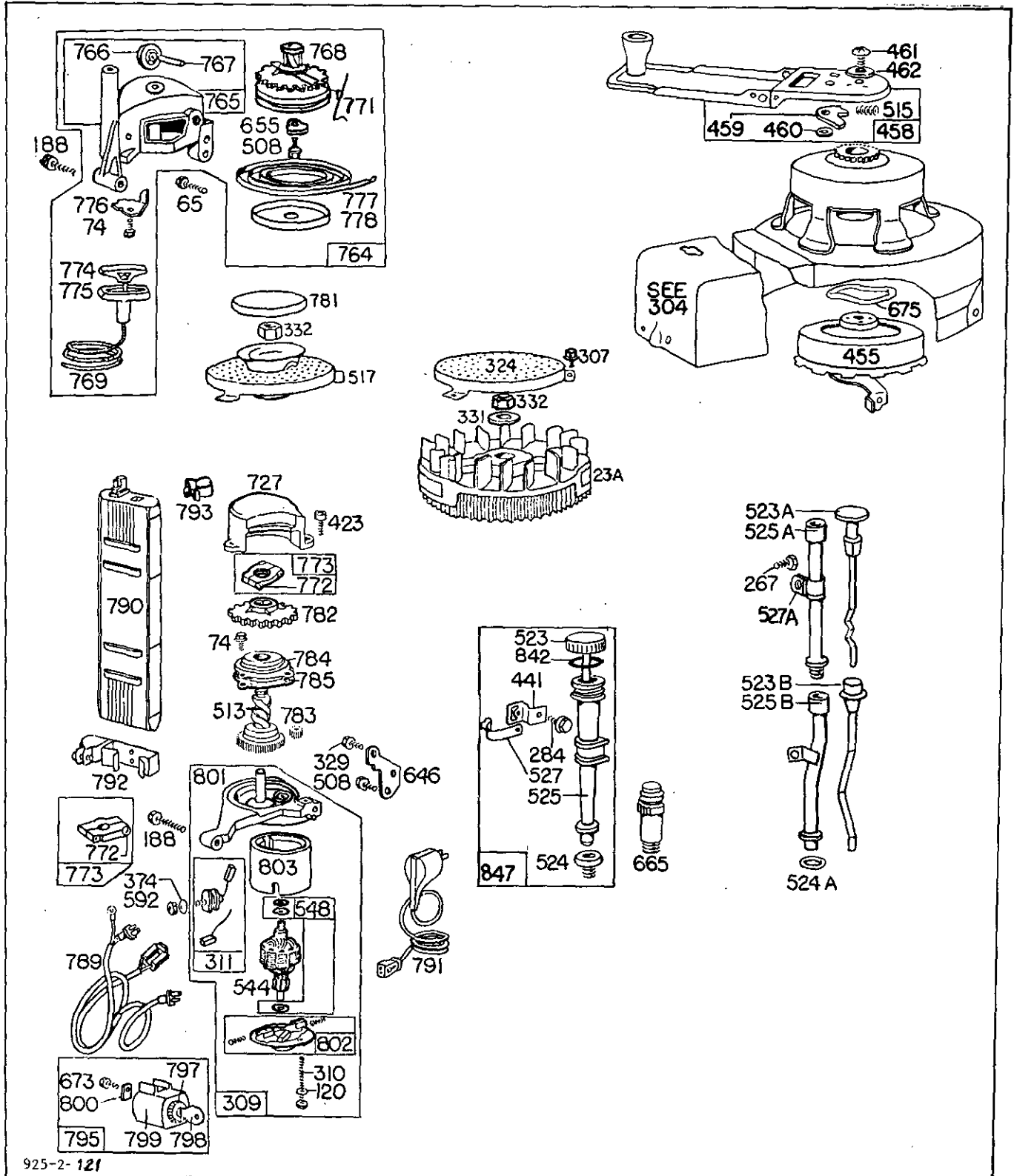

Assemblies include all parts shown in frames.

92500 to 92599

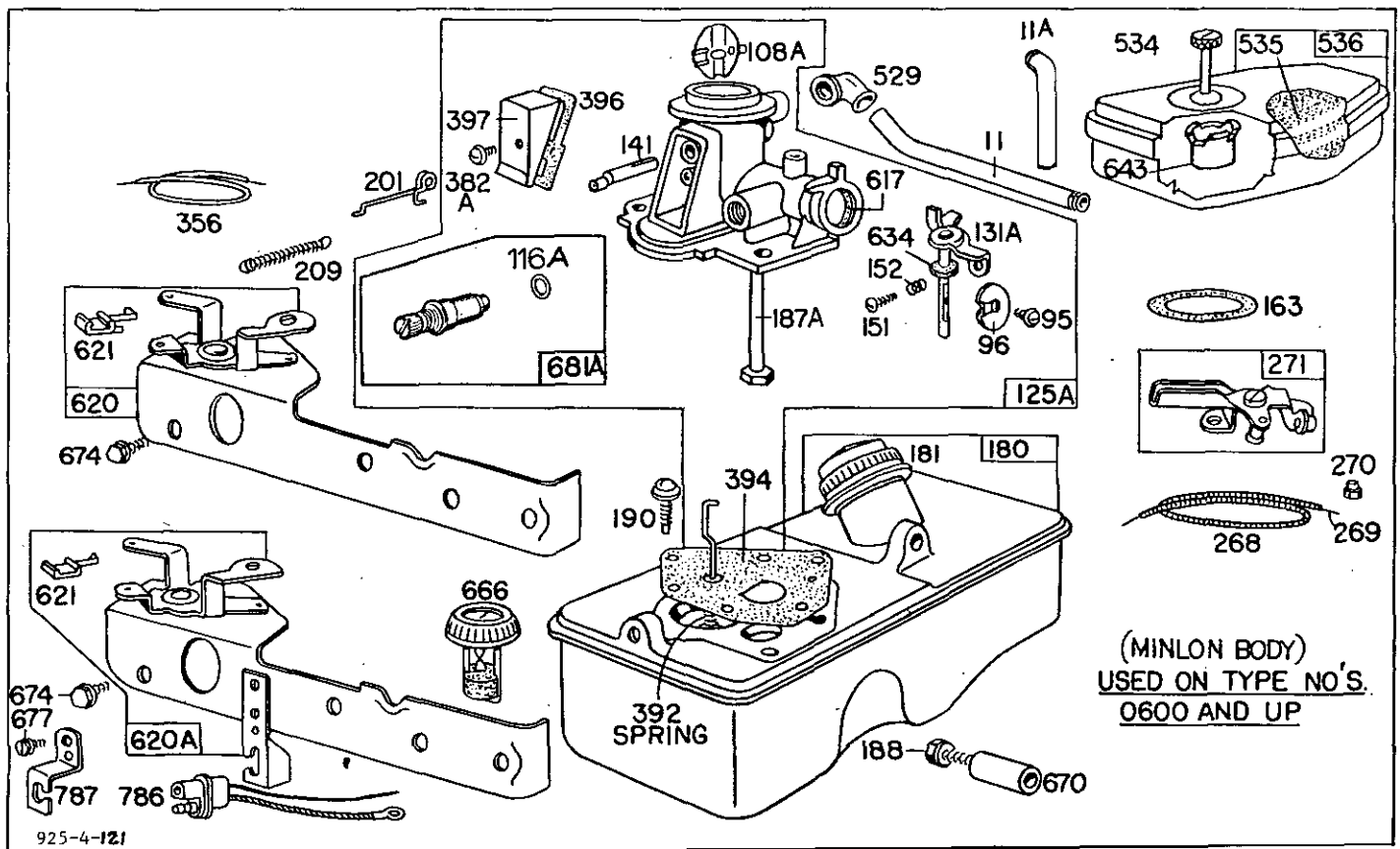
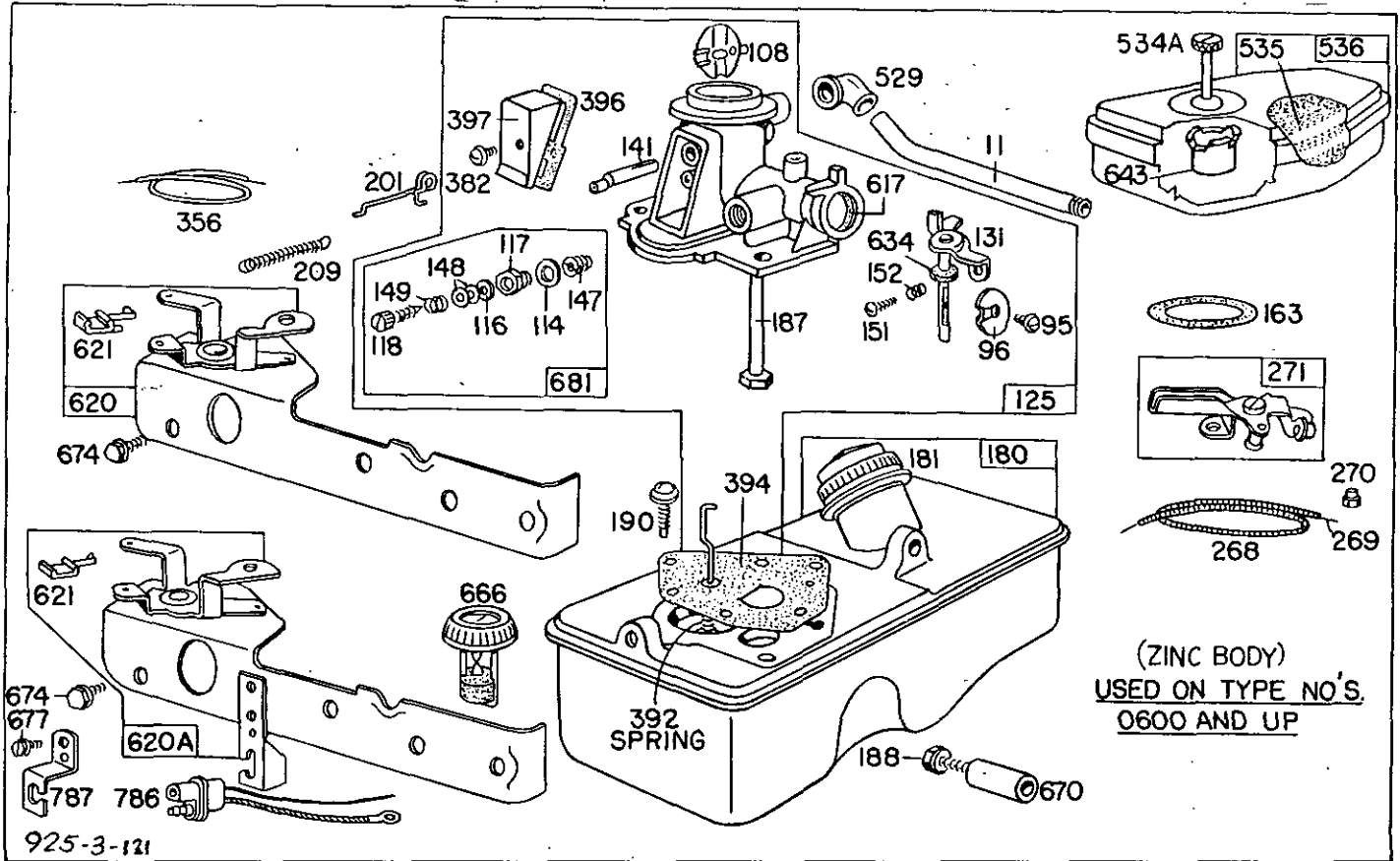

Assemblies include all parts shown in frames.

92500 to 92599

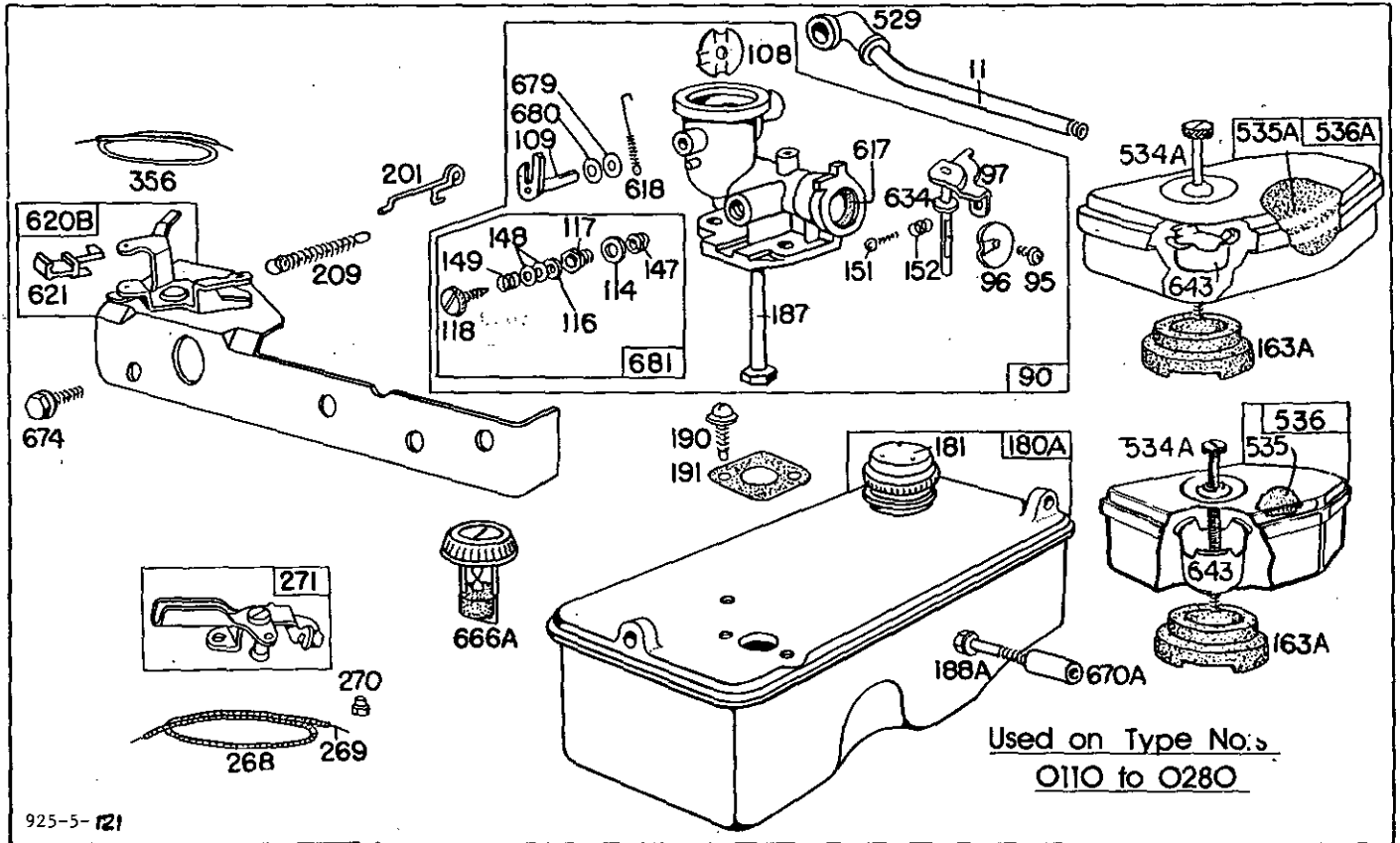

Assemblies include all parts shown in frames.

92500 to 92599

REF. NO.	PART NO.	DESCRIPTION	REF. NO.	PART NO.	DESCRIPTION	REF. NO.	PART NO.	DESCRIPTION
1	298988	Cylinder Assembly	16	260124	Crankshaft			1059, 1060, 1061,
2	293708	Bushing—Cylinder		Note: 260096	Crankshaft			1062, 1064, 1065,
	Note:	Requires special tools for installation			Used on Type Nos.			1066, 1068, 1069,
3	299819	Seal—Oil			0116, 0121, 0133,			1070, 1072, 1074,
5	211479	Head—Cylinder			0147, 0158, 0162,			1078, 1081, 1086,
7	*270341	Gasket—Cylinder Head			0170, 0176, 0181,			1089, 1090, 1091,
8	298383	Breather—Valve Chamber			0188, 0196, 0198,			1092, 1093, 1095.
	Note: 292833	Breather—Valve Chamber (For Rubber Hang Down Tube Ref. 11A)			0201, 0211, 0212,			260097 Crankshaft
	Uses:				0216, 0220, 0223,			Used on Type Nos.
	27549	Gasket—Valve Cover For Carburetor Assembly Refer to 125A Note			0224, 0225, 0228,			0117, 0122, 0141,
9	*270239	Gasket—Valve Cover			0233, 0236, 0237,			0155, 0163, 0164,
	Note: 27549	Gasket—Valve (See Ref. 8 Note)			0239, 0249, 0250,			0167, 0183, 0208,
10	93394	Screw—Breather and P.T.O. Gear Sump Cover Mtg. Sem (Ref. No. 86)			0261, 0263, 0266,			0214, 0234, 0252,
					0267, 0268, 0271,			0269, 0270, 0603,
11	230802	Tube—Breather (Metal Tube Connecting Carburetor and Breather)			0275, 0277, 0602,			0611, 0615, 0619,
					0606, 0610, 0614,			0627, 0643, 0688,
11A	271489	Tube—Breather (Rubber Hang Down Tube See Ref. 8 Note)			0618, 0675, 0680,			0691, 0693, 0732,
					0689, 0692, 0694,			0739, 0746, 0755,
12	*270833	Gasket—Crankcase—.015" thick (Standard)			0696, 0698, 0701,			0756, 0758, 0764,
	*270895	Gasket—Crankcase—.005" thick			0702, 0703, 0707,			0801, 0804, 0817,
	*270896	Gasket—Crankcase—.009" thick			0715, 0720, 0721,			0823, 0824, 0832,
13	93111	Screw—Cylinder Head (1-15/16" long)			0722, 0726, 0727,			0833, 0835, 0843,
	Note: 93772	Stud—Cylinder Head			0728, 0735, 0736,			0847, 0848, 0853,
	22963	Washer Used on Type Nos. 0896, 1058, 1071, 1080.			0738, 0740, 0742,			0854, 0856, 0859,
					0745, 0752, 0759,			0877, 0889, 0893,
15	91084	Plug—Oil Drain (Square Head)			0762, 0763, 0766,			0894, 0900, 0901,
15A	93418	Plug—Oil Drain (Socket Head)			0770, 0772, 0775,			0943, 0949, 0950,
					0777, 0778, 0779,			0955, 0960, 0994,
					0792, 0793, 0794,			0996, 0998, 1017,
					0795, 0796, 0802,			1024, 1039, 1075.
					0808, 0809, 0810,			260098 Crankshaft
					0811, 0813, 0822,			Used on Type Nos.
					0828, 0829, 0830,			0118, 0123, 0153,
					0839, 0840, 0860,			0161, 0168, 0172,
					0861, 0874, 0896,			0173, 0186, 0187,
					0898, 0906, 0908,			0189, 0190, 0191,
					0909, 0911, 0912,			0192, 0210, 0213,
					0914, 0915, 0916,			0221, 0232, 0235,
					0922, 0927, 0935,			0257, 0258, 0262,
					0948, 0953, 0956,			0265, 0274, 0604,
					0958, 0959, 0962,			0612, 0616, 0620,
					0964, 0967, 0968,			0628, 0643, 0671,
					0971, 0972, 0973,			0672, 0678, 0684,
					0975, 0980, 0992,			0686, 0704, 0705,
					0993, 0995, 0999,			0706, 0708, 0716,
					1004, 1005, 1008,			0718, 0723, 0725,
					1012, 1013, 1014,			0733, 0749, 0750,
					1015, 1018, 1025,			0757, 0768, 0771,
					1027, 1030, 1031,			0773, 0774, 0781,
					1036, 1040, 1041,			0782, 0785, 0787,
					1042, 1045, 1046,			0788, 0789, 0797,
					1047, 1048, 1050,			0798, 0799, 0800,
					1051, 1052, 1055,			0805, 0814, 0819,

*Included in Gasket Set—
Part No. 298989.

92500 to 92599

REF. NO.	PART NO.	DESCRIPTION	REF. NO.	PART NO.	DESCRIPTION	REF. NO.	PART NO.	DESCRIPTION
	298280	Sump—Oil Used on Model 92590 to 92599 Series.		390149	Sump—Oil Used on Type Nos. 0711, 0713, 0714, 0821, 0837, 0838, 0841, 0862, 0863, 0864, 0870, 0921.	23	297949	Flywheel—Magneto
	298727	Sump—Oil Used on Type Nos. 0140, 0254.		390810	Sump—Oil Used on Type Nos. 0844, 0904, 0951, 0952, 0953, 0954, 0980, 0985, 0986, 0990, 1000, 1001, 1033, 1058, 1071, 1080.		Note: 296884	Flywheel— Magneto Used on Type Nos. 0134, 0140, 0143, 0153, 0156, 0157, 0161, 0163, 0164, 0166, 0171, 0172, 0174, 0175, 0176, 0177, 0178, 0180, 0186, 0187, 0197, 0200, 0201, 0203, 0205, 0207, 0210, 0254, 0258, 0259, 0673, 0677, 0679, 0700, 0709, 0717, 0754, 0807, 0861, 0939, 0942, 0966, 1026, 1027, 1035, 1044, 1045, 1057, 1073, 1077, 1078, 1088.
	390017	Sump—Oil Used on Type Nos. 0645, 0646, 0649, 0650, 0664, 0666.	18A	299058	Sump—Oil Used on Model 92580 to 92589 Series.	23A	394032	Flywheel—Magneto (Used after Code No. 79092328.)
	390068	Sump—Oil Used on Type Nos. 0609, 0610, 0611, 0612, 0617, 0618, 0619, 0620, 0654, 0656, 0672, 0676, 0678, 0687, 0688, 0692, 0702, 0706, 0710, 0718, 0727, 0732, 0736, 0739, 0742, 0745, 0746, 0749, 0750, 0751, 0752, 0755, 0757, 0758, 0767, 0768, 0777, 0779, 0784, 0788, 0794, 0800, 0802, 0804, 0814, 0816, 0818, 0820, 0828, 0830, 0840, 0843, 0845, 0848, 0849, 0850, 0851, 0859, 0869, 0877, 0883, 0886, 0888, 0893, 0894, 0896, 0898, 0899, 0901, 0911, 0918, 0923, 0925, 0926, 0930, 0934, 0935, 0936, 0937, 0940, 0943, 0944, 0946, 0947, 0950, 0963, 0968, 0974, 0975, 0983, 0998, 0999, 1007, 1010, 1020, 1028, 1030, 1031, 1038, 1041, 1047, 1050, 1051, 1053, 1056, 1065, 1067, 1082, 1083, 1084, 1085, 1087, 1094, 1095.	Note: 391645	19	293709	Bushing—Oil Sump Note: Requires Special Tool for installation	Note: 299982	Flywheel— Magneto (Used before Code No. 79092428.)
			20	391483	Seal—Oil Note: 391485 Seal—Oil Used on Type Nos. 0140, 0254.	24	61760	Key—Flywheel
					391485 Seal—Oil (Crankshaft—P.T.O. Side)	25	298904	Piston Assy.—Standard
					391484 Seal—Oil (Auxiliary Drive Shaft) Used on Model 92590 to 92599 Series.	298905	Piston Assy.— .010" O.S.	
			21	66768	Plug—Oil Filler	298906	Piston Assy.— .020" O.S.	
			22	93032	Screw—Sump Mtg. Sem	298907	Piston Assy.— .030" O.S.	
			22A	93415	Screw—Sump Mtg. Sem (One used in Auxiliary Drive Gear Sump) on Model 92580 to 92599 Series.	MODEL 92500 SERIES PISTON RING SETS:		
				Note:	Use 93032 Screw in the other (5) Sump Mounting Holes.	Note:	For Chrome Piston Ring Set—Standard Size—order Part No. 299742.	
						26	298982	Ring Set—Standard Piston
							298983	Ring Set—.010" O.S. Piston
							298984	Ring Set—.020" O.S. Piston
							298985	Ring Set—.030" O.S. Piston
						27	26026	Lock—Piston Pin

92500 to 92599

REF. NO.	PART NO.	DESCRIPTION	REF. NO.	PART NO.	DESCRIPTION	REF. NO.	PART NO.	DESCRIPTION
28	298909	Pin Assembly—Piston—Standard	66A	393117	Clutch Assembly—Rewind Starter (For engines with Ring Gear on Flywheel equipped for or with Electric Motor)			230870 Shaft—Drive Used on Type No. 0264.
	298908	Pin Assembly—Piston—.005" O.S.						230921 Shaft—Drive Used on Type Nos. 0243, 0244.
29	294201	Rod Assy.—Connecting Note: For Connecting Rod with .020" undersize Crankpin Bore—order No. 296079.	67	212131	Housing—Starter Clutch			230952 Shaft—Drive Used on Type Nos. 0279, 0697.
31	222282	Washer—Connecting Rod Screw _ (One for Each Screw)	67A	261453	Housing—Rewind Starter Clutch (For engines with Ring Gear on Flywheel equipped for or with Electric Motor)			230987 Shaft—Drive Used on Type No. 0880.
32	92296	Screw—Connecting Rod	68	63770	Ball—Clutch	83A	230856	Gear—Drive Note: 230906 Gear—Drive Used on Type No. 0668.
33	296676	Valve—Exhaust	69	66718	Washer—Thrust Note: 68938 Washer—Thrust Used on Type No. 0668.	86	221780	Cover—Sump
34	296677	Valve—Intake	69A	66718	Washer—Thrust	87	391484	Seal—Oil
35	260552	Spring—Intake Valve	70	298436	Ratchet—Rewind and Wind-up Starter	88	*270328	Gasket—Sump Cover
36	26478	Spring—Exhaust Valve	70A	298799	Ratchet—Rewind Starter Clutch (For engines with Ring Gear on Flywheel equipped for or with Electric Motor)	90	298986	Carburetor Assembly Used on Type Nos. 0110 to 0300.
37	222403	Guard—Flywheel	71	221653	Washer—Clutch Retainer	95	93499	Screw—Throttle Valve Mounting Sem
40	93312	Retainer—Valve Spring	73	221661	Screen—Starter Pulley	96	211203	Valve—Throttle Note: 211237 Valve—Throttle Used on Type Nos. 0711, 0712, 0714, 0821, 0837, 0838, 0841.
45	230173	Tappet—Valve	74	93490	Screw—Sem Note: 93042 Screw—Sem (For engines with Ring Gear on Flywheel equipped for or with Electric Motor)	97	298821	Shaft and Lever—Throttle
46	210453	Gear—Cam Note: 211337 Gear—Cam Used only on Model 92590 to 92599 Series	75	220865	Washer—Spring	108	298819	Valve—Choke Note: 68638 Valve—Choke Used on Type Nos. 0711, 0712, 0714, 0821, 0837, 0838, 0841.
46A	298803	Cam Gear, Worm and Oil Slinger Assembly Note: 299563 Cam Gear Worm and Oil Slinger Assy. Used on Type No. 0668.	76	68238	Washer—Ratchet Sealing	108A	280178	Valve—Choke
47	294652	Oil Slinger Gear and Bracket	81	223256	Lock—Muffler Screw (Used after Code No. 81060408) Note: 222237 Lock—Muffler Screw (Used before Code No. 81060508)	109	68628	Shaft and Lever—Choke
52	*270345	Gasket—Intake Elbow				114	66594	Gasket—Needle Valve Nut
54	93485	Screw—Intake Elbow Mounting				116	65978	Packing—Needle Valve
56	280117	Pulley—Rewind Starter				116A	280203	O-Ring
57	294303	Spring—Rewind Starter				117	230590	Nut—Needle Valve
58	66694	Rope—Rewind Starter—48-5/8" long Note: If longer rope is needed, order No. 66684 and cut to required length.				118	23433	Valve—Needle
59	230228	Pin—Starter Rope	83	230831	Shaft—Drive Note: 230860 Shaft—Drive Used on Type Nos. 0157, 0203, 0259, 0815.	120	92290	Washer—Lock—No. 10 x 1/16 x 3/64"
60	393152	Grip—Starter Rope						
61	68618	Bumper—Starter Pulley (Used with Steel Pulley only)						
65	93587	Screw—Vertical Pull—Starter Mounting						
66	298310	Clutch Assy.—Rewind and Wind-up Starter						

*Included in Gasket Set—Part No. 298989.

92500 to 92599

REF. NO.	PART NO.	DESCRIPTION	REF. NO.	PART NO.	DESCRIPTION	REF. NO.	PART NO.	DESCRIPTION
125	390064	Carburetor Assembly Used on Type Nos. 0600 and up. Note: 390833 Carburetor Assembly Used on Type Nos. 0711, 0712, 0714, 0821, 0837, 0838, 0841.	201	260878	Link—Governor Note: 261027 Link—Governor Used on Model 92505, 92508, 92585, 92588, 92595, 92598 Series, Also with Zinc Flywheel.			0728, 0729, 0737, 0739, 0750, 0751, 0752, 0764, 0767, 0785, 0789, 0806, 0816, 0818, 0821, 0824, 0831, 0835, 0837, 0838, 0841, 0842, 0843, 0844, 0847, 0852, 0853, 0854, 0856, 0862, 0863, 0864, 0870, 0890, 0893, 0894, 0896, 0919, 0921, 0926, 0933, 0946, 0955, 0956, 0958, 0961, 0998, 1017, 1023, 1026, 1046, 1047, 1067, 1072, 1075, 1076, 1081, 1094, 1096.
125A	393112	Carburetor Assembly (Minlon Body) Note: 395419 Carburetor Assembly Used only with Parts listed under Ref. 8 Note.	209	260875	Spring—Governor For 3400 to 3600 RPM Top Speed Set-No Load Note: 260876 Spring— Governor For 3900 to 4100 RPM Top Speed Set-No Load Used on Type Nos. 0143, 0149, 0153, 0154, 0155, 0156, 0157, 0161, 0165, 0166, 0172, 0174, 0178, 0180, 0190, 0192, 0195, 0197, 0200, 0201, 0203, 0206, 0210, 0211, 0212, 0222, 0223, 0226, 0234, 0257, 0258, 0259, 0270, 0271, 0679, 0709, 0716, 0717, 0734, 0744, 0747.			261034 Spring— Governor For 2900 to 3100 RPM Top Speed Set-No Load Used on Type Nos. 0704, 0705, 0730, 0732, 0745, 0749, 0759, 0760, 0763, 0768, 0771, 0773, 0774, 0775, 0776, 0787, 0793, 0794, 0795, 0798, 0801, 0813, 0822, 0825, 0832, 0833, 0834, 0858, 0868, 0871, 0922, 0939, 0957, 0965, 0990, 1002, 1010, 1020, 1044, 1064, 1089, 1093.
131	299977	Shaft and Lever— Throttle						261060 Spring— Governor For 3100 to 3300 RPM To Speed Set-No Load Used on Type Nos. 0625, 0627, 0628, 0671, 0706, 0707, 0719, 0720, 0749, 0753, 0762, 0769, 0781, 0783, 0784, 0829, 0830, 0839, 0840, 0846, 0849,
131A	393003	Shaft and Lever— Throttle (Minlon Carb.)						
141	68908	Shaft—Choke						
147	230591	Seat—Needle Valve						
148	22235	Washer—Needle Valve (2)						
149	26336	Spring—Needle Valve						
151	93524	Screw—Machine, Rd. Hd.—5-40 x 1/2"						
152	260746	Spring—Throttle Adj.						
163	271139	Gasket—Air Cleaner Mounting						
163A	270621	Gasket—Air Cleaner Mounting						
180	393113	Tank Assembly—Fuel Used on Type Nos. 0600 and up.						
180A	298475	Tank Assembly—Fuel Used on Type Nos. 0110 to 0300.						
181	298425	Cap—Fuel Tank						
187	296476	Pipe—Fuel						
187A	393001	Pipe—Fuel (Minlon Body)						
188	93585	Screw—Fuel Tank and Starter Mounting						
188A	93444	Screw—Hex. Hd. Sem						
190	93440	Screw—Fuel Tank Mounting Sem						
191	*270250	Gasket—Fuel Tank Mounting						
200	68388	Blade—Governor						

*Included in Gasket Set—
Part No. 298989.

92500 to 92599

REF. NO.	PART NO.	DESCRIPTION	REF. NO.	PART NO.	DESCRIPTION	REF. NO.	PART NO.	DESCRIPTION
	0861, 0880, 0884, 0898, 0910, 0911, 0914, 0917, 0918, 0930, 0934, 0942, 0959, 0969, 0970, 0971, 0972, 0974, 1004, 1021, 1024, 1037, 1038, 1042, 1048, 1054, 1055, 1059, 1065, 1066, 1079, 1080, 1083, 1087, 1088, 1090, 1091, 1092.							
	261061 Spring—Governor For 3600 to 3800 RPM Top Speed Set-No Load Used on Type Nos. 0687, 0738, 0812, 0819, 0845, 0850, 0851, 0857, 0897, 0920, 0931, 0991, 0999, 1009, 1011, 1050.							
	261105 Spring—Governor For 3000 to 3200 RPM Used on Type Nos. 0643, 0644, 0672, 0688, 0693, 0710, 0731, 0743, 0755, 0775, 0778, 0779, 0782, 0788, 0790, 0791, 0792, 0796, 0799, 0800, 0802, 0805, 0815, 0817, 0826, 0827, 0828, 0848, 0859, 0860, 0874, 0877, 0882, 0883, 0885, 0886, 0904, 0944, 0947, 0948, 0949, 0950, 0960, 0977, 0981, 0983, 0988, 1005, 1008, 1013, 1015, 1018, 1030, 1039, 1040, 1041, 1060, 1062, 1069, 1070, 1074.							
					261106 Spring—Governor For 2800 to 3000 RPM Used on Type Nos. 0780, 0855, 1003, 1027, 1052, 1068, 1078.			
					261312 Spring—Governor For 2400 to 2600 RPM Used on Type Nos. 0951, 0952, 0953, 0954, 0985, 0986, 1000, 1001.			
					261419 Spring—Governor For 2500 to 2700 RPM Used on Type No. 1033.			
			265	22372	Clamp—Casing			
			267	93469	Screw—Clamp Mtg.			
			268	66986	Casing—Control Wire—48" long Note: If longer casing is needed, specify length in inches; if a shorter casing is needed, order No. 66986 and cut to required length.			
			269	26099	Wire—Control, 54" long Note: If longer wire is needed, specify length in inches; if shorter wire is needed, order No. 26099 and cut to required length.			
			270	63426	Locknut—Control Wire Casing			
			271	290568	Lever Assy.—Control			
			284	93572	Screw—Clamp Mtg.			
			298	220859	Locknut—Muffler			
			299	392811	Muffler—Exhaust			
			300	298830	Muffler—Exhaust Note: 29807 Muffler 220859 Locknut—Muffler 91943 Elbow—Exhaust Used on Type No. 0164.			
								299106 Muffler—Exhaust Used on Type Nos. 0155, 0157, 0203, 0234, 0243, 0244, 0249, 0250, 0259, 0268, 0270, 0273, 0279, 0688, 0694, 0695, 0696, 0697, 0711, 0712, 0713, 0714, 0739, 0752, 0755, 0764, 0815, 0821, 0827, 0835, 0837, 0838, 0841, 0843, 0847, 0853, 0854, 0856, 0859, 0878, 0880, 0889, 0930.
								391435 Muffler—Exhaust Used on Type Nos. 0844, 0861, 0877, 0881, 0893, 0894, 0897, 0898, 0901, 0902, 0904, 0906, 0907, 0908, 0910, 0911, 0913, 0914, 0916, 0917, 0918, 0921, 0928, 0931, 0935, 0941, 0948, 0951, 0952, 0953, 0954, 0959, 0961, 0962, 0967, 0968, 0972, 0976, 0977, 0984, 0990.
								394569 Muffler—Exhaust Used on Type Nos. 0605, 0606, 0970, 0971, 0973, 0974, 0975, 0979, 0985, 0986, 0987, 0989, 0991, 0992, 0995, 0999, 1000, 1001, 1005, 1009, 1013, 1021, 1022, 1026, 1028, 1031, 1033, 1034, 1047, 1050, 1058, 1061, 1063, 1065, 1067, 1072, 1081, 1082, 1085, 1086, 1087.

92500 to 92599

REF. NO.	PART NO.	DESCRIPTION	REF. NO.	PART NO.	DESCRIPTION	REF. NO.	PART NO.	DESCRIPTION
300A	394644	Muffler—Exhaust (Used after Code No. 81060408)	325	298731	Starter Pulley with Screen	375	294628	Breaker Points and Condenser Set
	Note:	391025 Muffler Exhaust (Used before Code No. 81060508)	329	93294	Screw—Sem		Note:	299061 Ignition Kit
		393400 Muffler—Exhaust Used on Type Nos. 1003, 1018, 1030, 1059, 1074, 1093.	330	395022	Rope—Starter		Includes:	294628 Point Set
303	91943	Elbow—Exhaust	331	220865	Washer—Flywheel	377	93065	Key—Woodruff No. 6
304		Housing—Blower For Type Numbers not listed below, see Ref. No. 608.	332	92284	Nut—Flywheel		Note:	93061 Key—Woodruff Used on Type No. 0953.
	Note:	298467 Housing—Blower (For Rope Starter) Used on Model 92501 Series.	333	298502	Armature—Magneto	382	93545	Screw—Choke Link Cover
		298570 Housing—Blower (For Wind-up Starter) Used on Model 92506, 92596 Series.	334	93381	Screw—Armature Mounting Sem	382A	93864	Screw—Choke Link Cover (Minlon Body)
		390279 Housing—Blower (For Vertical Pull and Electric Starter) Used on Model 92505, 92508, 92585, 92588, 92595, 92598 Series.	335	93435	Screw—Armature and Governor Blade Mounting Sem	383	89838	Wrench—Spark Plug
305	93559	Screw—Blower Housing Mounting Sem	337	298809	Plug—Spark 1-1/2" High— (37-42 mm.)	392	261016	Spring—Diaphragm
306	221805	Shield—Cylinder		Note:	29693 Plug—Spark 2" High—(51 mm.)		Note:	261015 Spring—Diaphragm Used on Type Nos. 0711, 0712, 0714, 0821, 0837, 0838, 0841.
307	93490	Screw—Cylinder Shield and Rotating Screen Mounting Sem	340	26018	Spring—Breaker Arm	394	299637	Diaphragm—Carburetor
309	391551	Motor—Starter	341	93381	Screw—Breaker Arm Mounting Sem		Note:	390834 Diaphragm—Carburetor Used on Type Nos. 0711, 0712, 0714, 0821, 0837, 0838, 0841.
310	93774	Bolt—Starter Motor (3" Long)	342	65704	Plunger—Breaker Point	396	270571	Gasket—Choke Link Cover
	Note:	93609 Bolt—Starter Motor (2-3/4" Long)	344	93042	Screw—Condenser Clamp Mounting Sem	397	211678	Cover—Choke Link Control—Dial
311	390204	Brush Kit—Starter Motor	345	220366	Cover—Breaker Point and Condenser	409	299839	Link—Control
324	223006	Screen—Rotating (Used after Code No. 79092328).	346	93705	Screw—Dust Cover Mounting	410	260993	Screw—Sem
	Note:	222063 Screen—Rotating (Used before Code No. 79092428).	356	298479	Wire—Ground	423	93599	Bracket—Oil Fill Tube Cup, Spring and Release Assembly
				Note:	298581 Wire—Ground Used on Type Nos. 0812, 0873, 0903, 1028.	455	297542	Handle Assy.—Cranking
					299500 Wire—Ground Used on Type No. 1085.	458	298431	Pawl—Ratchet
			358	298989	Gasket Set	459	221332	Retainer—Ratchet Pawl
			363	19069	Puller—Flywheel (Optional Accessory)	460	93272	Screw—Handle Mtg.
			372	220477	Clamp—Condenser	461	93298	Washer—Handle Mtg.
			374	92813	Washer—Lock—Shakeproof	462	221237	Knob—Dial Control
						467	299858	Screw—Sem
						508	93158	Clutch Assembly—Electric Starter
						513	390074	Spring—Ratchet Pawl
						515	260537	Spring—Connector (Condenser Post)
						516	260374	

92500 to 92599

REF. NO.	PART NO.	DESCRIPTION	REF. NO.	PART NO.	DESCRIPTION	REF. NO.	PART NO.	DESCRIPTION
517	390042	Starter Pulley with Screen	536A	298566	Cleaner Assembly—Air (1—Slanted Side)		390274	Starter Assy.—Rewind (1:30 o'clock)
523	391838	Cap with Dipstick—Oil Filler		Note:	Replaced By			Used on Type Nos.
	Note:	For complete Oil Fill Cap with Dipstick and Oil Filler Tube Assy.—order Part 392055.			390055 Air Cleaner Assembly			0148, 0153, 0154, 0155, 0156, 0157, 0167, 0182, 0193, 0211, 0213, 0218, 0229, 0243, 0245, 0247, 0249, 0255, 0258, 0265, 0266, 0268, 0270, 0273, 0274, 0278, 0279, 0625, 0627, 0628, 0643, 0644, 0670, 0682, 0683, 0684, 0686, 0689, 0691, 0693, 0694, 0695, 0697, 0698, 0735, 0738, 0743, 0750, 0753, 0756, 0764, 0765, 0766, 0772, 0773, 0775, 0780, 0781, 0782, 0783, 0787, 0789, 0790, 0791, 0799, 0801, 0803, 0811, 0822, 0824, 0827, 0828, 0829, 0835, 0839, 0842, 0843, 0846, 0847, 0850, 0852, 0854, 0855, 0856, 0857, 0858, 0865, 0866, 0867, 0878, 0879, 0881, 0882, 0884, 0885, 0889, 0890, 0897, 0909, 0910, 0912, 0914, 0916, 0917, 0929, 0956, 0959, 0967, 0970, 0971, 0972, 0973, 0980, 0982, 0988, 0991, 0994, 0996, 1008, 1017, 1021, 1022, 1036, 1037, 1043, 1067, 1072, 1081, 1086, 1090.
523A	392055	Cap with Dipstick—Oil Filler (Complete Oil Fill Cap with Dipstick and Oil Filler Tube Assy.)	544	391667	Armature—Starter (4-1/16" Long)			
523B	298664	Cap with Dipstick—Oil Filler		Note:	390206 Armature—Starter (3-13/16" Long)			
	Note:	For complete Oil Fill Cap with Dipstick and Oil Filler Tube Assy.—order Part 298684.	548	390208	Washer Set—Starter Motor			
524	68838	Seal—Filler Tube	592	90356	Nut—Hex.—10-24			
524A	270306	Seal—Tube (Used between Tube and Sump)	608	390270	Starter Assy.—Rewind (12 o'clock)			
525	280131	Tube—Oil Filler		Note:	298601 Starter Assy.—Rewind (4 o'clock)			
525A	392055	Tube—Oil Filler (Complete Oil Fill Cap with Dipstick and Oil Filler Tube Assy.)			Used on Type Nos.			
525B	298663	Tube—Oil—Fill			0180, 0201, 0709, 0895, 0989, 1011, 1016, 1032, 1066.			
527	222548	Clamp—Oil Filler Tube			390268 Starter Assy.—Rewind (10 o'clock)			
527A	222064	Tube Clamp			Used on Type Nos.			
529	67838	Grommet—Breather (Used only with Metal Breather Tube Ref. 11.)			0133, 0135, 0136, 0147, 0149, 0151, 0161, 0162, 0165, 0168, 0169, 0172, 0175, 0176, 0183, 0185, 0188, 0189, 0192, 0200, 0204, 0205, 0210, 0212, 0215, 0217, 0222, 0223, 0224, 0226, 0227, 0238, 0242, 0253, 0262, 0264, 0267, 0276, 0673, 0674, 0685, 0701, 0703, 0708, 0716, 0719, 0722, 0724, 0725, 0734, 0748, 0754, 0760, 0771, 0861, 0892, 0932, 0941, 0966, 1006, 1009, 1015, 1019, 1026, 1027, 1031, 1044, 1056, 1057, 1073, 1077, 1078, 1084, 1088.			
534	93865	Screw—Air Cleaner						
534A	93374	Screw—Air Cleaner						
535	270579	Element—Air Cleaner (2—Slanted Sides) Used on Type Nos. 0600 and up.						
535A	270251	Element—Air Cleaner (1—Slanted Side) Used on Type Nos. 0110 to 0300.						
536	390055	Cleaner Assembly—Air (2—Slanted Sides)						
	Note:	For Dual Element Air Cleaner Kit Order No. 393018						

92500 to 92599

REF. NO.	PART NO.	DESCRIPTION	REF. NO.	PART NO.	DESCRIPTION	REF. NO.	PART NO.	DESCRIPTION	
	390280	Starter Assy.— Rewind (3 o'clock) Used on Type Nos. 0143, 0144, 0159, 0160, 0170, 0171, 0177, 0197, 0208, 0209, 0214, 0220, 0233, 0236, 0237, 0241, 0261, 0263, 0269, 0275, 0277, 0605, 0606, 0675, 0679, 0680, 0681, 0690, 0692, 0699, 0700, 0707, 0711, 0712, 0720, 0721, 0728, 0737, 0761, 0763, 0770, 0778, 0792, 0793, 0795, 0796, 0808, 0813, 0817, 0825, 0826, 0831, 0832, 0833, 0834, 0836, 0841, 0860, 0868, 0871, 0872, 0874, 0876, 0880, 0891, 0900, 0902, 0905, 0906, 0907, 0908, 0913, 0920, 0922, 0923, 0924, 0927, 0928, 0931, 0933, 0936, 0945, 0948, 0949, 0955, 0957, 0958, 0960, 0961, 0962, 0963, 0964, 0965, 0969, 0976, 0977, 0978, 0979, 0983, 0987, 0992, 0995, 1002, 1004, 1005, 1010, 1013, 1014, 1023, 1024, 1034, 1035, 1039, 1040, 1042, 1046, 1048, 1049, 1051, 1052, 1054, 1055, 1059, 1061, 1062, 1063, 1064, 1068, 1069, 1070, 1074, 1075, 1076, 1079, 1082, 1089, 1091, 1092, 1093, 1094, 1096.			390571	Starter Assy.— Rewind (8 o'clock) Used on Type Nos. 0786, 0981, 0984, 0993, 1003, 1018, 1060. 391477 Starter Assy.— Rewind (6 o'clock) Used on Type Nos. 0146, 0178, 0202, 0251, 0915, 0919, 0939, 0968, 0975, 0999, 1025, 1041, 1095.			0942, 0965, 0967, 1008, 1012, 1021, 1022, 1025, 1027, 1036, 1037, 1044, 1057, 1072, 1073, 1077, 1078, 1086, 1088, 1091.
			613	93935	Screw—Muffler Mtg. (Used after Code No. 81060408) Note: 93549 Screw— Muffler Mtg. (Used before Code No. 81060508)	620A	390199	Carburetor Control Plate and Harness Plug Bracket Used on Type Nos. 0600 and up with Electric Starters. Note: 390200 Carburetor Control Plate and Harness Plug Bracket Used on Type Nos. 0654, 0659, 0664, 0820.	
			617	270344	Seal—Intake Tube	620B	298823	Plate—Carburetor Control Used on Type Nos. 0110 to 0300: Note: 298837 Plate— Carburetor Control Used on Type Nos. 0134, 0139, 0147, 0151, 0158, 0161, 0164, 0168, 0172, 0175, 0176, 0177, 0182, 0195, 0205, 0212, 0214, 0217, 0218, 0221, 0224, 0225, 0228, 0237, 0240, 0241, 0242, 0254. 298652 Control Assy.— Dial Uses: 93475 Screw—Sem (Mounting to Blower Housing) Includes: 93461 Screw—Swivel 230821 Pin—Swivel 260846 Link—Control 260867 Washer— Swivel Pin Used on Type Nos. 0185, 0193, 0194, 0243, 0244, 0245, 0246, 0249, 0250.	
			618	260870	Spring—Choke Return				
			620	299974	Plate—Carburetor Control Used on Type Nos. 0500 and up, except those with Electric Starters. Note: 299975 Plate— Carburetor Control Used on Type Nos. 0643, 0644, 0652, 0655, 0656, 0657, 0660, 0661, 0662, 0665, 0666, 0673, 0682, 0700, 0711, 0712, 0716, 0737, 0746, 0747, 0754, 0758, 0762, 0769, 0783, 0787, 0790, 0797, 0807, 0811, 0814, 0827, 0831, 0836, 0841, 0842, 0845, 0846, 0847, 0849, 0850, 0854, 0855, 0857, 0860, 0864, 0867, 0868, 0876, 0878, 0879, 0880, 0882, 0883, 0885, 0890, 0897, 0899, 0909, 0914, 0917, 0924, 0927,	621	297472	Switch—Stop	

92500 to 92599

REF. NO.	PART NO.	DESCRIPTION	REF. NO.	PART NO.	DESCRIPTION	REF. NO.	PART NO.	DESCRIPTION
625	298775	Tube—Fuel Intake	681A	395508	Needle Valve Kit (Nylon Body)	789	390207	Wiring Harness Assy.—Mower
634	270167	Washer—Throttle Shaft (Felt)	720	93474	Pin—Gear to Shaft			(55" long with 32" long side lead wire— for switch on handle)
635	66538	Elbow—Spark Plug	721	221779	Stop—Drive Shaft			Note: 390372 Wiring Harness Assy.—Mower
643	222991	Cup—Air Cleaner	727	211757	Cover—Electric Starter			(12" long with 8" long side lead wire— for switch on deck)
645	23513	Bushing—Plunger	764	391486	Starter Assembly— Vertical Pull			
646	222086	Bracket—Electric Starter Mounting		Note: 392851	Starter Assy.— Side Pull			
655	222057	Anchor—Spring			Used on Type Nos. 1058, 1071, 1080.	790	390123	Battery—Electric Starter
665	296768	Oil Minder	765	299947	Housing—Vertical Pull Starter			(G.E. No. 41B00- ILD09)
666	299992	Gauge—Fuel Level Used only on Type Nos. 0600 and up.		Note: 393011	Housing—Side Pull Starter			Uses: B & S No. 391999 Battery Terminal
666A	297073	Gauge—Fuel Level Used only on Type Nos. 0110 to 0300.	766	280022	Pulley—Rope (Small)			(G.E. No. 152B5421- 121)
670	93912	Spacer—Fuel Tank	767	231048	Pin—Small Rope Pulley (7/16" Long)			392000 Charger Terminal
670A	211412	Spacer—Fuel Tank		Note: 93586	Pin—Small Rope Pulley (7/8" Long)			(G.E. No. 251A6695- G1)
673	93705	Screw—Receptacle. Retainer	768	299948	Pulley and Gear Assy.			Note: If this Battery does not fit, refer to Equip- ment Manufacturer.
674	93559	Screw—Tank to Bracket	769	66734	Rope—Vertical Pull Starter			791 390197 Charger—Battery (110 volt)
675	93408	Washer—Starter Housing Spring		Note: 66904	Rope—Starter (79")			Note: 390733 Charger— Battery (220 volt— 50 cycle)
676	221794	Deflector—Muffler (Side Outlet)	771	299961	Clip—Starter			792 390137 Bracket Assembly— Battery Mounting
	Note: 221861	Deflector— Exhaust	772	93598	Screw—Sem			793 261049 Clip—Wiring Harness
		Used on Type Nos. 0896, 0946.	773	390112	Retainer Assembly— Spur Gear			795 390122 Switch Assy.— Starter—Ignition
	393760	Deflector— Exhaust	774	280121	Insert—Starter Handle			Note: 390128 Switch Assy.— Starter—Ignition (less Housing)
	Uses:		775	280036	Grip—Starter Rope			Used on Type No. 0751.
	93705	Screw—Muffler	776	222049	Guide—Rope			797 390201 Nut Set
		Used on Type Nos. 0921, 0938, 0984, 0985, 0986, 0987, 0989, 0990, 1000, 1001, 1013, 1026, 1028, 1033, 1034, 1058, 1061, 1082, 1085, 1087.	777	390066	Spring—Starter			798 394304 Key Set—Starter Switch
676A	222238	Deflector—Exhaust (Side Outlet)	778	280021	Cover—Starter			799 211773 Housing—Starter Switch
677	93606	Screw—Muffler Deflector and Harness Retainer	781	280034	Cap—Electric Starter Pulley			800 222212 Retainer—Switch Receptacle
677A	93705	Screw—Muffler Deflector	782	280038	Gear—Electric Starter Spur			801 390202 Motor Output End Cover and Mounting Bracket
679	270382	Washer—Choke Shaft (Felt)	783	230960	Gear—Electric Starter Pinion			802 390203 Cap Assembly—End
680	221839	Washer—Choke Shaft	784	222085	Cover—Electric Starter Clutch Gear			
681	299060	Needle Valve Kit	785	270610	Gasket—Electric Starter Clutch Gear Cover			
			786	390102	Harness—Starter Motor (Cylinder Head End)			
			787	222088	Retainer—Harness Plug			

92500 to 92599

REF. NO.	PART NO.	DESCRIPTION	REF. NO.	PART NO.	DESCRIPTION	REF. NO.	PART NO.	DESCRIPTION
803	391668	Housing—Starter (2-9/16" Long)	837	222241	Spacer—Muffler Mtg.	869	210879	Seat—Intake Valve (Standard)
	Note: 390205	Housing—Starter (2-5/16" Long)	842	270920	Seal—Oil Filler Cap	870	211291	Seat—Exhaust Valve (Standard)
			847	392055	Fill Group—Oil	871	63709	Guide—Exhaust Valve
			851	221798	Terminal—Ignition Cable	883	270774	Gasket—Exhaust