



12H800

Illustrated Parts List

Model Series

12H800

TYPE NUMBERS
0652 through 6699.

TABLE OF CONTENTS

- Alternator 7
- Air Cleaner 4
- Blower Housing/Shrouds 6
- Camshaft 2
- Carburetor 3
- Controls 5
- Crankshaft 2
- Cylinder 2
- Electric Starter 7
- Electrical 7
- Engine Sump 2
- Exhaust System 4
- Flywheel 7
- Flywheel Brake 7
- Fuel Supply 5
- Governor Spring 5
- Ignition 7
- Kits/Gaskets 2 & 3
- Lubrication 2
- Piston Group 2
- Rewind Starter 7
- Valves 2



PRINTED IN U.S.A.

COPYRIGHT by BRIGGS & STRATTON CORPORATION
All rights reserved. No part of this material may be reproduced or transmitted, in any form or by any means, electronic or mechanical, including photocopying, recording or by any information storage and retrieval system, without permission in writing from Briggs & Stratton Corporation.

12H800

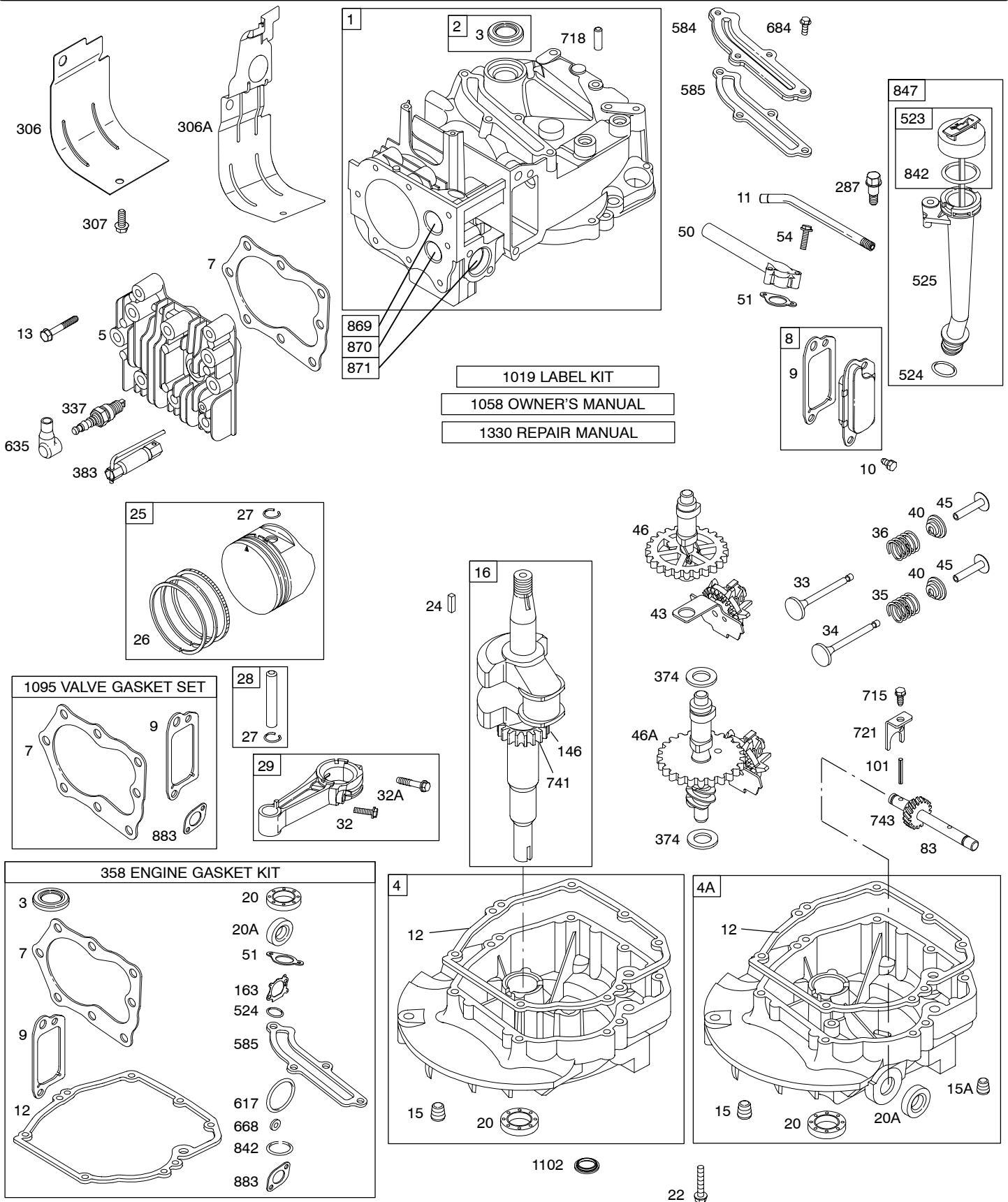

Illustrations cover a range of engines. Parts shown without corresponding text may not be used on your specific engine.
 0990-2 Assemblies include all parts shown in frames. 09/27/2005

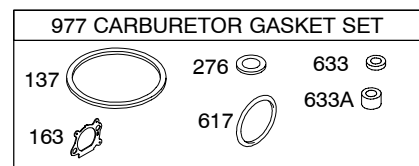
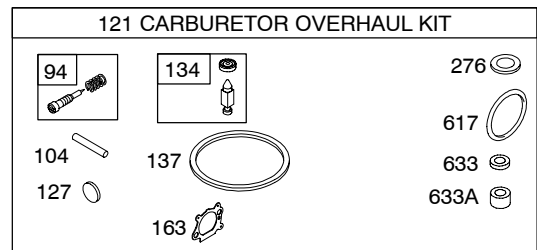
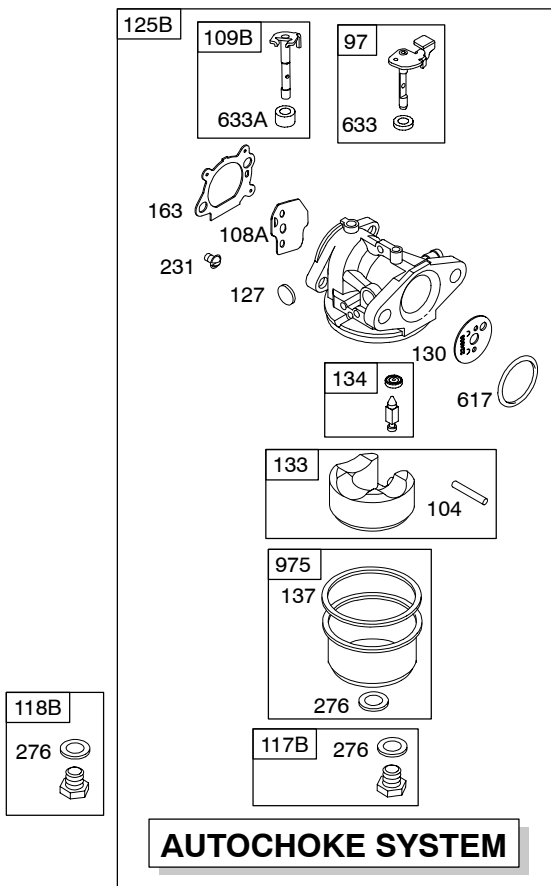
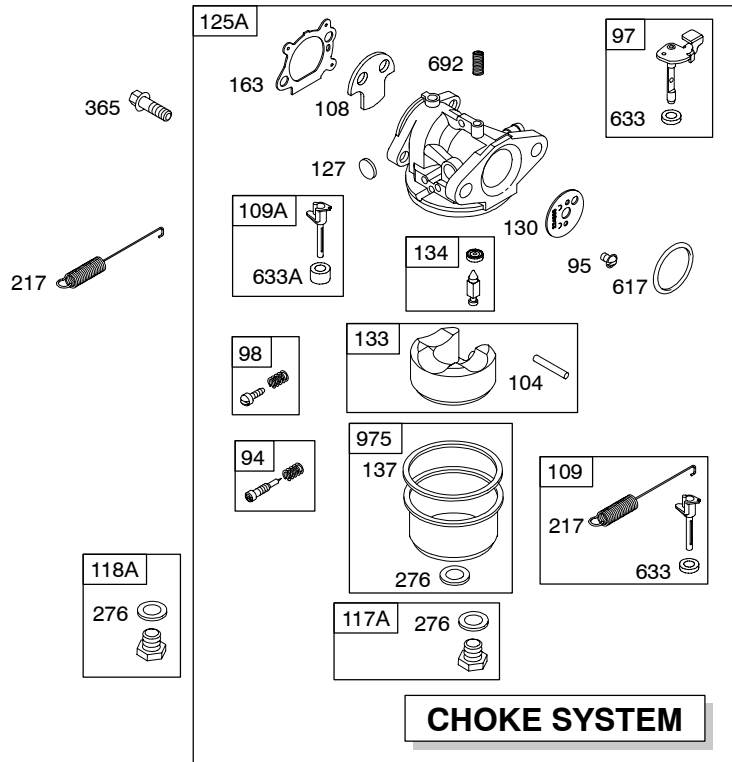
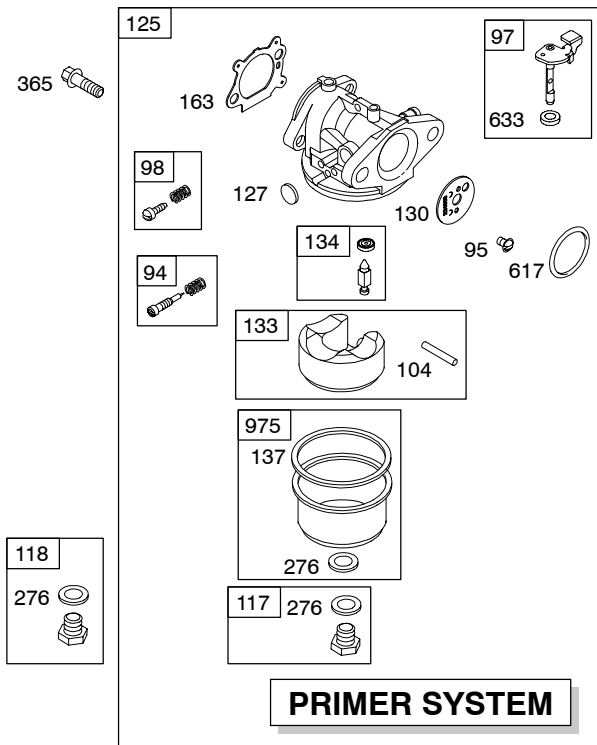

Illustrations cover a range of engines. Parts shown without corresponding text may not be used on your specific engine.
 0990-3 Assemblies include all parts shown in frames. 09/27/2005

12H800

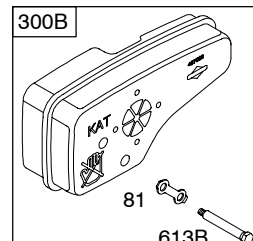
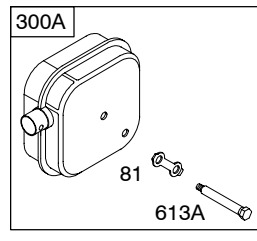
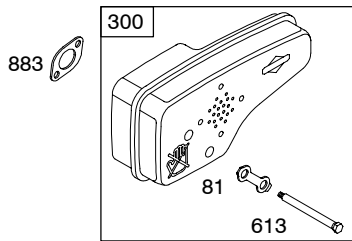
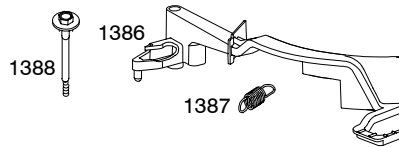
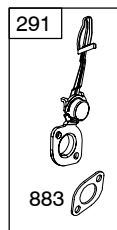
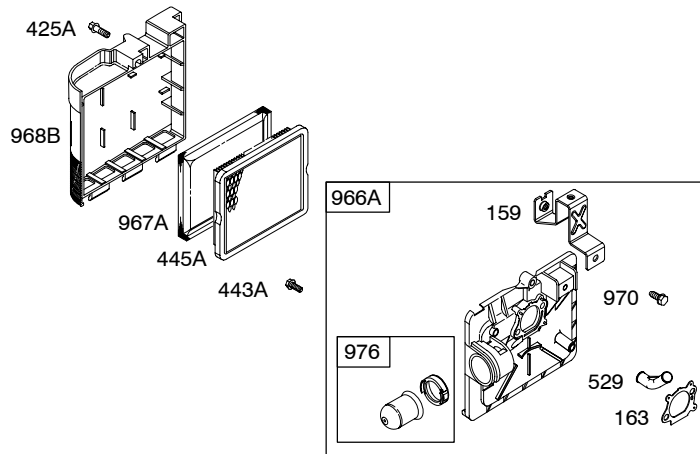

836A

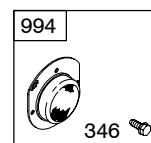
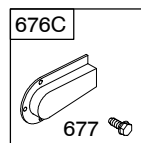
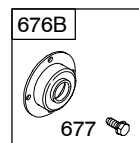
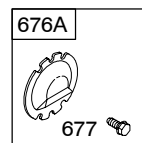
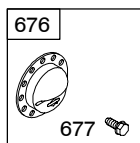
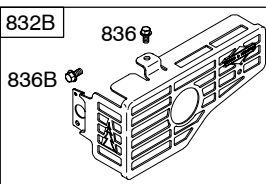
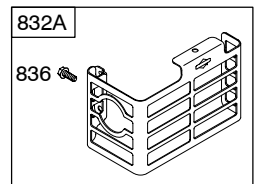
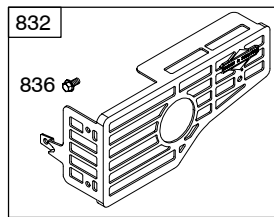

Illustrations cover a range of engines. Parts shown without corresponding text may not be used on your specific engine.
 0990-4 Assemblies include all parts shown in frames. 09/27/2005

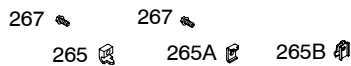
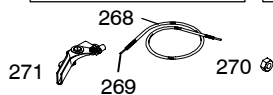
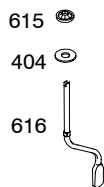
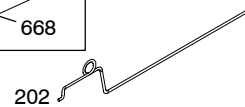
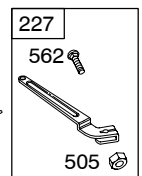
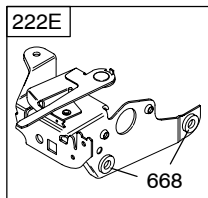
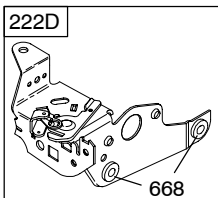
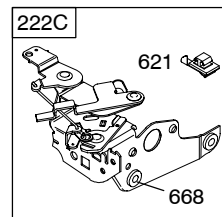
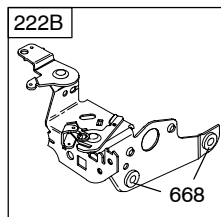
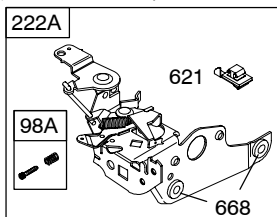
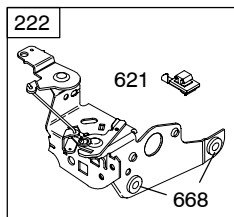
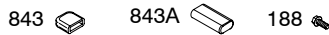
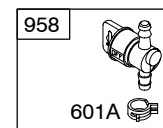
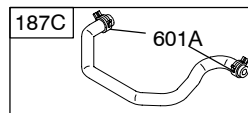
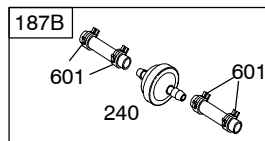
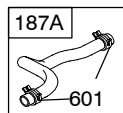
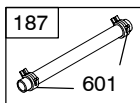
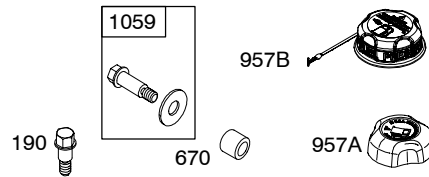
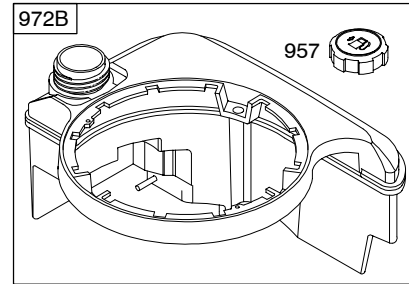
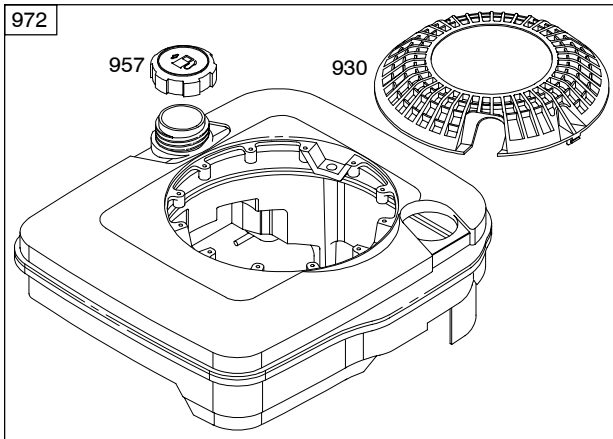

Illustrations cover a range of engines. Parts shown without corresponding text may not be used on your specific engine.
 0990-5 Assemblies include all parts shown in frames. 09/27/2005

12H800

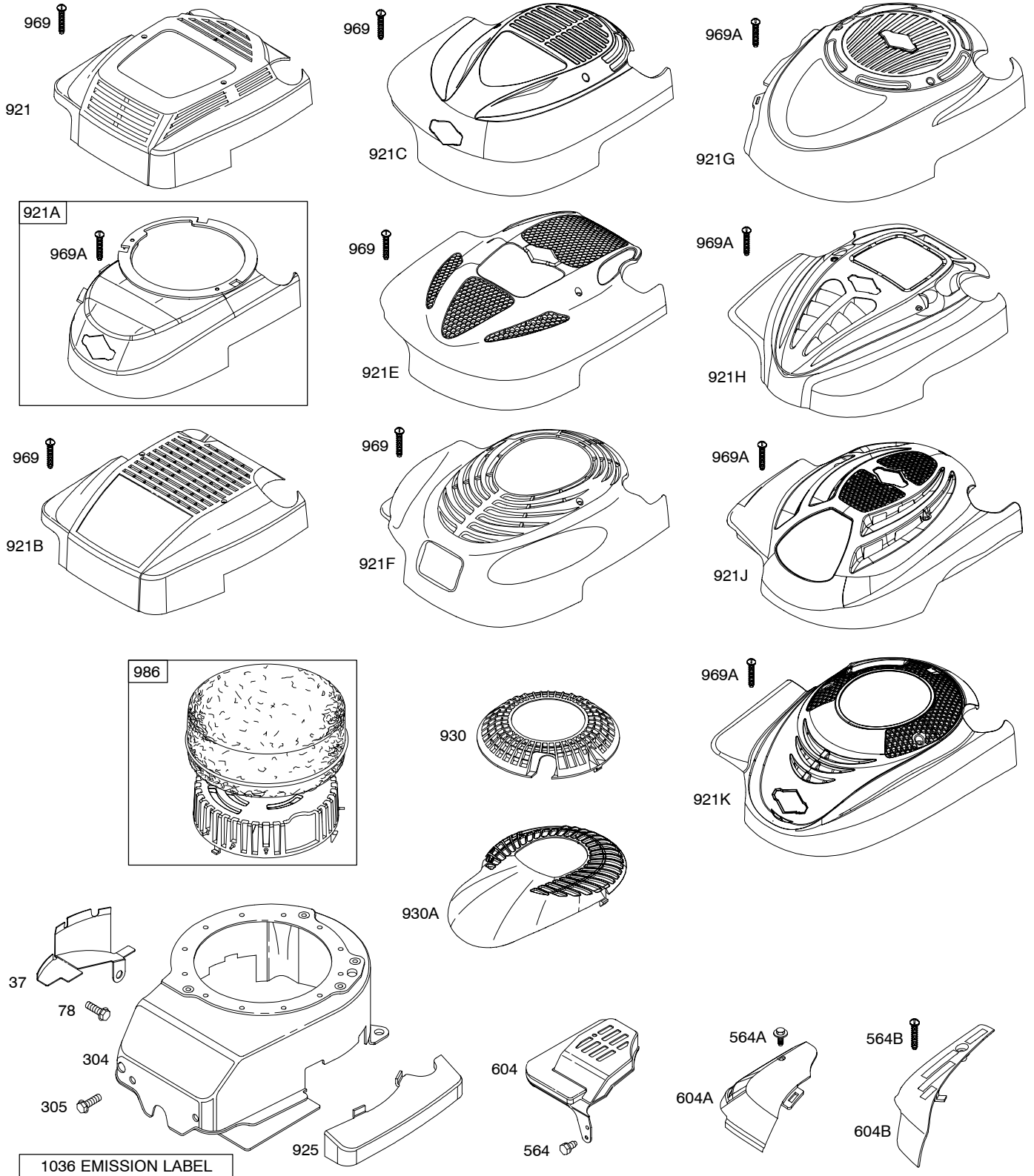

Illustrations cover a range of engines. Parts shown without corresponding text may not be used on your specific engine.
 0990-6 Assemblies include all parts shown in frames. 09/27/2005

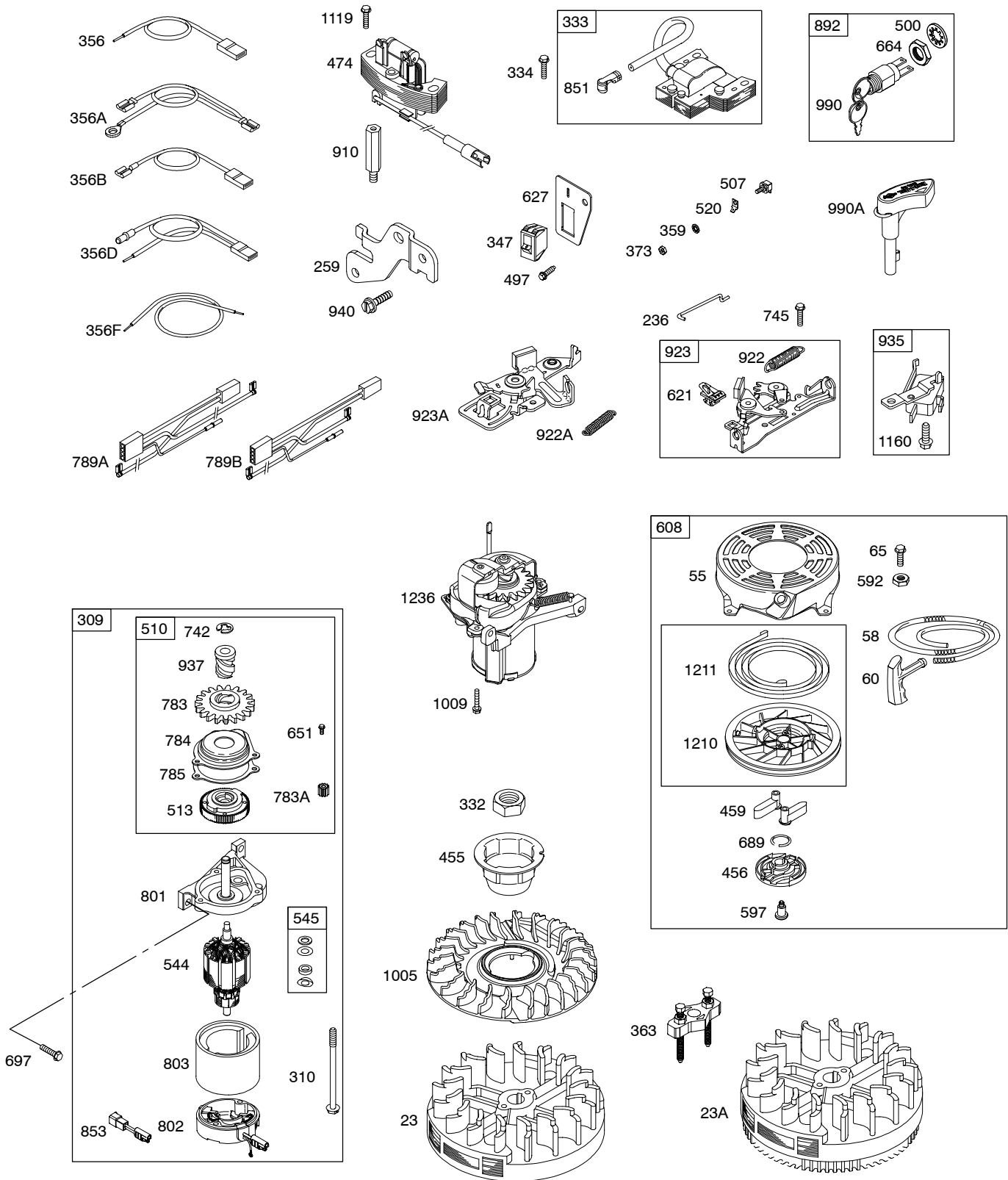

Illustrations cover a range of engines. Parts shown without corresponding text may not be used on your specific engine.
0990-7 Assemblies include all parts shown in frames. 09/27/2005

12H800

| REF. NO. | PART NO. | DESCRIPTION | REF. NO. | PART NO. | DESCRIPTION | REF. NO. | PART NO. | DESCRIPTION |
|----------|----------|--|----------|----------|------------------------------|----------|----------|-----------------------------------|
| 1 | 697322 | Cylinder Assembly | 5 | 691160 | Head-Cylinder | 12 | ★692232 | Gasket-Crankcase |
| 2 | 399269 | Kit-Bushing/Seal (Magneto Side) | 7 | ★∅692249 | Gasket-Cylinder Head | 13 | 690912 | Screw (Cylinder Head) |
| 3 | ★299819 | Seal-Oil (Magneto Side) | 8 | 495786 | Breather Assembly | 15 | 691680 | Plug-Oil Drain (Square Socket) |
| 4 | 493279 | Sump-Engine | 9 | ★∅272481 | Gasket-Breather | 15A | 691093 | Plug-Oil Drain (Hex Socket) |
| | | ----- Note ----- | 10 | 94650 | Screw (Breather Assembly) | | | |
| | | 498983 Sump-Engine Used on Type No(s). 1167, 1715, 1955, 1961, 2320, 2324, 2331, 2367, 2673, 2681, 3182. | 11 | 691781 | Tube-Breather | | | |
| | | 696294 Sump-Engine Used on Type No(s). 1375, 1376, 1717, 1718, 1719, 1730, 1731, 1732, 1735, 1754, 1792, 1795, 1809, 1811, 1959, 1960, 1996, 2002, 2326, 3181, 3187, 3188. | | | | | | |
| 4A | 493365 | Sump-Engine (Auxilliary PTO) | | | | | | |

★ Included in Engine Gasket Set-Ref. No.358.

● Included in Carburetor Overhaul Kit-Ref. No. 121.

◆ Included in Carburetor Gasket Set-Ref. No. 977.

∅ Included in Valve Gasket Set-Ref. No 1095.

Illustrations cover a range of engines. Parts shown without corresponding text may not be used on your specific engine.

0990-8

Assemblies include all parts shown in frames.

09/27/2005

12H800

| REF. NO. | PART NO. | DESCRIPTION | REF. NO. | PART NO. | DESCRIPTION | REF. NO. | PART NO. | DESCRIPTION |
|----------|----------|--|----------|----------|---|----------|----------|---|
| 16 | 691451 | Crankshaft (Used After Code Date 97011200). ----- Note ----- 694442 Crankshaft (Used Before Code Date 97011300). 691450 Crankshaft (Used After Code Date 97011200). Used on Type No(s). 0823, 1520, 1530, 1531, 1532, 1533, 1567, 1705, 1718, 1746, 1747, 1769, 1905, 1906, 1907, 1910, 1911, 1912, 1913, 1915, 1916, 1918, 1923, 1939, 1940, 1950, 1951, 1952, 1979, 1980, 1987, 2313, 2375. 2376, 2379, 2380, 2609, 2610, 2611, 2612, 2630, 2631, 2649, 2667, 2677, 2678, 2679, 2686, 3120, 3123, 3138, 3140, 3167, 3176, 3184, 3187, 3188. 694440 Crankshaft (Used Before Code Date 97011300). Used on Type No(s). 0823, 1520, 1530, 1531, 1532, 1533, 1567, 2630, 2631. 692980 Crankshaft (Used After Code Date 97011200). Used on Type No(s). 0658, 0660, 1570, 1758, 1760, 1763, 2670. 694443 Crankshaft (Used Before Code Date 97011300). Used on Type No(s). 0658, 0660, 1758. | | | 691452 Crankshaft (Used After Code Date 97011200). Used on Type No(s). 0664, 0665, 0666, 0670, 0671, 0672, 0680, 0840, 0866, 0868, 0873, 0877, 0878, 1150, 1166, 1170, 1171, 1320, 1326, 1332, 1366, 1368, 1370, 1371, 1372, 1374, 1375, 1376, 1377, 1378, 1544, 1559, 1569, 1723, 1724, 1727, 1730, 1731, 1733, 1734, 1736, 1737, 1738, 1739, 1749, 1770, 1771, 1784, 1785, 1786, 1790, 1794, 1795, 1801, 1803, 1804, 1805, 1810, 1811, 1814, 1816, 1914, 1917, 1919, 1920, 1926, 1932, 1935, 1936, 1941, 1942, 1943, 1947, 1948, 1958, 1959, 1962, 1964, 1965, 1966, 1967, 1970, 1973, 1976, 1977, 1983, 1985, 1988, 1991, 1992, 1993, 1994, 1995, 1996, 2001, 2002, 2006, 2008, 2009, 2010, 2350, 2644, 2669, 2676, 3130, 3132, 3137, 3166, 3169, 3170, 3181, 3185, 3186, 3189, 3313, 3314, 3315, 3320, 3322, 3323, 3325. 694059 Crankshaft (Used Before Code Date 97011300). Used on Type No(s). 0866, 0868, 0873, 0877, 1166, 1170, 1332, 1366, 1368, 1370, 1371, 1544, 1559, 1569, 1977. | | | 691455 Crankshaft (Used After Code Date 97011200). Used on Type No(s). 1149, 1548, 1701, 1925, 2312, 2313, 2314, 2315, 2316, 2324, 2328, 2349, 2352, 2360, 2370, 2373, 2381, 2383, 2384, 2394, 2395, 2396, 3172, 3173, 3180, 3318, 3319. 691375 Crankshaft (Used Before Code Date 97011300). Used on Type No(s). 1149, 1548. 692822 Crankshaft Used on Type No(s). 1766. 691482 Crankshaft Used on Type No(s). 1961, 2329, 2334, 3183. 694079 Crankshaft Used on Type No(s). 1717, 1767, 1768, 1775. 692717 Crankshaft Used on Type No(s). 1955, 1986, 3178. 694478 Crankshaft Used on Type No(s). 1777. 694849 Crankshaft Used on Type No(s). 1714, 1726, 2013, 2349, 2383, 2391, 2635, 2683. 694850 Crankshaft Used on Type No(s). 2331, 2333, 2681. 696009 Crankshaft Used on Type No(s). 1720, 1776, 1778. 696290 Crankshaft Used on Type No(s). 2320. |

★ Included in Engine Gasket Set-Ref. No.358.

● Included in Carburetor Overhaul Kit-Ref. No. 121.

◆ Included in Carburetor Gasket Set-Ref. No. 977.

⊘ Included in Valve Gasket Set-Ref. No 1095.

Illustrations cover a range of engines. Parts shown without corresponding text may not be used on your specific engine.

12H800

| REF. NO. | PART NO. | DESCRIPTION | REF. NO. | PART NO. | DESCRIPTION | REF. NO. | PART NO. | DESCRIPTION |
|----------|----------|--|----------|----------|--|----------|----------|--|
| 20 | ★399781 | Seal-Oil (PTO Side) | 25 | 790359 | Piston Assembly (Standard) (Used After Code Date 04031400). | 26 | 790360 | Ring Set (Standard) (Used After Code Date 04031400). |
| 20A | ★691952 | Seal-Oil (PTO Side) (Auxilliary PTO) | | | ----- Note ----- | | | ----- Note ----- |
| 22 | 691092 | Screw (Crankcase Cover/ Sump) | | 499429 | Piston Assembly (Standard) (Used After Code Date 97011200 and Before Code Date 04031500). | | 499425 | Ring Set (Standard) (Used After Code Date 97011200 and Before Code Date 04031500). |
| 23 | 692315 | Flywheel (Rewind Start) | | 493262 | Piston Assembly (Standard) (Used Before Code Date 97011300). | | 493261 | Ring Set (Standard) (Used Before Code Date 97011300). |
| 23A | 691987 | Flywheel (Electric Start) ----- Note ----- 691992 Flywheel (Electric Start) Used on Type No(s). 0667, 0878, 1149, 1167, 1369, 1548, 1559, 1569, 1701, 1714, 1715, 1726, 1729, 1786, 1802, 1807, 1817, 1919, 1932, 1941, 1942, 1948, 1955, 1961, 1967, 2005, 2009, 2013, 2320, 2324, 2331, 2333, 2349, 2367, 2383, 2391, 2635, 2669, 2673, 2681, 3133, 3178, 3179, 3183, 3324. 696291 Flywheel (Electric Start) Used on Type No(s). 1375, 1376, 1717, 1718, 1719, 1730, 1731, 1732, 1735, 1754, 1792, 1795, 1809, 1811, 1959, 1960, 1996, 2001, 2002, 2326, 3181, 3187, 3188. | | 499430 | Piston Assembly (.010" Oversize) (Used After Code Date 97011200). | | 499426 | Ring Set (.010" Oversize) (Used After Code Date 97011200). |
| | | | | 493385 | Piston Assembly (.010" Oversize) (Used Before Code Date 97011300). | | 493388 | Ring Set (.010" Oversize) (Used Before Code Date 97011300). |
| | | | | 791326 | Piston Assembly (.020" Oversize) (Used After Code Date 04102100). | | 791324 | Ring Set (.020" Oversize) (Used After Code Date 04102100). |
| | | | | 499431 | Piston Assembly (.020" Oversize) (Used After Code Date 97011200 and Before Code Date 04102200). | | 499427 | Ring Set (.020" Oversize) (Used After Code Date 97011200 and Before Code Date 04102200). |
| | | | | 493386 | Piston Assembly (.020" Oversize) (Used Before Code Date 97011300). | | 493389 | Ring Set (.020" Oversize) (Used Before Code Date 97011300). |
| | | | | 499432 | Piston Assembly (.030" Oversize) (Used After Code Date 97011200). | | 499428 | Ring Set (.030" Oversize) (Used After Code Date 97011200). |
| 24 | 222698 | Key-Flywheel | | 493387 | Piston Assembly (.030" Oversize) (Used Before Code Date 97011300). | 27 | 691866 | Lock-Piston Pin (Used After Code Date 97011200). |
| | | | | | | | | ----- Note ----- 691588 Lock- Piston Pin (Used Before Code Date 97011300). |

★ Included in Engine Gasket Set-Ref. No.358.

● Included in Carburetor Overhaul Kit-Ref. No. 121.

◆ Included in Carburetor Gasket Set-Ref. No. 977.

⊗ Included in Valve Gasket Set-Ref. No 1095.

Illustrations cover a range of engines. Parts shown without corresponding text may not be used on your specific engine.

0990-10

Assemblies include all parts shown in frames.

09/27/2005

12H800

| REF. NO. | PART NO. | DESCRIPTION | REF. NO. | PART NO. | DESCRIPTION | REF. NO. | PART NO. | DESCRIPTION |
|----------|----------|--|----------|----------|---|----------|----------|---|
| 28 | 499423 | Pin-Piston (Standard) (Used After Code Date 97011200). ----- Note ----- 298909 Pin-Piston (Standard) (Used Before Code Date 97011300). 298908 Pin-Piston (.005" Oversize) (Used Before Code Date 97011300). | 45 | 690548 | Tappet-Valve | 55 | 691421 | Housing-Rewind Starter |
| | | | 46 | 691449 | Camshaft (Used After Code Date 96060200). ----- Note ----- 492830 Camshaft (Used Before Code Date 96060300). | 58 | 280399 | Rope-Starter (Cut To Required Length) |
| 29 | 499424 | Rod-Connecting (Standard) (Used After Code Date 97011200). ----- Note ----- 490566 Rod-Connecting (Standard) (Used Before Code Date 97011300). 490743 Rod-Connecting (.020" Undersize) (Used Before Code Date 97011300). | 46A | 691460 | Camshaft (Clockwise) (Used After Code Date 96060200). Used on Type No(s). 0823, 1923. ----- Note ----- 493740 Camshaft (Clockwise) (Used Before Code Date 96060300). Used on Type No(s). 0823. 691459 Camshaft (Counterclockwise) (Used After Code Date 96060200). Used on Type No(s). 0662, 1315, 1367, 1538, 1762, 1934, 1947, 1949, 1982, 1989, 2312, 2313, 2314, 2315, 2316, 2330, 2351, 2352, 2360, 2378, 2385, 2394, 3115, 3173, 3319. | 60 | 281434 | Grip-Starter Rope |
| | | | | | | 65 | 690837 | Screw (Rewind Starter) |
| 32 | 691664 | Screw (Connecting Rod) | | | | 78 | 691108 | Screw (Flywheel Guard) |
| 32A | 695759 | Screw (Connecting Rod) (Used After Code Date 00042200). | | | | 81 | 691740 | Lock-Muffler Screw |
| 33 | 262651 | Valve-Exhaust | | | | 83 | 691778 | Shaft-Auxiliary Drive Used on Type No(s). 0679, 0823, 1923, 1947, 1949, 1989. ----- Note ----- 690527 Shaft-Auxiliary Drive Used on Type No(s). 0662, 1315, 1538, 1762, 2312, 2313, 2314, 2315, 2316, 2351, 2352, 2360, 2378, 2385, 2394, 3115, 3173, 3319. 690521 Shaft-Auxiliary Drive Used on Type No(s). 1934, 1982, 2330. |
| 34 | 262652 | Valve-Intake | | | | 94 | 493765 | Kit-Idle Mixture |
| 35 | 691270 | Spring-Valve (Intake) | | | | 95 | 691636 | Screw (Throttle Valve) |
| 36 | 691270 | Spring-Valve (Exhaust) | | | | 97 | 493267 | Shaft-Throttle (Metal) ----- Note ----- 696565 Shaft-Throttle (Plastic) |
| 37 | 694086 | Guard-Flywheel | | | | 98 | 398185 | Kit-Idle Speed |
| 40 | 692194 | Retainer-Valve | | | | 98A | 493280 | Kit-Idle Speed |
| 43 | 691997 | Slinger-Governor/Oil ----- Note ----- 691486 Slinger-Governor/Oil Used on Type No(s). 1167, 1715, 1961, 2334, 2367, 2673, 3183. | 50 | 497465 | Manifold-Intake | 101 | 691623 | Pin-Shaft |
| | | | 51 | 272199 | Gasket-Intake | 104 | 691242 | Pin-Float Hinge |
| | | | 54 | 691650 | Screw (Intake Manifold) | 108 | 691182 | Valve-Choke |
| | | | | | | 108A | 790844 | Valve-Choke |
| | | | | | | 109 | 494218 | Shaft-Choke |
| | | | | | | 109A | 498593 | Shaft-Choke |
| | | | | | | 109B | 790843 | Shaft-Choke |

★ Included in Engine Gasket Set-Ref. No.358.

● Included in Carburetor Overhaul Kit-Ref. No. 121.

◆ Included in Carburetor Gasket Set-Ref. No. 977.

⊘ Included in Valve Gasket Set-Ref. No 1095.

Illustrations cover a range of engines. Parts shown without corresponding text may not be used on your specific engine.

12H800

| REF. NO. | PART NO. | DESCRIPTION | REF. NO. | PART NO. | DESCRIPTION | REF. NO. | PART NO. | DESCRIPTION |
|----------|----------|--|----------|----------|--|----------|----------|---|
| 117 | 494870 | Jet–Main (Standard) ----- Note ----- 497466 Jet–Main (Standard) Used on Type No(s). 1538. 498977 Jet–Main (Standard) Used on Type No(s). 0664,0665,0666,0667,0671,0672,1149,1167,1170,1368,1369,1370,1373,1374,1377,1548. | 121 | 498260 | Kit–Carburetor Overhaul | 134 | ●398188 | Kit–Needle/Seat |
| 117A | 498978 | Jet–Main (Standard) ----- Note ----- 498981 Jet–Main (Standard) Used on Type No(s). 0678,0679,1726,1746,1777,1801,1802,1803,1804,1805,1926,1942,1955,1986,2331,2349. | 125 | 498170 | Carburetor (Primer System) ----- Note ----- 498254 Carburetor (Primer System) Used on Type No(s). 1538. 790821 Carburetor (Primer System) Used on Type No(s). 0680, 1749, 1917. | 137 | ◆693981 | Gasket–Float Bowl |
| 117B | 697355 | Jet–Main (Standard) | 125A | 499059 | Carburetor (Choke System) Used on Type No(s). 1701,1714,1715,1726,1777,1786,1926,1932,1942,1955,1961,1986,2013,2324,2329,2331,2333,2334,2349,2367,2383,2391,2635,2673,2681,3178,3183. ----- Note ----- 498965 Carburetor (Choke System) Used on Type No(s). 0664,0665,0666,0667,0671,0672,1149,1167,1170,1368,1369,1370,1373,1374,1377,1548,1747. 790978 Carburetor (Choke System) Used on Type No(s). 0678,0679,1746,1801,1802,1803,1804,1805. 792253 Carburetor (Choke System) Used on Type No(s). 1726,1777,1926,1942,1955,1986,2331,2349. | 187A | 791873 | Line–Fuel (Molded) (Used After Code Date 05063000). ----- Note ----- 691050 Line–Fuel (Cut to Required Length) (Used Before Code Date 05070100). |
| 118 | 497315 | Jet–Main (High Altitude) ----- Note ----- 496495 Jet–Main (High Altitude) Used on Type No(s). 1538. 498978 Jet–Main (High Altitude) Used on Type No(s). 0664,0665,0666,0667,0671,0672,1149,1167,1170,1368,1369,1370,1373,1374,1377,1548. | 125B | 790845 | Carburetor (Autochoke System) | 187B | 791891 | Line–Fuel (Includes Filter) (Used After Code Date 05063000). ----- Note ----- 691371 Line–Fuel (Molded) (Used Before Code Date 05070100). |
| 118A | 498975 | Jet–Main (High Altitude) ----- Note ----- 494870 Jet–Main (High Altitude) Used on Type No(s). 0678,0679,1726,1746,1777,1801,1802,1803,1804,1805,1926,1942,1955,1986,2331,2349. | 127 | ●694468 | Plug–Welch | 187C | 791875 | Line–Fuel (Molded) (Used After Code Date 05063000). ----- Note ----- 692042 Line–Fuel (Includes Filter) (Used Before Code Date 05070100). |
| 118B | 692677 | Jet–Main (High Altitude) | 130 | 691203 | Valve–Throttle ----- Note ----- 696564 Valve–Throttle (Used With Plastic Throttle Shaft) | 188 | 690877 | Screw (Control Bracket) |
| | | | 133 | 398187 | Float–Carburetor | 190 | 690940 | Screw (Fuel Tank) |
| | | | | | | 202 | 691829 | Link–Mechanical Governor |

★ Included in Engine Gasket Set–Ref. No.358.

● Included in Carburetor Overhaul Kit–Ref. No. 121.

◆ Included in Carburetor Gasket Set–Ref. No. 977.

⊗ Included in Valve Gasket Set–Ref. No 1095.

Illustrations cover a range of engines. Parts shown without corresponding text may not be used on your specific engine.

0990–12

Assemblies include all parts shown in frames.

09/27/2005

| REF. NO. | PART NO. | DESCRIPTION | REF. NO. | PART NO. | DESCRIPTION | REF. NO. | PART NO. | DESCRIPTION |
|-------------|---------------|---|-------------|---------------|---|----------|----------|--|
| 209 | 691864 | Spring-Governor Used on Type No(s). 2329,2334,2349. ----- Note ----- 690242 Spring-Governor Used on Type No(s). 1932. 690241 Spring-Governor Used on Type No(s). 1961,3183. 790944 Spring-Governor Used on Type No(s). 1701. | 209B | 691851 | Spring-Governor ----- Note ----- 699056 Spring-Governor Used on Type No(s). 0652,0656,0661,0662, 0822,0824,0828,0837, 0838,0839,0877,1148, 1315,1316,1322,1324, 1325,1332,1378,1534, 1540,1544,1547,1569, 1570,1571,1721,1752, 1754,1755,1756,1761, 1762,1764,1770,1771, 1784,1789,1901,1922, 1928,1934,1937,1938, 1947,1949,1967,1977, 1978,1982,1983,1987, 1989,1990,2009,2312, 2314,2316,2319,2323, 2326,2328,2330,2348, 2351,2371,2372,2378, 2381,2384,2385,2386, 2387,2388,2389,2390, 2394,2395,2396,2632, 2634,2641,2642,2643, 2644,2645,2646,2647, 2648,2649,2670,2671, 2672,2675,2676,2680, 2682,2684,2685,2686, 3115,3116,3122,3124, 3127,3128,3129,3132, 3172,3173,3174,3180, 3306,3307,3308,3309, 3312,3318,3319,3509, 6699. 693187 Spring-Governor Used on Type No(s). 2383,2683. 691291 Spring-Governor Used on Type No(s). 1715,1777,1786,1942, 1955,1986,2320,2324, 2331,2349,2391,3178. | | | 691292 Spring-Governor Used on Type No(s). 0658,0840,0866,0868, 0873,0878,1150,1166, 1171,1320,1365,1366, 1367,1371,1372,1375, 1376,1520,1559,1717, 1718,1719,1723,1724, 1731,1732,1733,1734, 1736,1737,1738,1758, 1760,1763,1764,1765, 1766,1767,1768,1775, 1778,1785,1790,1791, 1792,1795,1808,1809, 1810,1816,1817,1905, 1906,1907,1910,1911, 1912,1913,1915,1916, 1917,1918,1925,1926, 1936,1940,1943,1959, 1962,1963,1964,1965, 1966,1968,1970,1974, 1976,1985,1991,1992, 1993,1995,1996,1999, 2001,2002,2003,2004, 2005,2008,2352,3125, 3130,3137,3165,3168, 3179,3170,3181,3185, 3186,3314,3315,3316, 3317,3320,3322,3323, 3324,3325. 691852 Spring-Governor Used on Type No(s). 0670,0680,1720,1727, 1728,1729,1739,1749, 1807,1811,1814,1914, 1958,1960,1994,2006, 2010,2379,2380,3169, 3189. 691290 Spring-Governor Used on Type No(s). 1714,1726,2013,2367, 2673,2635,2681. |
| 209A | 690567 | Spring-Governor Used on Type No(s). 1167. ----- Note ----- 690568 Spring-Governor Used on Type No(s). 1149,1548. 691835 Spring-Governor Used on Type No(s). 0664, 0665, 0666, 0667,1170,1368,1369, 1370,1373,1802. 262663 Spring-Governor Used on Type No(s). 0671,0672. 690569 Spring-Governor Used on Type No(s). 1374,1377,1747. 791157 Spring-Governor Used on Type No(s). 1746,1801,1803,1804, 1805. 791315 Spring-Governor Used on Type No(s). 0678, 0679. | | | | | | |

★ Included in Engine Gasket Set-Ref. No.358.

● Included in Carburetor Overhaul Kit-Ref. No. 121.

◆ Included in Carburetor Gasket Set-Ref. No. 977.

⊘ Included in Valve Gasket Set-Ref. No 1095.

Illustrations cover a range of engines. Parts shown without corresponding text may not be used on your specific engine.

12H800

| REF. NO. | PART NO. | DESCRIPTION | REF. NO. | PART NO. | DESCRIPTION | REF. NO. | PART NO. | DESCRIPTION |
|----------|----------|---|----------|----------|---|----------|----------|---|
| 217 | 690354 | Spring-Choke Return | 227 | 690783 | Lever-Governor Control | 304 | 493293 | Housing-Blower |
| 222 | 790143 | Bracket-Control (Remote/Manual Friction)(Primer) | 231 | 691636 | Screw (Choke Valve) | | | ----- Note ----- |
| 222A | 692021 | Bracket-Control (Remote, Choke A Matic, Non Compliance) | 236 | 691826 | Link-Lockout | | | 493294 Housing-Blower |
| | | ----- Note ----- | 240 | 298090 | Filter-Fuel | | | Used on Type No(s). 0666,0667,0868,0878, 1149,1150,1167,1171, 1369,1548,1559,1569, 1701,1705,1714,1715, 1726,1729,1755,1766, 1777,1786,1802,1919, 1926,1932,1941,1942, 1948,1955,1961,1967, 1988,2005,2009,2013, 2320,2324,2329,2331, 2333,2334,2349,2350, 2367,2383,2391,2635, 2669,2673,2681,3110, 3120,3123,3133,3138, 3140,3167,3176,3178, 3179,3183,3184,3324. |
| | | 690839 Bracket-Control (Manual Friction) (Choke A Matic) Used on Type No(s). 1149, 1167, 1548. | 259 | 691223 | Bracket-Casing Clamp (Control Wire Casing) | | | 695892 Housing-Blower |
| | | 790982 Bracket-Control Used on Type No(s). 0678, 0679, 1746, 1801, 1803, 1804, 1805. | 265 | 690798 | Clamp-Casing | | | Used on Type No(s). 1721,1724,1746,1747, 1784,1790,1901,1906, 1907,1910,1911,1912, 1913,1915,1989,2320, 2360,2370,2384,2385, 2386,2389,2390,2394, 2395,2641,2643,2646, 2649,2684,2685,2686, 3129,3180,3182,3308, 3309,3318,3319,3509. |
| 222B | 693006 | Bracket-Control (Fixed Speed Auto Primer Control) | 265A | 691024 | Clamp-Casing | | | 696298 Housing-Blower |
| 222C | 692150 | Bracket-Control (Variable Speed) (5 Position Manual Choke) | 265B | 692179 | Clamp-Casing | | | Used on Type No(s). 1375,1376,1717,1718, 1719,1730,1731,1732, 1735,1754,1792,1809, 1811,1959,1960,1996, 2001,2326,3181,3187, 3188. |
| 222D | 692467 | Bracket-Control (Fixed Speed) | 267 | 691044 | Screw (Casing Clamp) | | | 790983 Housing-Blower |
| | | ----- Note ----- | 268 | 691072 | Casing-Control Wire (Cut to Required Length) | | | Used on Type No(s). 1738,1739,1808,1816, 1817, 1963,1964,1965. |
| | | 791128 Bracket-Control Used on Type No(s). 1738, 1739, 1808, 1809, 1811. | 269 | 691026 | Wire-Control (Cut to Required Length) | | | 791291 Housing-Blower |
| 222E | 692982 | Bracket-Control (Manual Friction, 5 Position Manual Choke) | 270 | 691027 | Nut (Control Wire Casing) | | | Used on Type No(s). 1807, 1817. |
| | | | 271 | 691028 | Lever-Control | | | 790826 Housing-Blower |
| | | | 276 ♦ | 271716 | Washer-Sealing (Main Jet) | | | Used on Type No(s). 1965. |
| | | | 287 | 690940 | Screw (Dipstick Tube) | | | |
| | | | 291 | 790830 | Thermostat | | | |
| | | | 300 | 692038 | Muffler (Super Lo Tone) | | | |
| | | | | | ----- Note ----- | | | |
| | | | | | 790828 Muffler Used on Type No(s). 1738, 1739, 1807, 1808, 1816, 1817, 1963, 1964, 1965. | | | |
| | | | 300A | 494343 | Muffler (Square Lo Tone) | | | |
| | | | 300B | 497681 | Muffler (Catalyst) | | | |

★ Included in Engine Gasket Set-Ref. No.358.

● Included in Carburetor Overhaul Kit-Ref. No. 121.

♦ Included in Carburetor Gasket Set-Ref. No. 977.

⊘ Included in Valve Gasket Set-Ref. No 1095.

Illustrations cover a range of engines. Parts shown without corresponding text may not be used on your specific engine.

| REF. NO. | PART NO. | DESCRIPTION | REF. NO. | PART NO. | DESCRIPTION | REF. NO. | PART NO. | DESCRIPTION |
|----------|----------|---|----------|----------|--|-------------|----------------------------------|--|
| 305 | 691108 | Screw (Blower Housing) | 443A | 692523 | Screw (Air Cleaner Primer Base) | 597 | 691696 | Screw (Pawl Friction Plate) |
| 306 | 690450 | Shield-Cylinder | 445A | 491588 | Filter-Air Cleaner Cartridge | 601 | 95162 | Clamp-Hose |
| 306A | 790836 | Shield-Cylinder | 455 | 695161 | Cup-Flywheel | 601A | 691038 | Clamp-Hose |
| 307 | 690345 | Screw (Cylinder Shield) | 456 | 692299 | Plate-Pawl Friction | 604 | 691757 | Cover-Control |
| 309 | 695550 | Motor-Starter | 459 | 281505 | Plate-Ratchet | 604A | 691344 | Cover-Control |
| 310 | 692327 | Bolt (Starter Motor) | 474 | 691991 | Alternator | 604B | 790703 | Cover-Control |
| 332 | 690662 | Nut (Flywheel) | 497 | 690664 | Screw (Stop Switch Bracket) | 608 | 497680 | Starter-Rewind |
| 333 | 802574 | Armature-Magneto ----- Note ----- 790817 Armature-Magneto Used on Type No(s). 0680, 1738, 1739, 1749, 1807, 1808, 1816, 1817, 1917, 1963, 1964, 1965. | 500 | 691086 | Washer (Key Switch) | 613 | 691340 | Screw (Muffler) ----- Note ----- 790833 Screw (Muffler) Used on Type No(s). 1738, 1739, 1807, 1808, 1816, 1817, 1963, 1964, 1965. |
| 334 | 691061 | Screw (Magneto Armature) | 505 | 691251 | Nut (Governor Control Lever) | 613A | 691653 | Screw (Muffler) |
| 337 | 802592 | Plug-Spark (Resistor) ----- Note ----- 697451 Plug-Spark (EMS) | 507 | 691972 | Insulator | 613B | 691114 | Screw (Muffler) |
| 346 | 690661 | Screw (Spark Arrestor) | 510 | 494147 | Drive-Starter | 615 | 690340 | Retainer-Governor Shaft |
| 347 | 691396 | Switch-Rocker | 513 | 692358 | Clutch-Drive | 616 | 698801 | Crank-Governor |
| 356 | 692390 | Wire-Stop | 520 | 691084 | Terminal-Ground | 617★◆270344 | Seal-O Ring (Intake Manifold) | |
| 356A | 690650 | Wire-Stop | 523 | 495264 | Dipstick ----- Note ----- 499621 Dipstick Used on Type No(s). 1720. | 621 | 692310 | Switch-Stop |
| 356B | 693010 | Wire-Stop | 524 | ★692296 | Seal-Dipstick Tube | 627 | 692872 | Bracket-Stop Switch |
| 356D | 496381 | Wire-Stop | 525 | 495265 | Tube-Dipstick | 633 | ◆◆691321 | Seal-Choke/Throttle Shaft |
| 356F | 494250 | Wire-Stop | 529 | 691923 | Grommet | 633A | ◆◆693867 | Seal-Choke/Throttle Shaft |
| 358 | 497316 | Gasket Set-Engine | 544 | 690786 | Armature-Starter | 635 | 66538 | Boot-Spark Plug |
| 359 | 691077 | Washer (Ground Terminal) | 545 | 492919 | Washer Set (Starter Motor) | 651 | 691660 | Screw (Starter Gear Cover) |
| 363 | 19069 | Flywheel Puller | 562 | 92613 | Bolt (Governor Control Lever) | 664 | 691087 | Nut (Key Switch) |
| 365 | 691688 | Screw (Carburetor) | 564 | 690664 | Screw (Control Cover) ----- Note ----- 691132 Screw (Control Cover) | 668 | ★493823 | Spacer (Includes 2) |
| 373 | 691612 | Nut (Ground Terminal) | 564A | 691142 | Screw (Control Cover) | 670 | 692294 | Spacer-Fuel Tank |
| 374 | 691074 | Washer (Camshaft) | 564B | 698589 | Screw (Control Cover) | 676 | 396548 | Deflector-Muffler (Louvered) |
| 383 | 89838 | Wrench-Spark Plug | 584 | 697734 | Cover-Breather Passage | 676A | 393756 | Deflector-Muffler (Side Out) |
| 404 | 690272 | Washer (Governor Crank) | 585 | ★691879 | Gasket-Breather Passage | 676B | 397931 | Deflector-Muffler (Direct Out) |
| 425A | 690670 | Screw (Air Cleaner Cover) | 592 | 690800 | Nut (Rewind Starter) | 676C | 493871 | Deflector-Muffler (Side Out) (Extended) |

★ Included in Engine Gasket Set-Ref. No.358.

● Included in Carburetor Overhaul Kit-Ref. No. 121.

◆ Included in Carburetor Gasket Set-Ref. No. 977.

⊘ Included in Valve Gasket Set-Ref. No 1095.

Illustrations cover a range of engines. Parts shown without corresponding text may not be used on your specific engine.

12H800

| REF. NO. | PART NO. | DESCRIPTION | REF. NO. | PART NO. | DESCRIPTION | REF. NO. | PART NO. | DESCRIPTION |
|----------|----------|---|----------|----------|---|----------|----------|--|
| 677 | 690661 | Screw (Muffler Deflector) | 802 | 695267 | Cap-End (Used After Code Date 00040600). ----- Note ----- 695975 Cap-End (Used Before Code Date 00040700). | 883 | 691881 | Gasket-Exhaust |
| 684 | 690345 | Screw (Breather Passage Cover) | 803 | 695266 | Housing-Starter (Used After Code Date 00040600). ----- Note ----- 695975 Housing-Starter (Used Before Code Date 00040700). | 892 | 690646 | Switch-Key |
| 689 | 691855 | Spring-Friction | | | | 910 | 691094 | Stud (Alternator) |
| 692 | 690572 | Spring-Detent | | | | 921 | 497233 | Cover-Blower Housing ----- Note ----- 692933 Cover-Blower Housing Used on Type No(s). 1520, 1530, 1531, 1567, 2611, 2612, 2630, 2631, 2667, 2678. |
| 697 | 691127 | Screw (Drive Cap) | | | | 921A | 695886 | Cover-Blower Housing |
| 715 | 691147 | Screw (Shaft Stop) | | | | 921B | 692931 | Cover-Blower Housing Used on Type No(s). 2320, 2331, 2626, 2391, 2396. ----- Note ----- 692932 Cover-Blower Housing Used on Type No(s). 2333, 2334. |
| 718 | 690959 | Pin-Locating | 832 | 499034 | Guard-Muffler | 921C | 695889 | Cover-Blower Housing Used on Type No(s). 1996, 2324, 2384, 2385, 2386, 2387, 2388, 2389, 2390, 2394, 2395. |
| 721 | 690449 | Stop-Shaft | 832A | 691424 | Guard-Muffler | 921E | 696262 | Cover-Blower Housing |
| 741 | 790345 | Gear-Timing (Use Without Woodruff Key) ----- Note ----- 691830 Gear-Timing (Uses Woodruff Key) | 832B | 497683 | Guard-Muffler | 921F | 697343 | Cover-Blower Housing |
| | | | 836 | 690664 | Screw (Muffler Guard) | 921G | 790701 | Cover-Blower Housing |
| 742 | 93941 | Retainer-E Ring | 836A | 690661 | Screw (Muffler Guard) | 921H | 790037 | Cover-Blower Housing |
| 743 | 691772 | Gear-Drive (Counterclockwise) ----- Note ----- 690516 Gear-Drive (Clockwise) Used on Type No(s). 0823. | 836B | 691147 | Screw (Muffler Guard) | 921J | 790036 | Cover-Blower Housing |
| | | | 842 | 691031 | Seal-O Ring (Dipstick Tube) | 921K | 699984 | Cover-Blower Housing |
| 745 | 691648 | Screw (Brake) | 843 | 691884 | Sleeve-Lever (Speed Control) | 922 | 691831 | Spring-Brake |
| 783 | 691918 | Gear-Pinion (19 Teeth) (Starter Drive) | 843A | 691895 | Sleeve-Lever (Choke) | 922A | 692135 | Spring-Brake |
| 783A | 691269 | Gear-Pinion (12 Teeth) | 847 | 692017 | Dipstick/Tube Assembly ----- Note ----- 692047 Dipstick/Tube Assembly Used on Type No(s). 1720. | 923 | 691994 | Brake |
| 784 | 692341 | Cover-Starter Gear | | | | 923A | 695891 | Brake |
| 785 | 692352 | Gasket-Starter Cover | 851 | 493880 | Terminal-Spark Plug | 925 | 690595 | Cover-Linkage |
| 789A | 691372 | Harness-Wiring (Used Before Code Date 00040700). | 853 | 695268 | Adapter-Wire | 930 | 691919 | Guard-Rewind (Round) |
| 789B | 696547 | Harness-Wiring ----- Note ----- 696546 Harness-Wiring Used on Type No(s). 2333, 3138, 3179. | 869 | 691155 | Seat-Valve (Intake) | 930A | 691345 | Guard-Rewind (Teardrop) |
| | | | 870 | 690380 | Seat-Valve (Exhaust) | 935 | 499421 | Switch-Interlock |
| 801 | 690782 | Cap-Drive | 871 | 262001 | Bushing-Valve Guide (Exhaust) ----- Note ----- 63709 Bushing-Valve Guide (Intake) | 937 | 691325 | Spline-Starter |
| | | | | | | 940 | 690664 | Screw (Casing Clamp Bracket) |

★ Included in Engine Gasket Set-Ref. No.358.

● Included in Carburetor Overhaul Kit-Ref. No. 121.

◆ Included in Carburetor Gasket Set-Ref. No. 977.

⊘ Included in Valve Gasket Set-Ref. No 1095.

Illustrations cover a range of engines. Parts shown without corresponding text may not be used on your specific engine.

| REF. NO. | PART NO. | DESCRIPTION | REF. NO. | PART NO. | DESCRIPTION | REF. NO. | PART NO. | DESCRIPTION |
|-------------|---------------|--|-------------|---------------|---|-------------|---------------|---|
| 957 | 397974 | Cap-Fuel Tank (Plastic) ----- Note ----- 692662 Cap-Fuel Tank (Plastic) Used on Type No(s). 2384, 3312, 3318, 3319. | 972 | 699392 | Tank-Fuel (Plastic) | 1095 | 498528 | Gasket Set-Valve |
| 957A | 692046 | Cap-Fuel Tank (Plastic) | 972B | 699374 | Tank-Fuel (Plastic) ----- Note ----- 699387 Tank-Fuel (Plastic) Used on Type No(s). 1375, 1376, 1717, 1718, 1719, 1730, 1731, 1732, 1735, 1754, 1792, 1795, 1959, 1960, 1996, 2001, 2002, 2326, 3181, 3187, 3188. | 1102 | 691266 | Pilot-Guide Used on Type No(s). 1167, 1715, 2367, 2673. ----- Note ----- 691255 Pilot-Guide Used on Type No(s). 1955, 1961, 2681, 3183. |
| 957B | 699985 | Cap-Fuel Tank (Plastic) | 975 | 493640 | Bowl-Float | 1119 | 691648 | Screw (Alternator) |
| 958 | 698183 | Valve-Fuel Shut Off (Plastic) | 976 | 694395 | Primer-Carburetor | 1160 | 691627 | Screw (Interlock Switch) |
| 966A | 496116 | Base-Air Cleaner Primer ----- Note ----- 792040 Base-Air Cleaner Used on Type No(s). 1738, 1739, 1807, 1808, 1963, 1964, 1965. | 977 | 498261 | Gasket Set-Carburetor | 1210 | 498144 | Pulley/Spring Assembly (Pulley) |
| 967A | 493537 | Filter-Pre Cleaner | 986 | 693514 | Filter-Debris Foam | 1211 | 498144 | Pulley/Spring Assembly (Spring) |
| 968B | 692298 | Cover-Air Cleaner | 990 | 691959 | Key Set | 1236 | 695959 | Starter-Mechanical (Touch N Mow) (Do Not Service Individual Parts, Only As A Whole) |
| 969 | 690700 | Screw (Blower Housing Cover) | 990A | 695951 | Key Set (Touch N Mow) | | | ----- Note ----- 699914 Starter-Me- chanical (Touch N Mow) (Do Not Service Individual Parts, Only As A Whole) Used on Type No(s). 2001. |
| 969A | 691138 | Screw (Blower Housing Cover) | 994 | 398067 | Arrestor-Spark | 1330 | 270962 | Manual-Repair |
| 970 | 691669 | Screw (Air Cleaner Primer Bracket) | 1005 | 691346 | Fan-Flywheel | 1386 | 790848 | Vane-Air (Autochoke System) |
| | | | 1009 | 696255 | Screw (Starter Motor) | 1387 | 790849 | Spring-Air Vane |
| | | | 1019 | 494256 | Kit-Label ----- Note ----- 790231 Kit-Label (Touch N Mow) | 1388 | 790850 | Screw (Air Vane) (Autochoke System) |
| | | | 1036 | | Label-Emission (Available From An Authorized Briggs & Statton Sevice Dealer) | | | |
| | | | 1058 | 276171 | Owner's Manual ----- Note ----- 274940 Owner's Manual (Touch N Mow) | | | |
| | | | 1059 | 692311 | Kit-Screw/Washer ----- Note ----- 696293 Kit-Screw/ Washer (Touch N Mow) | | | |

★ Included in Engine Gasket Set-Ref. No.358.

● Included in Carburetor Overhaul Kit-Ref. No. 121.

◆ Included in Carburetor Gasket Set-Ref. No. 977.

⊘ Included in Valve Gasket Set-Ref. No 1095.

Illustrations cover a range of engines. Parts shown without corresponding text may not be used on your specific engine.